

1969 Bushmaster PARTS DIAGRAM

HANDLEBAR (G3SS-D) ('74-'75)

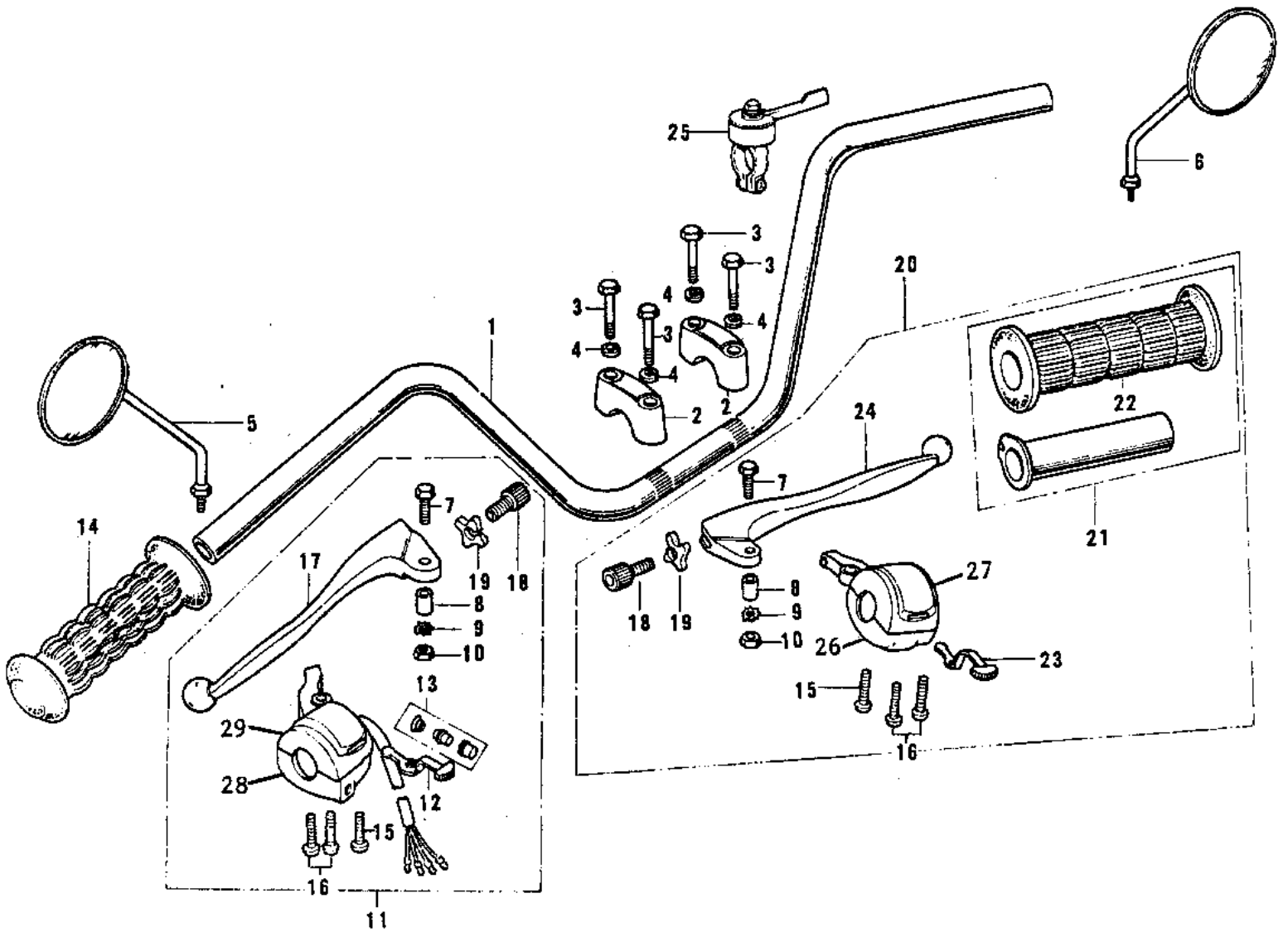

1969 Bushmaster PARTS LIST

HANDLEBAR (G3SS-D) ('74-'75)

| ITEM NAME | PART NUMBER | QUANTITY |
|----------------------------------|-------------|----------|
| HANDLEBAR (Ref # 1) | 46003-033 | 1 |
| HOLDER UPPER HANDLEBAR (Ref # 2) | 46012-004 | 2 |
| BOLT 8X38 (Ref # 3) | 92001-1405 | 4 |
| WASHER SPRING 8MM (Ref # 4) | 461F0800 | 4 |
| REAR VIEW MIRROR LH (Ref # 5) | 56003-016 | 1 |
| REAR VIEW MIRROR R.H. (Ref # 6) | 56002-024 | 1 |
| BOLT HEX HEAD 5X20 (Ref # 7) | 92007-020 | 2 |
| COLLAR LEVER (Ref # 8) | 46059-011 | 2 |
| WASHER LOCK 5MM (Ref # 9) | 464H0500 | 2 |
| NUT 5MM (Ref # 10) | 312B0500 | 2 |
| GRIP ASSY,L.H (Ref # 11) | 46074-093 | 1 |
| KNOB ASSY L.H SWITCH (Ref # 12) | 46088-001 | 1 |
| SWITCH ASSY LH BUTTON (Ref # 13) | 46078-003 | 1 |
| RUBBER,L.H GRIP (Ref # 14) | 46075-020 | 1 |
| SCREW PAN HEAD 5X18 (Ref # 15) | 220B0518 | 2 |
| SCREW PAN HEAD 5X20 (Ref # 16) | 220B0520 | 4 |
| LEVER-CLUTCH (Ref # 17) | 46092-015 | 1 |
| SCREW,CABLE ADJUST (Ref # 18) | 46055-010 | 2 |
| NUT LOCK ADJUST SCREW (Ref # 19) | 46056-001 | 2 |
| GRIP ASSY,R.H (Ref # 20) | 46017-078 | 1 |
| GRIP ASSY,THROTTLE (Ref # 21) | 46019-024 | 1 |
| RUBBER,R.H.GRIP (Ref # 22) | 46061-015 | 1 |
| KNOB ASSY R.H SWITCH (Ref # 23) | 46043-002 | 1 |
| LEVER FRONT BRAKE (Ref # 24) | 46058-004 | 1 |
| LEVER ASSY,STARTER (Ref # 25) | 46109-013 | 1 |
| CASE,R.H LOWER (Ref # 26) | 46022-017 | 1 |
| CASE,R.H. UPPER (Ref # 27) | 46040-015 | 1 |
| CASE, L.H. LOWER (Ref # 28) | 46077-026 | 1 |
| CASE,L.H UPPER (Ref # 29) | 46086-025 | 1 |