

# 1970 Bushmaster PARTS DIAGRAM

HANDLEBAR (G3SS-D) ('74-'75)

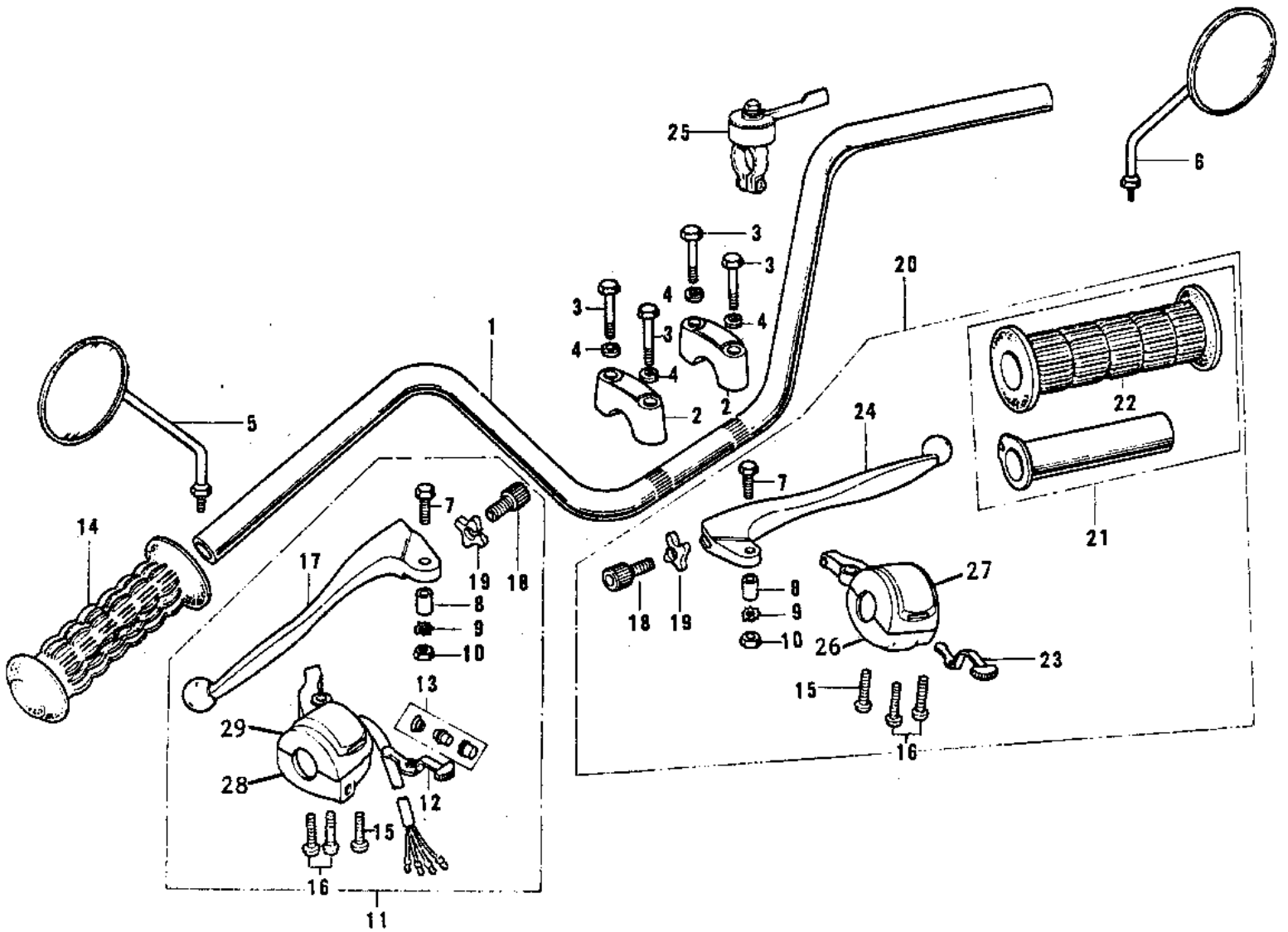

# 1970 Bushmaster PARTS LIST

HANDLEBAR (G3SS-D) ('74-'75)

ITEM NAME	PART NUMBER	QUANTITY
HANDLEBAR (Ref # 1)	46003-033	1
HOLDER UPPER HANDLEBAR (Ref # 2)	46012-004	2
BOLT 8X38 (Ref # 3)	92001-1405	4
WASHER SPRING 8MM (Ref # 4)	461F0800	4
REAR VIEW MIRROR LH (Ref # 5)	56003-016	1
REAR VIEW MIRROR R.H. (Ref # 6)	56002-024	1
BOLT HEX HEAD 5X20 (Ref # 7)	92007-020	2
COLLAR LEVER (Ref # 8)	46059-011	2
WASHER LOCK 5MM (Ref # 9)	464H0500	2
NUT 5MM (Ref # 10)	312B0500	2
GRIP ASSY,L.H (Ref # 11)	46074-093	1
KNOB ASSY L.H SWITCH (Ref # 12)	46088-001	1
SWITCH ASSY LH BUTTON (Ref # 13)	46078-003	1
RUBBER,L.H GRIP (Ref # 14)	46075-020	1
SCREW PAN HEAD 5X18 (Ref # 15)	220B0518	2
SCREW PAN HEAD 5X20 (Ref # 16)	220B0520	4
LEVER-CLUTCH (Ref # 17)	46092-015	1
SCREW,CABLE ADJUST (Ref # 18)	46055-010	2
NUT LOCK ADJUST SCREW (Ref # 19)	46056-001	2
GRIP ASSY,R.H (Ref # 20)	46017-078	1
GRIP ASSY,THROTTLE (Ref # 21)	46019-024	1
RUBBER,R.H.GRIP (Ref # 22)	46061-015	1
KNOB ASSY R.H SWITCH (Ref # 23)	46043-002	1
LEVER FRONT BRAKE (Ref # 24)	46058-004	1
LEVER ASSY,STARTER (Ref # 25)	46109-013	1
CASE,R.H LOWER (Ref # 26)	46022-017	1
CASE,R.H. UPPER (Ref # 27)	46040-015	1
CASE, L.H. LOWER (Ref # 28)	46077-026	1
CASE,L.H UPPER (Ref # 29)	46086-025	1