

1970 Bushmaster PARTS DIAGRAM

SEAT/CHAIN COVER/CHAIN ('74-'75)

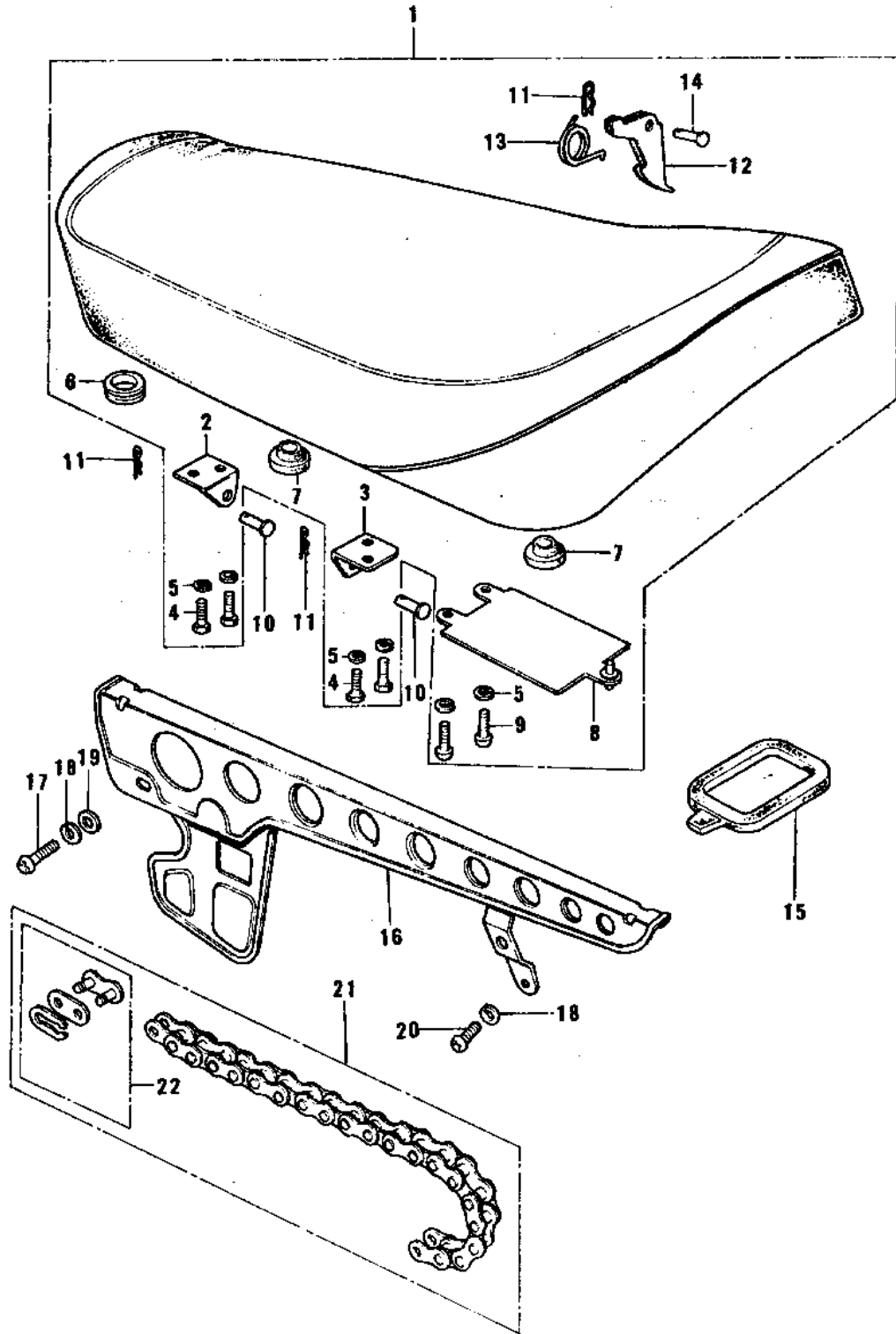

1970 Bushmaster PARTS LIST

SEAT/CHAIN COVER/CHAIN ('74-'75)

| ITEM NAME | PART NUMBER | QUANTITY |
|-----------------------------------|-------------|----------|
| SEAT-ASSY,DUAL (Ref # 1) | 53001-099 | 1 |
| HINGE,FRONT (Ref # 2) | 53009-024 | 1 |
| HINGE,REAR (Ref # 3) | 53009-023 | 1 |
| BOLT-UPSET 6X14 (Ref # 4) | 112B0614 | 4 |
| BOLT-UPSET 6X14 (Ref # 4) | 112B0614 | AL |
| WASHER SPRING 6MM (Ref # 5) | 461F0600 | 6 |
| GROMMET (Ref # 6) | 92071-056 | 1 |
| DAMPER RUBB DUAL SEAT (Ref # 7) | 92075-023 | 4 |
| CASE (Ref # 8) | 32099-011 | 1 |
| SCREW PAN HEAD 4X8 (Ref # 9) | 220B0408 | 2 |
| PIN-BRAKE CABLE FIT (Ref # 10) | 92043-092 | 2 |
| COTTER PIN (Ref # 11) | 92041-003 | 3 |
| HOOK-SEAT (Ref # 12) | 53008-017 | 1 |
| SPRING,HOOK (Ref # 13) | 53012-011 | 1 |
| PIN,DUAL SEAT PIVOT (Ref # 14) | 92043-106 | 1 |
| BAND-CHAIN OILER TANK (Ref # 15) | 92072-039 | 1 |
| CASE-CHAIN (Ref # 16) | 36014-052 | 1 |
| SCREW PAN HEAD 5X8 (Ref # 17) | 220B0508 | 1 |
| WASHER SPRING 5MM (Ref # 18) | 461F0500 | 2 |
| WASHER PLAIN 5MM (Ref # 19) | 410B0500 | 1 |
| SCREW PAN HEAD 5X12 (Ref # 20) | 220B0512 | 1 |
| *** N.L.A.*** (Canada) (Ref # 21) | 695W43104 | 1 |
| JOINT-CHAIN (Ref # 22) | 92058-1014 | 1 |