

1970 Trail Boss PARTS DIAGRAM

SEAT/CARRIER ('74-'75)

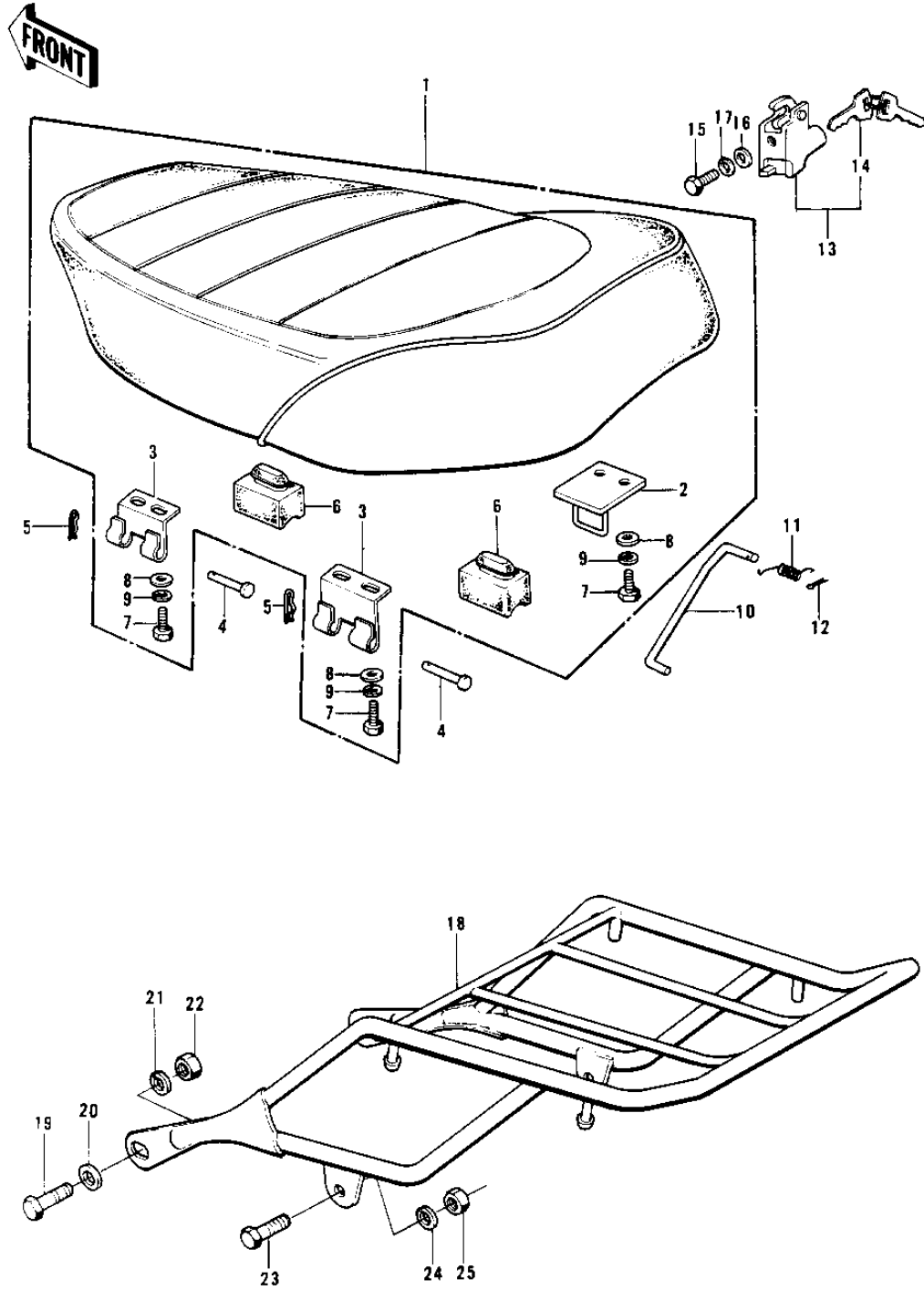

1970 Trail Boss PARTS LIST

SEAT/CARRIER ('74-'75)

| ITEM NAME | PART NUMBER | QUANTITY |
|--------------------------------|--------------|----------|
| SEAT ASSY,DUAL (Ref # 1) | 53002-052 | 1 |
| SEAT ASSY,DUAL (Ref # 1) | 53002-1017 | 1 |
| SEAT ASSY,DUAL (Ref # 1) | 53002-1017 | 1 |
| HOOK,SEAT (Ref # 2) | 53008-020 | 1 |
| HINGE B (Ref # 3) | 53009-018 | 2 |
| PIN (Ref # 4) | 53011-002 | 2 |
| COTTER PIN (Ref # 5) | 92041-003 | 2 |
| DAMPER RUBBER,SEAT (Ref # 6) | 92075-216 | 4 |
| BOLT-UPSET 6X14 (Ref # 7) | 112B0614 | 6 |
| WASHER PLAIN 6MM (Ref # 8) | 411B0600 | 6 |
| WASHER SPRING 6MM (Ref # 9) | 461F0600 | 6 |
| STAND,SEAT (Ref # 10) | 53054-003 | 1 |
| SPRING,SEAT HOOK (Ref # 11) | 53055-001 | 1 |
| PIN COTTER 2.0X15 (Ref # 12) | 550D2015 | 1 |
| LOCK ASSY,SEAT (Ref # 13) | 53045-014 | 1 |
| KEY SET,#401 (Ref # 14) | 27008-063-01 | 1 |
| KEY SET,#410 (Ref # 14) | 27008-063-10 | 1 |
| BOLT-UPSET,6X12 (Ref # 15) | 112G0612 | 1 |
| WASHER PLAIN 6MM (Ref # 16) | 411B0600 | 1 |
| WASHER SPRING 6MM (Ref # 17) | 461F0600 | 1 |
| CARRIER,LUGGAGE (Ref # 18) | 53029-050 | 1 |
| BOLT HEX HEAD 10X35 (Ref # 19) | 113N1035 | 2 |
| WASHER PLAIN 10MM (Ref # 20) | 411B1000 | 2 |
| WASHER SPRING 10MM (Ref # 21) | 461F1000 | 2 |
| NUT 10MM (Ref # 22) | 315B1000 | 2 |
| BOLT-SMALL,8X32 (Ref # 23) | 114N0832 | 2 |
| WASHER SPRING 8MM (Ref # 24) | 461F0800 | 2 |
| NUT,8MM (Ref # 25) | 311B0800 | 2 |