

1973 G5-A PARTS DIAGRAM

TAILLIGHT (G5-A)

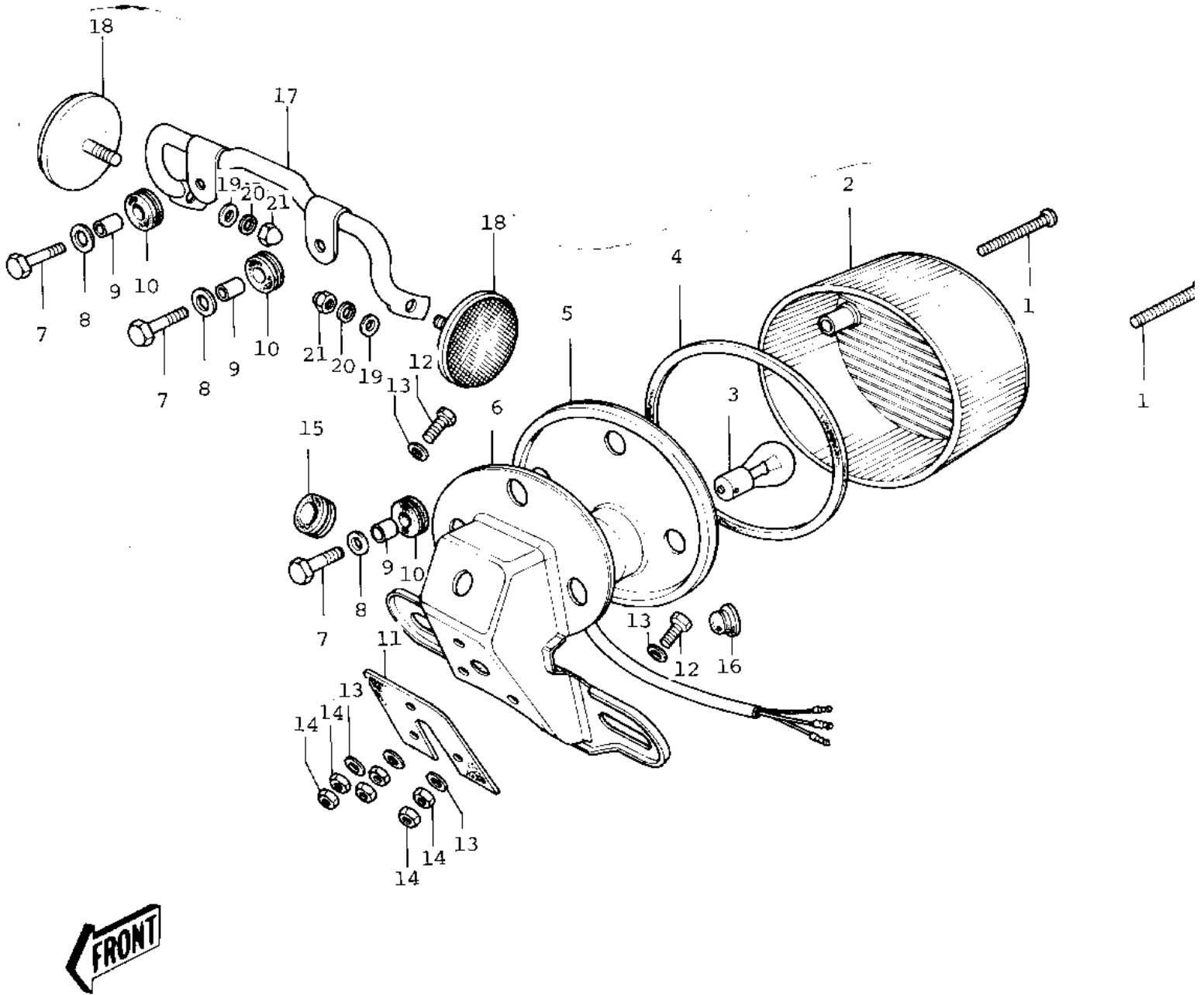

1973 G5-A PARTS LIST

TAILLIGHT (G5-A)

| ITEM NAME | PART NUMBER | QUANTITY |
|-----------------------------------|--------------|----------|
| LAMP ASSY,TAIL,BLACK (Ref # 1~10) | 23024-069-21 | |
| SCREW-PAN HEAD,4X35 (Ref # 1) | 220E0435A | |
| LENS-TAIL LAMP (Ref # 2) | 23026-023 | |
| BULB,6V 17/5.3W (Ref # 3) | 92069-028 | |
| GASKET-TAIL LAMP LENS (Ref # 4) | 23028-018 | |
| CASE,TAIL LAMP (Ref # 5) | 23027-030 | |
| BKT-LICENSE PLT.BLACK (Ref # 6) | 23036-019-21 | |
| BOLT-UPSET,6X20 (Ref # 7) | 112G0620 | |
| BOLT-UPSET,6X20 (Ref # 7) | 112G0620 | |
| WASHER 6.5X20X1.6T (Ref # 8) | 92022-125 | |
| COLLAR,6.8X10X8.5 (Ref # 9) | 92027-129 | |
| DAMPER RUBBER (Ref # 10) | 92075-076 | |
| DAMPER-TAIL LAMP SHCK (Ref # 11) | 35039-005 | |
| BOLT-UPSET (Ref # 12) | 112G0630 | |
| BOLT-UPSET (Ref # 12) | 112G0630 | |
| WASHER 6.5X20X1.6T (Ref # 13) | 92022-125 | |
| NUT 6MM (Ref # 14) | 312B0600 | |
| GROMMET HARNESS 10MM (Ref # 15) | 92071-019 | |
| PLUG REAR FENDER RUBB (Ref # 16) | 92074-006 | |
| BRACKET-REFLECTOR (Ref # 17) | 28013-005 | |
| REFLECTOR,REFLEX,REAR (Ref # 18) | 28012-009 | |
| WASHER PLAIN 5MM (Ref # 19) | 411B0500 | |
| WASHER SPRING 5MM (Ref # 20) | 461F0500 | |
| NUT-CAP,5MM (Ref # 21) | 322N0500 | |