

1972 G5 PARTS DIAGRAM

TAILLIGHT/TURN SIGNALS ('74-'75 B/C)

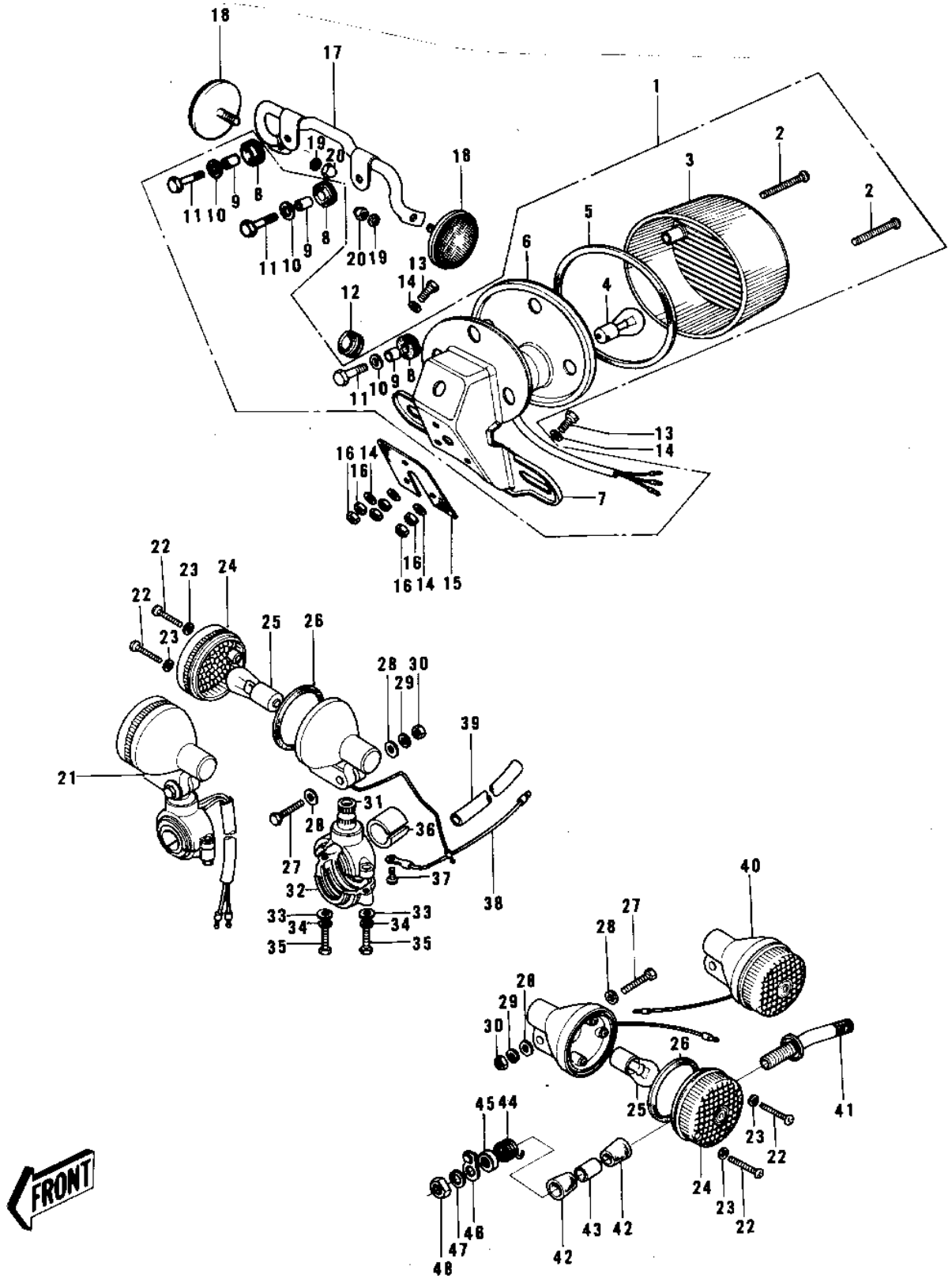

1972 G5 PARTS LIST

TAILLIGHT/TURN SIGNALS ('74-'75 B/C)

ITEM NAME	PART NUMBER	QUANTITY
LAMP ASSY, TAIL, BLACK (Ref # 1)	23024-069-21	1
SCREW-PAN HEAD, 4X35 (Ref # 2)	220E0435A	2
LENS-TAIL LAMP (Ref # 3)	23026-023	1
BULB, 6V 17/5.3W (Ref # 4)	92069-028	1
GASKET-TAIL LAMP LENS (Ref # 5)	23028-018	1
CASE, TAIL LAMP (Ref # 6)	23027-030	1
BKT-LICENSE PLT. BLACK (Ref # 7)	23036-019-21	1
DAMPER RUBBER (Ref # 8)	92075-076	3
COLLAR, 6.8X10X8.5 (Ref # 9)	92027-129	3
WASHER 6.5X20X1.6T (Ref # 10)	92022-125	3
BOLT 6X22 (Ref # 11)	112B0622	3
GROMMET HARNESS 10MM (Ref # 12)	92071-019	1
BOLT-UPSET (Ref # 13)	112G0630	3
WASHER 6.5X20X1.6T (Ref # 14)	92022-125	6
DAMPER-TAIL LAMP SHCK (Ref # 15)	35039-005	1
NUT 6MM (Ref # 16)	312B0600	6
BRACKET-REFLECTOR (Ref # 17)	28013-005	1
REFLECTOR-REFLEX, REAR (Ref # 18)	28012-008	2
WASHER SPRING 5MM (Ref # 19)	461F0500	2
NUT-CAP, 5MM (Ref # 20)	322N0500	2
LAMP ASY-FR TURN SIG (Ref # 21)	23037-005	2
SCREW-PAN HEAD, 4X20 (Ref # 22)	220E0420A	8
WASHER-PLAIN, 4MM (Ref # 23)	23058-002	8
LENS, TURN SIGNAL LAMP (Ref # 24)	23048-1001	4
BULB, 6V 21CP (Ref # 25)	92069-056	4
GASKET-SIG LAMP LENS (Ref # 26)	23050-003	4
BOLT-UPSET (Ref # 27)	112G0630	4
WASHER-PLAIN, 6MM (Ref # 28)	411D0600	8
WASHER SPRING 6MM (Ref # 29)	461F0600	4

1972 G5 PARTS LIST

TAILLIGHT/TURN SIGNALS ('74-'75 B/C)

ITEM NAME	PART NUMBER	QUANTITY
NUT 6MM (Ref # 30)	311B0600	4
BRACKET,FRNT TURN SIG (Ref # 31)	23051-1004	2
BRACKET,SIGNAL LAMP (Ref # 32)	23051-1013	2
WASHER-PLAIN,5MM (Ref # 33)	410D0500	4
WASHER SPRING 5MM (Ref # 34)	461F0500	4
BOLT (Ref # 35)	110N0516	4
DAMPER RUBBER (Ref # 36)	23066-003	2
SCREW PAN HEAD 3X5 (Ref # 37)	220B0305A	2
WIRE-TURN SIGNAL LEAD (Ref # 38)	26011-061	2
COVER-WIRING HARNESS (Ref # 39)	26009-004	2
LAMP-REAR TURN SIGNAL (Ref # 40)	23040-033	2
BKT-RR SIGNAL LAMP (Ref # 41)	23051-044	2
DAMPER RUBBER (Ref # 42)	92075-148	4
COLLAR 12.7X17.3X30 (Ref # 43)	92027-168	2
SPRING (Ref # 44)	92081-111	2
WASHER CUP 12.5X35X4T (Ref # 45)	92022-235	2
CLAMP-RR SIGNAL LAMP (Ref # 46)	92037-087	2
WASHER SPRING 12MM (Ref # 47)	461F1200	2
NUT-HEX-FINE,12MM (Ref # 48)	315B1200	2