

1973 G5-A PARTS DIAGRAM

TAILLIGHT/TURN SIGNALS ('74-'75 B/C)

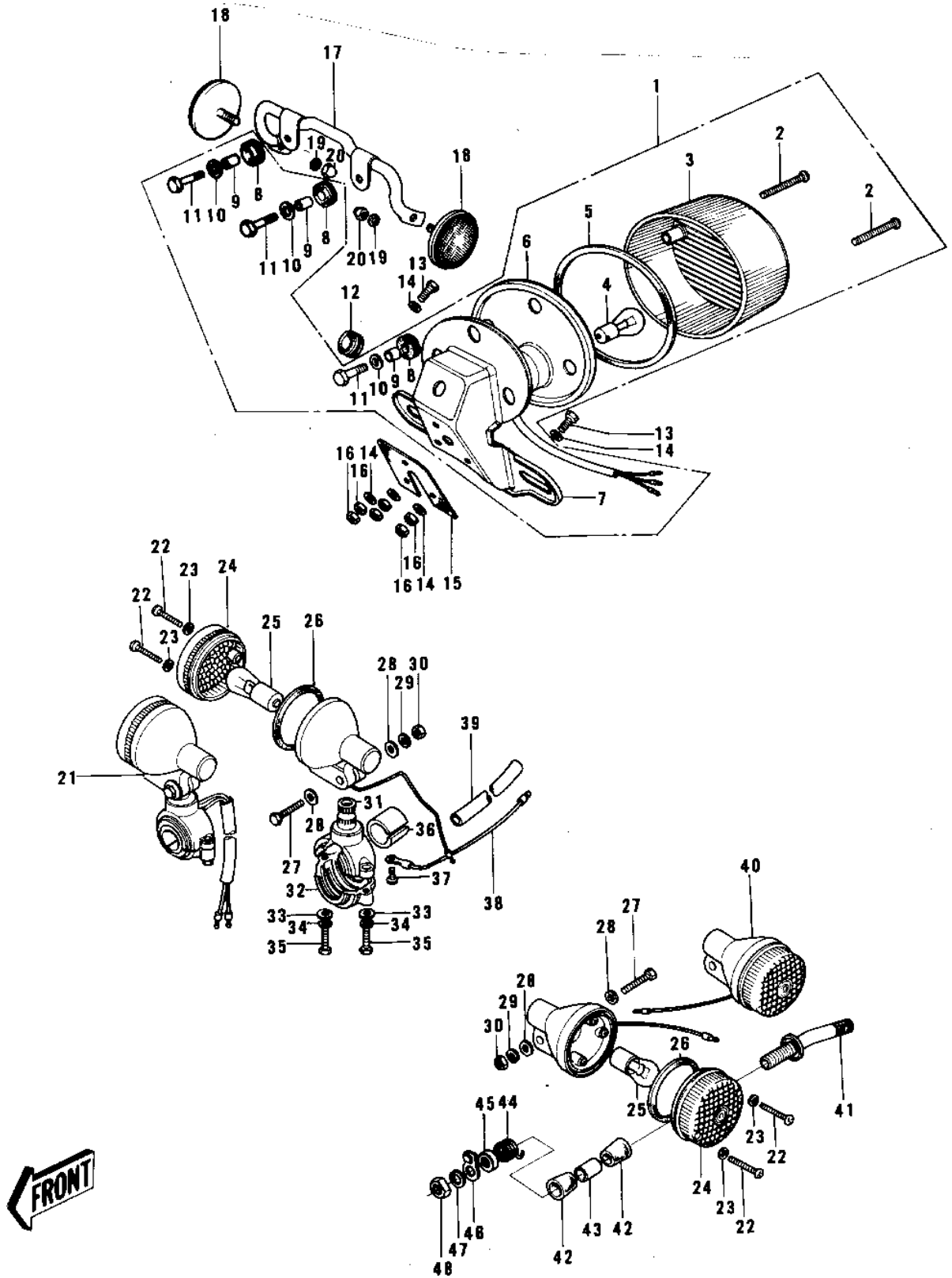

1973 G5-A PARTS LIST

TAILLIGHT/TURN SIGNALS ('74-'75 B/C)

ITEM NAME	PART NUMBER	QUANTITY
LAMP ASSY, TAIL, BLACK (Ref # 1)	23024-069-21	
SCREW-PAN HEAD, 4X35 (Ref # 2)	220E0435A	
LENS-TAIL LAMP (Ref # 3)	23026-023	
BULB, 6V 17/5.3W (Ref # 4)	92069-028	
GASKET-TAIL LAMP LENS (Ref # 5)	23028-018	
CASE, TAIL LAMP (Ref # 6)	23027-030	
BKT-LICENSE PLT. BLACK (Ref # 7)	23036-019-21	
DAMPER RUBBER (Ref # 8)	92075-076	
COLLAR, 6.8X10X8.5 (Ref # 9)	92027-129	
WASHER 6.5X20X1.6T (Ref # 10)	92022-125	
BOLT 6X22 (Ref # 11)	112B0622	
GROMMET HARNESS 10MM (Ref # 12)	92071-019	
BOLT-UPSET (Ref # 13)	112G0630	
WASHER 6.5X20X1.6T (Ref # 14)	92022-125	
DAMPER-TAIL LAMP SHCK (Ref # 15)	35039-005	
NUT 6MM (Ref # 16)	312B0600	
BRACKET-REFLECTOR (Ref # 17)	28013-005	
REFLECTOR-REFLEX, REAR (Ref # 18)	28012-008	
WASHER SPRING 5MM (Ref # 19)	461F0500	
NUT-CAP, 5MM (Ref # 20)	322N0500	
LAMP ASY-FR TURN SIG (Ref # 21)	23037-005	
SCREW-PAN HEAD, 4X20 (Ref # 22)	220E0420A	
WASHER-PLAIN, 4MM (Ref # 23)	23058-002	
LENS, TURN SIGNAL LAMP (Ref # 24)	23048-1001	
BULB, 6V 21CP (Ref # 25)	92069-056	
GASKET-SIG LAMP LENS (Ref # 26)	23050-003	
BOLT-UPSET (Ref # 27)	112G0630	
WASHER-PLAIN, 6MM (Ref # 28)	411D0600	
WASHER SPRING 6MM (Ref # 29)	461F0600	

1973 G5-A PARTS LIST

TAILLIGHT/TURN SIGNALS ('74-'75 B/C)

ITEM NAME	PART NUMBER	QUANTITY
NUT 6MM (Ref # 30)	311B0600	
BRACKET,FRNT TURN SIG (Ref # 31)	23051-1004	
BRACKET,SIGNAL LAMP (Ref # 32)	23051-1013	
WASHER-PLAIN,5MM (Ref # 33)	410D0500	
WASHER SPRING 5MM (Ref # 34)	461F0500	
BOLT (Ref # 35)	110N0516	
DAMPER RUBBER (Ref # 36)	23066-003	
SCREW PAN HEAD 3X5 (Ref # 37)	220B0305A	
WIRE-TURN SIGNAL LEAD (Ref # 38)	26011-061	
COVER-WIRING HARNESS (Ref # 39)	26009-004	
LAMP-REAR TURN SIGNAL (Ref # 40)	23040-033	
BKT-RR SIGNAL LAMP (Ref # 41)	23051-044	
DAMPER RUBBER (Ref # 42)	92075-148	
COLLAR 12.7X17.3X30 (Ref # 43)	92027-168	
SPRING (Ref # 44)	92081-111	
WASHER CUP 12.5X35X4T (Ref # 45)	92022-235	
CLAMP-RR SIGNAL LAMP (Ref # 46)	92037-087	
WASHER SPRING 12MM (Ref # 47)	461F1200	
NUT-HEX-FINE,12MM (Ref # 48)	315B1200	