

# 1980 KE100 PARTS DIAGRAM

## HEADLIGHT

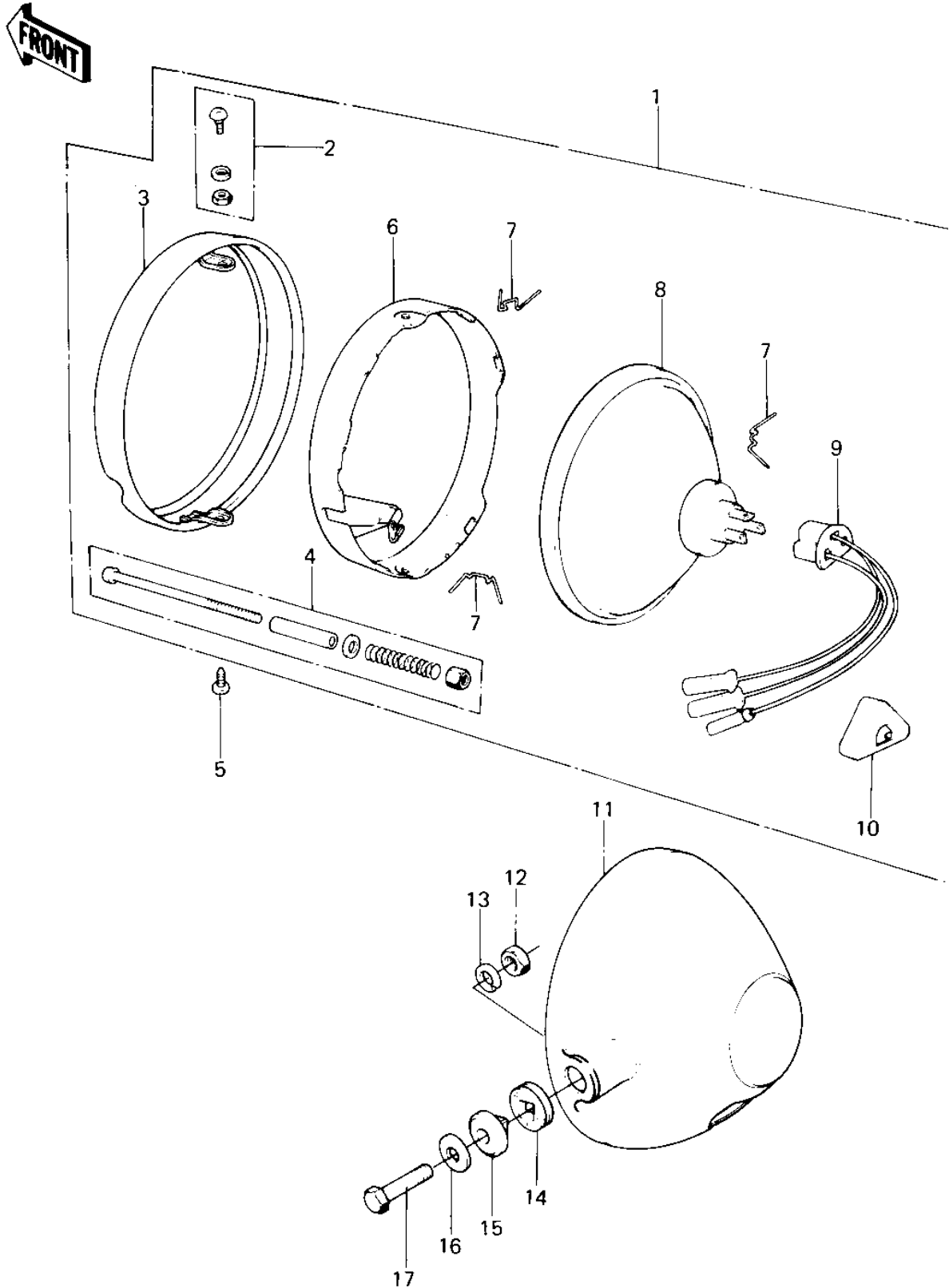

# 1980 KE100 PARTS LIST

## HEADLIGHT

| ITEM NAME                       | PART NUMBER  | QUANTITY |
|---------------------------------|--------------|----------|
| LAMP UNIT,HEAD (Ref # 1)        | 23003-024    |          |
| SCREW SET,LENS UNIT (Ref # 2)   | 23013-007    |          |
| RIM,HEAD LAMP (Ref # 3)         | 23006-042    |          |
| SCREW ASSY,FOCUS AJST (Ref # 4) | 23013-5001   |          |
| SCREW ASSY,FOCUS AJST (Ref # 4) | 23013-5001   |          |
| SCREW,PAN HEAD,5X14 (Ref # 5)   | 23019-025    |          |
| RETAINER,SEALED BEAM (Ref # 6)  | 23072-002    |          |
| CLAMP,HEAD LAMP LENS (Ref # 7)  | 23009-015    |          |
| SEALED BEAM UNIT (Ref # 8)      | 23007-055    |          |
| SOCKET ASSY,HD LIGHT (Ref # 9)  | 23008-044    |          |
| SOCKET ASSY,HD LIGHT (Ref # 9)  | 23008-044    |          |
| COVER,HD LAMP SOCKET (Ref # 10) | 23081-001    |          |
| BODY,HEAD LAMP,BLACK (Ref # 11) | 23005-049-21 |          |
| NUT,10MM (Ref # 12)             | 314B1000     |          |
| WASHER SPRING 10MM (Ref # 13)   | 461F1000     |          |
| DAMPER RUBBER (Ref # 14)        | 23066-011    |          |
| COLLAR (Ref # 15)               | 23052-005    |          |
| WASHER-PLAIN,10MM (Ref # 16)    | 411D1000     |          |
| BOLT,HEX HEAD,10X30 (Ref # 17)  | 92007-041    |          |
| BOLT HEX HEAD 10X28 (Ref # 17)  | 113N1028     |          |