

1981 KE100 PARTS DIAGRAM

OWNER TOOLS

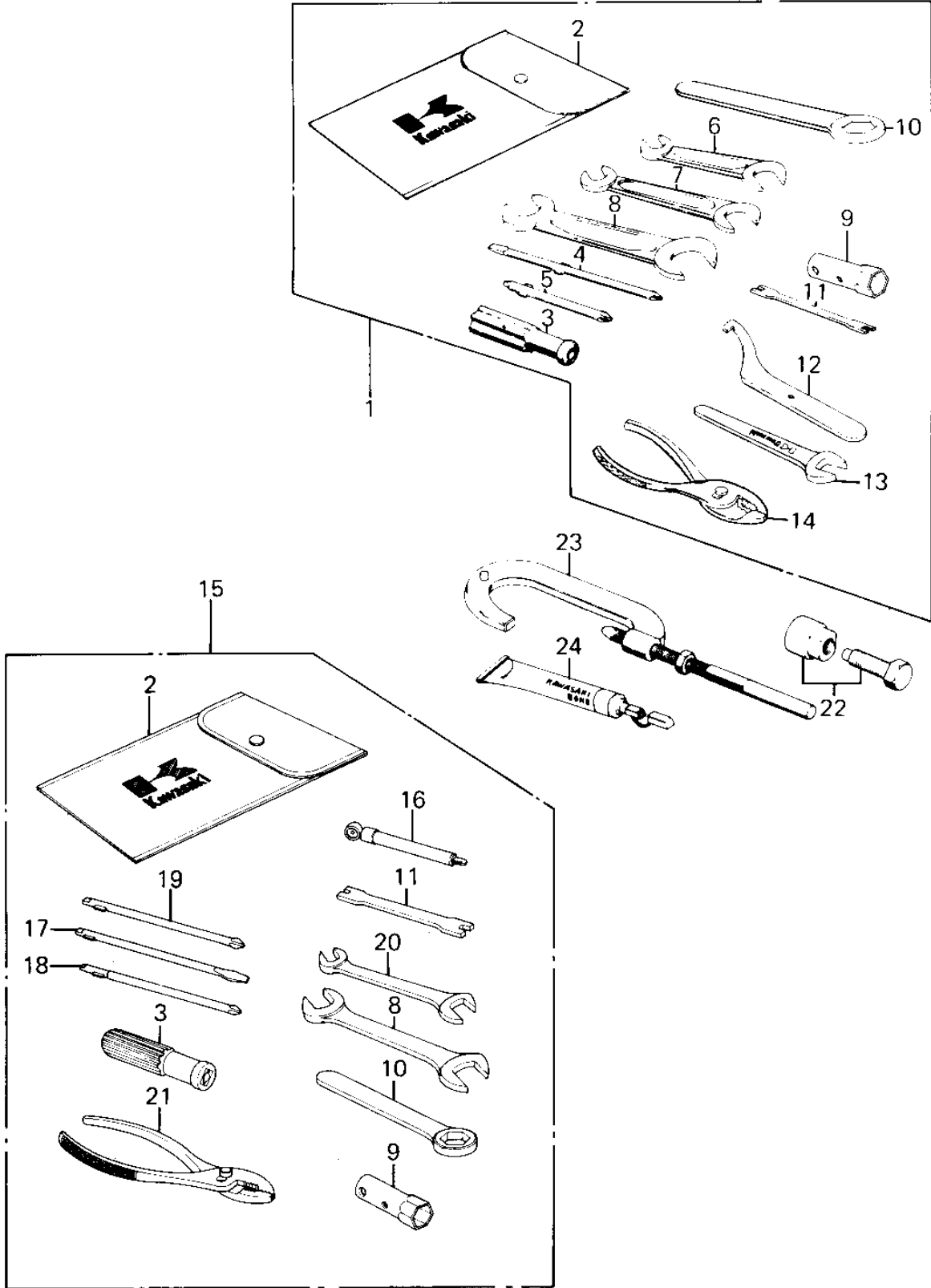

1981 KE100 PARTS LIST

OWNER TOOLS

ITEM NAME	PART NUMBER	QUANTITY
56007-1056 (Canada) (Ref # 1)	56007-1004	1
TOOL KIT (Ref # 1)	56007-1056	1
BAG,TOOL (Ref # 2)	56008-008	1
BAG,TOOL (Ref # 2)	56008-1007	1
GRIP,SCREW DRIVER (Ref # 3)	92106-1001	1
TOOL-DRIVER (Ref # 4)	92107-1052	1
SCREW DRIVER #3 PHLIP (Ref # 5)	92107-005	1
WRENCH,OPEN,8X10 (Ref # 6)	92126-001	1
WRENCH,OPEN END,12X13 (Ref # 7)	92126-002	1
TOOL-WRENCH,OPEN END, (Ref # 8)	92110-1153	1
TOOL-WRENCH,OPEN END, (Ref # 8)	92110-1153	2
WRENCH,BOX,17X21 (Ref # 9)	92110-012	1
TOOL-WRENCH,BOX END,2 (Ref # 10)	92110-1148	1
TIGHTENER,SPOKE (Ref # 11)	92108-011	1
92110-1035 (Canada) (Ref # 12)	92110-1006	1
WRENCH,OPEN END,10M/M (Ref # 13)	92110-1031	1
92112-003 (Canada) (Ref # 14)	92112-005	1
TOOL KIT (Ref # 15)	56007-1072	1
GAUGE,AIR,3.5KG/CM2 (Ref # 16)	52005-1031	1
92107-1052 (Canada) (Ref # 17)	92107-007	1
TOOL-DRIVER (Ref # 18)	92107-1052	1
92107-1002 (Canada) (Ref # 19)	92107-008	1
TOOL-WRENCH,OPEN END (Ref # 20)	92110-1038	1
PLIERS,160MM (Ref # 21)	92112-003	1
PULLER,FLYWHEL MAGNET (Ref # 22)	57001-252	1
57001-1243 (Canada) (Ref # 23)	57001-307	1
LIQUID GASKET (Ref # 24)	92104-002	10