

1978 KM100-A3A PARTS DIAGRAM

FENDERS (KM100-A1~A4)

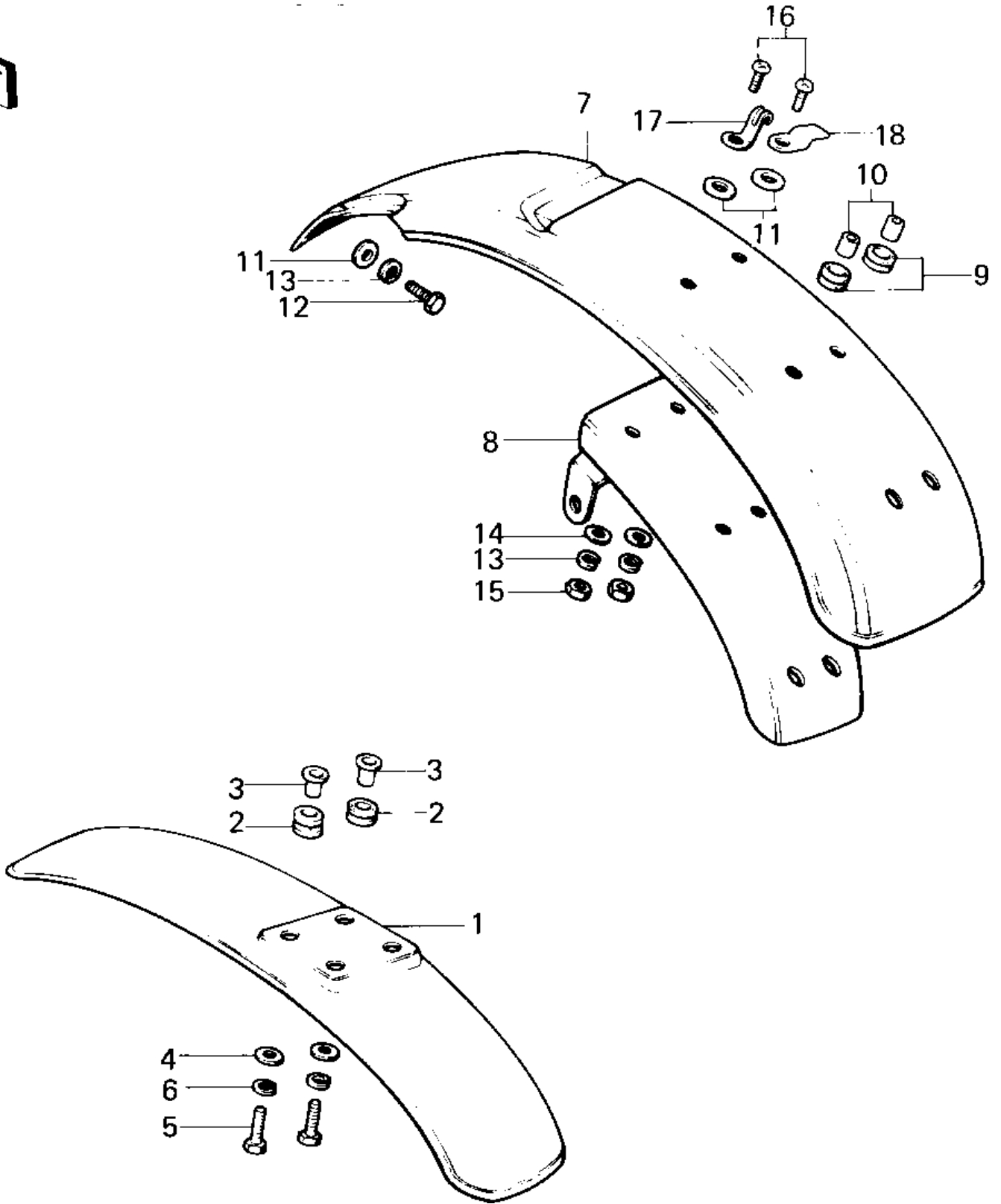

1978 KM100-A3A PARTS LIST

FENDERS (KM100-A1~A4)

ITEM NAME	PART NUMBER	QUANTITY
FENDER-FR,BLACK (Ref # 1)	35004-080-10	
FENDER-FR,GRAY (Ref # 1)	35004-109-6Y	
FENDER-FR,WHITE (Ref # 1)	35004-109-6V	
FENDER-FR,S.YELLOW (Ref # 1)	35004-109-6R	
DAMPER RUBBER (Ref # 2)	92075-103	
COLLAR (Ref # 3)	92027-153	
WASHER 6.5X20X1.6T (Ref # 4)	92022-125	
BOLT-UPSET (Ref # 5)	112G0618	
WASHER SPRING 6MM (Ref # 6)	461F0600	
FENDER,REAR,BLACK (Ref # 7)	35022-094-10	
FENDER-RR,BLACK (Ref # 7)	35022-162-6Z	
FENDER-RR,GRAY (Ref # 7)	35022-162-6Y	
FENDER-RR,WHITE (Ref # 7)	35022-162-6V	
FENDER-RR,S.YELLOW (Ref # 7)	35022-162-6R	
GUSSET,REAR FENDER (Ref # 8)	35034-019	
DAMPER RUBBER,RR FENR (Ref # 9)	92075-209	
COLLAR (Ref # 10)	92027-169	
WASHER 6.5X20X1.6T (Ref # 11)	92022-125	
BOLT-UPSET 6X14 (Ref # 12)	112B0614	
WASHER SPRING 6MM (Ref # 13)	461F0600	
WASHER PLAIN 6MM (Ref # 14)	411B0600	
NUT 6MM (Ref # 15)	311B0600	
SCREW PAN HEAD 6X16 (Ref # 16)	220B0616	
CLIP WIRING HARNESS (Ref # 17)	35024-002	
CLAMP CABLE (Ref # 18)	92037-020	