

1975 KS125-A PARTS DIAGRAM

REAR HUB/BRAKE ('74-'75)

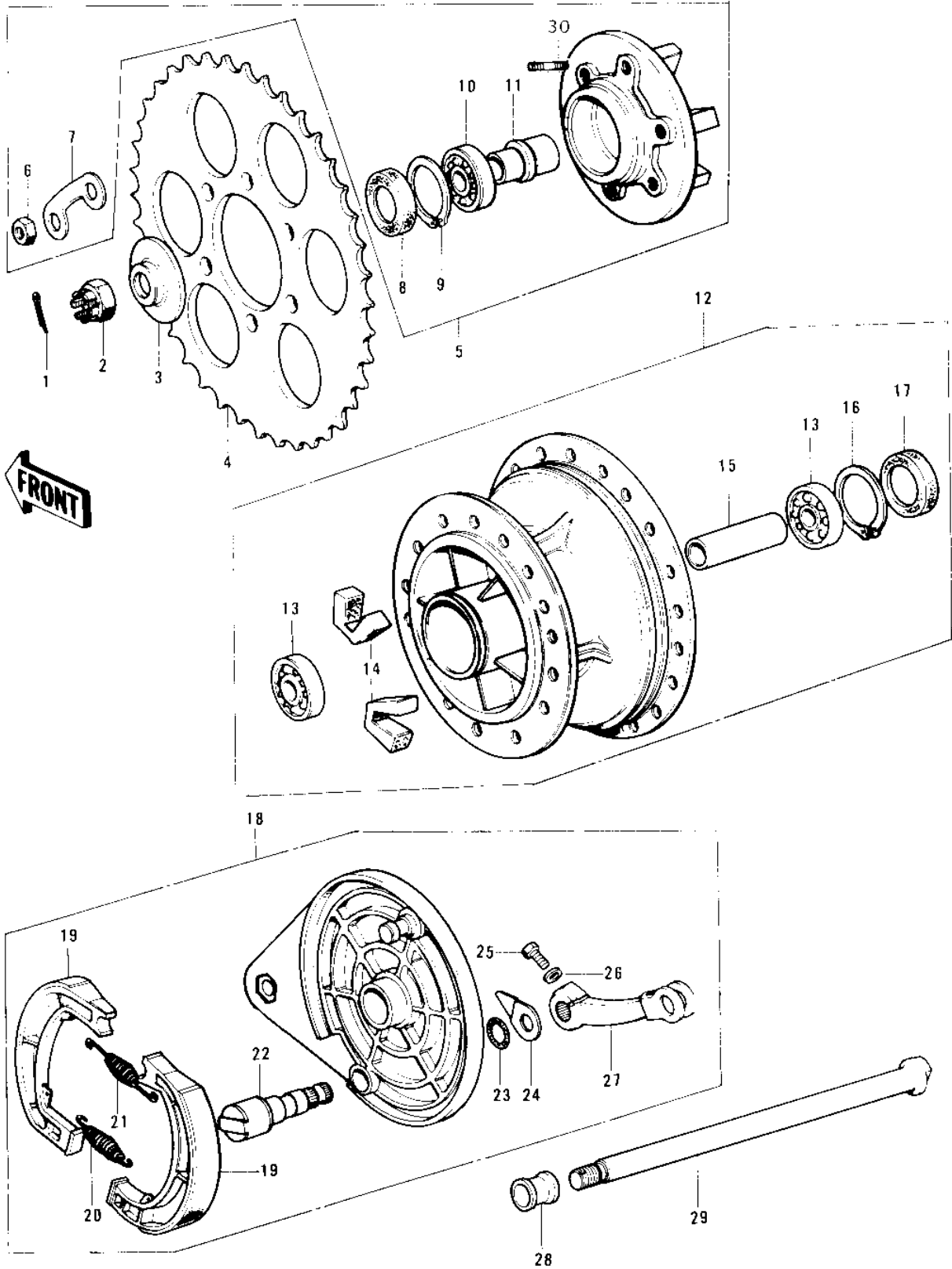

1975 KS125-A PARTS LIST

REAR HUB/BRAKE ('74-'75)

| ITEM NAME | PART NUMBER | QUANTITY |
|----------------------------------|--------------|----------|
| PIN-COTTER,4.0X35 (Ref # 1) | 550D4035 | 1 |
| NUT CASTLE 14MM (Ref # 2) | 92103-006 | 1 |
| COLLAR,REAR AXLE,L.H (Ref # 3) | 42032-048 | 1 |
| REAR SPROCKET.50T (Ref # 4) | 42041-146 | 1 |
| COUPLING ASSY,RR HUB (Ref # 5) | 42008-031 | 1 |
| NUT,8MM (Ref # 6) | 311B0800 | 6 |
| WASHER,SPROCKET LOCK (Ref # 7) | 92088-019 | 3 |
| OIL SEAL,RR HUB BRNG (Ref # 8) | 92050-060 | 1 |
| CIRCLIP,42MM (Ref # 9) | 92033-1041 | 1 |
| BEARING BALL #6004 (Ref # 10) | 601B6004 | 1 |
| SLEEVE,RR HUB COUPLNG (Ref # 11) | 42036-018 | 1 |
| DRUM ASY,RR BK,BUFF (Ref # 12) | 42005-038-80 | 1 |
| BEARING BALL #6202 (Ref # 13) | 601B6202 | 2 |
| DAMPER,REAR HUB SHOCK (Ref # 14) | 42014-023 | 6 |
| SPACER,RR HUB BEARING (Ref # 15) | 42010-029 | 1 |
| CIRCLIP,35MM (Ref # 16) | 481J3500 | 1 |
| OIL SEAL,TCY22358 (Ref # 17) | 654A223508 | 1 |
| PANEL ASY,RR BK,BUFF (Ref # 18) | 42006-044-80 | 1 |
| SHOE,BRAKE (Ref # 19) | 42019-010 | 2 |
| SPRING,BRAKE SHOE (Ref # 20) | 92081-1550 | 1 |
| SPRING,BRAKE SHOE (Ref # 21) | 92081-1766 | 1 |
| CAM SHAFT,REAR BRAKE (Ref # 22) | 42026-025 | 1 |
| "0" RING,11MM (Ref # 23) | 92055-004 | 1 |
| INDICATOR,FR BRK PNL (Ref # 24) | 41085-002 | 1 |
| BOLT 6X22 (Ref # 25) | 112B0622 | 1 |
| WASHER PLAIN 6MM (Ref # 26) | 410B0600 | 1 |
| LEVER,REAR BRAKE CAM (Ref # 27) | 42029-030 | 1 |
| COLLAR,REAR AXLE,R.H (Ref # 28) | 42032-047 | 1 |
| AXLE,REAR (Ref # 29) | 42031-046 | 1 |

1975 KS125-A PARTS LIST

REAR HUB/BRAKE ('74-'75)

| ITEM NAME | PART NUMBER | QUANTITY |
|----------------------|-------------|----------|
| STUD,8X17 (Ref # 30) | 92004-1015 | 1 |