

1978 KX125-A4 PARTS DIAGRAM

CLUTCH (78-'79 KX125-A4/A5)

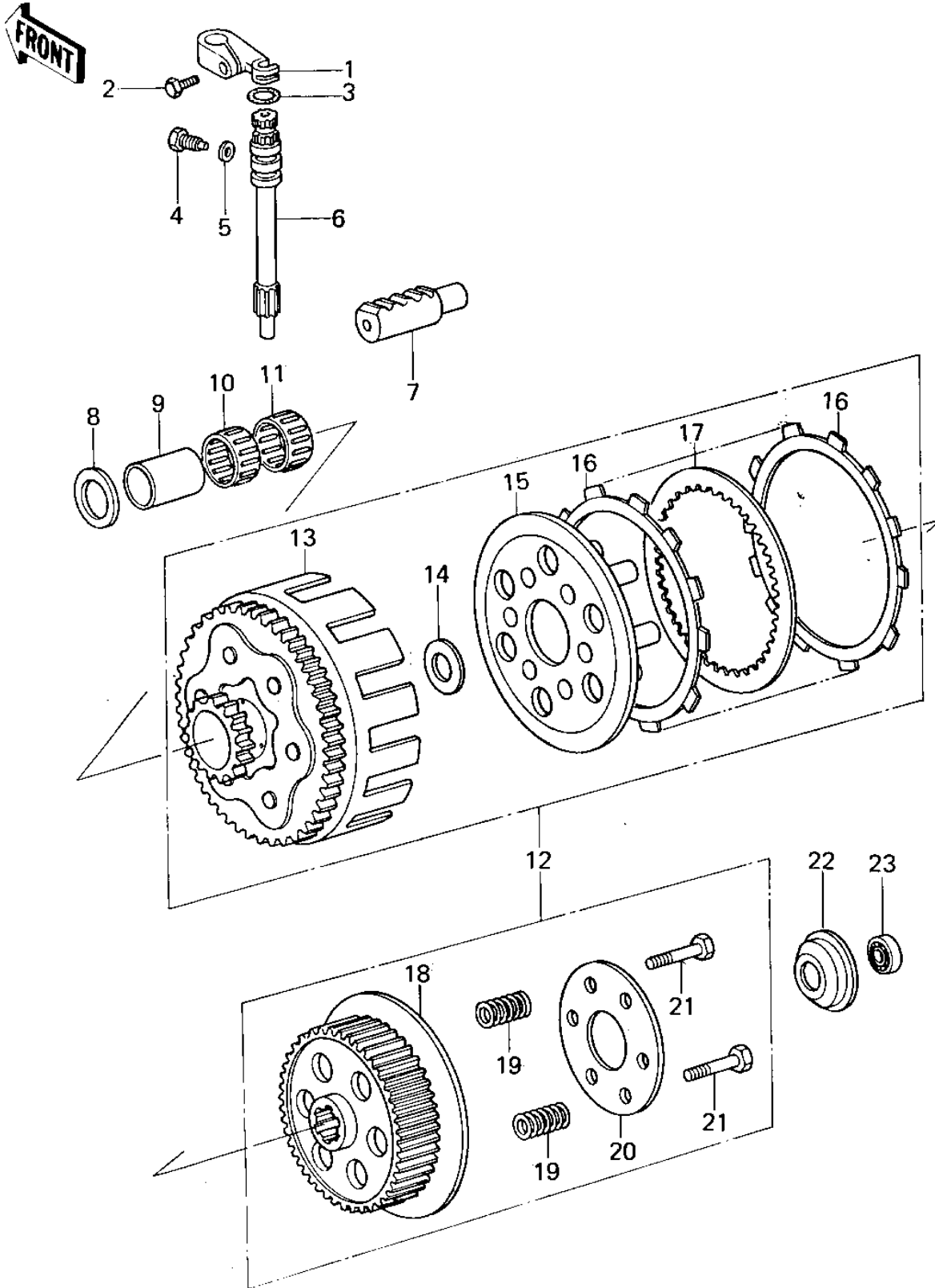

1978 KX125-A4 PARTS LIST

CLUTCH ('78-'79 KX125-A4/A5)

| ITEM NAME | PART NUMBER | QUANTITY |
|---------------------------------|-------------|----------|
| LEVER,CLUTCH RELEASE (Ref # 1) | 13168-1010 | 1 |
| BOLT-UPSET (Ref # 2) | 112G0618 | 1 |
| "0" RING, 10MM (Ref # 3) | 670B2010 | 1 |
| BOLT,CLUTCH RELEASE (Ref # 4) | 92003-130 | 1 |
| GASKET,R.H ENG COVER (Ref # 5) | 92065-092 | 1 |
| SHAFT,CLUTCH RELEASE (Ref # 6) | 13106-1001 | 1 |
| ROD,CLUTCH PUSH (Ref # 7) | 13116-025 | 1 |
| WASHER,PLAIN (Ref # 8) | 92022-270 | 1 |
| BUSHING,CLUTCH (Ref # 9) | 92028-1018 | 1 |
| BEARING,NEEDLE (Ref # 10) | 92046-1004 | 1 |
| BRG,N,KT222613-C3 (Ref # 11) | 92046-1005 | 1 |
| CLUTCH-ASSY (Ref # 12) | 13081-1011 | 1 |
| HOUSING,CLUTCH (Ref # 13) | 13095-1007 | 1 |
| WASHER,PLAIN (Ref # 14) | 92022-270 | 1 |
| WHEEL,CLUTCH (Ref # 15) | 13086-1001 | 1 |
| PLATE-FRICTION (Ref # 16) | 13088-1015 | 6 |
| PLATE,CLUTCH STEEL (Ref # 17) | 13089-1002 | 5 |
| HUB,CLUTCH (Ref # 18) | 13087-1002 | 1 |
| SPRING,CLUTCH (Ref # 19) | 92081-123 | 6 |
| HOLDER,CLUTCH (Ref # 20) | 13091-1011 | 1 |
| BOLT,5X18 (Ref # 21) | 92003-078 | 6 |
| HOLDER,CLUTCH PUSHER (Ref # 22) | 13091-1071 | 1 |
| BEARING,BALL (Ref # 23) | 92045-1005 | 1 |