

# 1972 F6-A PARTS DIAGRAM

FRONT HUB/BRAKE

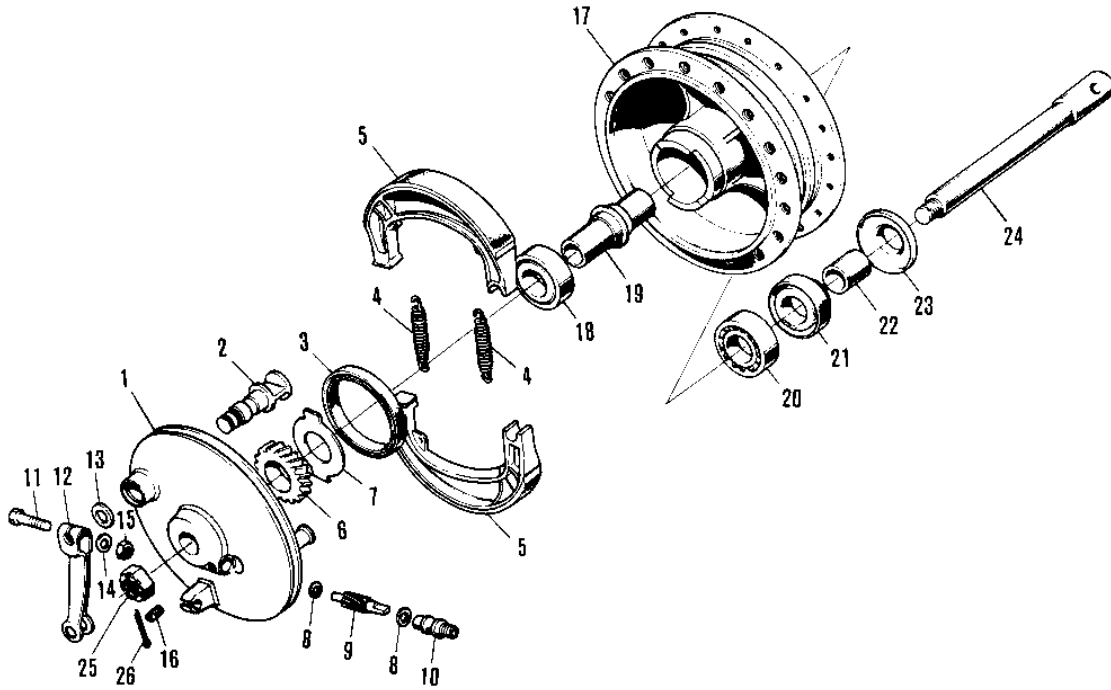

# 1972 F6-A PARTS LIST

## FRONT HUB/BRAKE

| ITEM NAME                         | PART NUMBER  | QUANTITY |
|-----------------------------------|--------------|----------|
| PANEL-ASY,FR BRK BLK (Ref # 1-16) | 41035-033-21 |          |
| PANEL-ASY,FR BRK BLK (Ref # 1-16) | 41035-033-21 |          |
| CAM SHAFT-FRONT BRAKE (Ref # 2)   | 41050-018    |          |
| OIL SEAL F BRK PANEL (Ref # 3)    | 92050-010    |          |
| SPRING,BRAKE SHOE (Ref # 4)       | 92081-1766   |          |
| SHOE,BRAKE (Ref # 5)              | 41048-1007   |          |
| GEAR-SPEEDOMETER (Ref # 6)        | 41059-014    |          |
| RECIEVER-SPEED GEAR (Ref # 7)     | 41064-006    |          |
| WASHER THRST SPD PINI (Ref # 8)   | 41063-001    |          |
| PINION SPEEDOMETER (Ref # 9)      | 41060-004    |          |
| BUSH SPEEDMETER CABLE (Ref # 10)  | 41062-001    |          |
| BOLT-UPSET (Ref # 11)             | 112G0630     |          |
| LEVER FRONT BRAKE CAM (Ref # 12)  | 41053-005    |          |
| WASHER BRAKE CAM SHT (Ref # 13)   | 41052-001    |          |
| WASHER PLAIN 6MM (Ref # 14)       | 410B0600     |          |
| NUT 6MM (Ref # 15)                | 311B0600     |          |
| SCREW-BUSHING NET (Ref # 16)      | 41070-004    |          |
| SCREW-BUSHING NET (Ref # 16)      | 41070-004    |          |
| PIN,SPRING (Ref # 16)             | 41082-001    |          |
| DRUM-ASSY,FR BRK (Ref # 17-21)    | 41034-004    |          |
| BEARING BALL #6301Z (Ref # 18)    | 601B6301Z    |          |
| SPACER FR HUB BEARING (Ref # 19)  | 41039-005    |          |
| BEARING BALL #6301 (Ref # 20)     | 601B6301     |          |
| OIL SEAL FR BRK DRUM (Ref # 21)   | 92050-011    |          |
| COLLAR FRONT HUB R.H (Ref # 22)   | 41069-005    |          |
| DUST SHIELD FR BRAKE (Ref # 23)   | 41042-006    |          |
| AXLE-FRONT (Ref # 24)             | 41068-034    |          |
| NUT CASTLE 12MM (Ref # 25)        | 321B1200     |          |
| PIN COTTER 3.0X25 (Ref # 26)      | 550D3025     |          |