

1971 F6 PARTS DIAGRAM

SEAT/CARRIER/CHAIN COVER

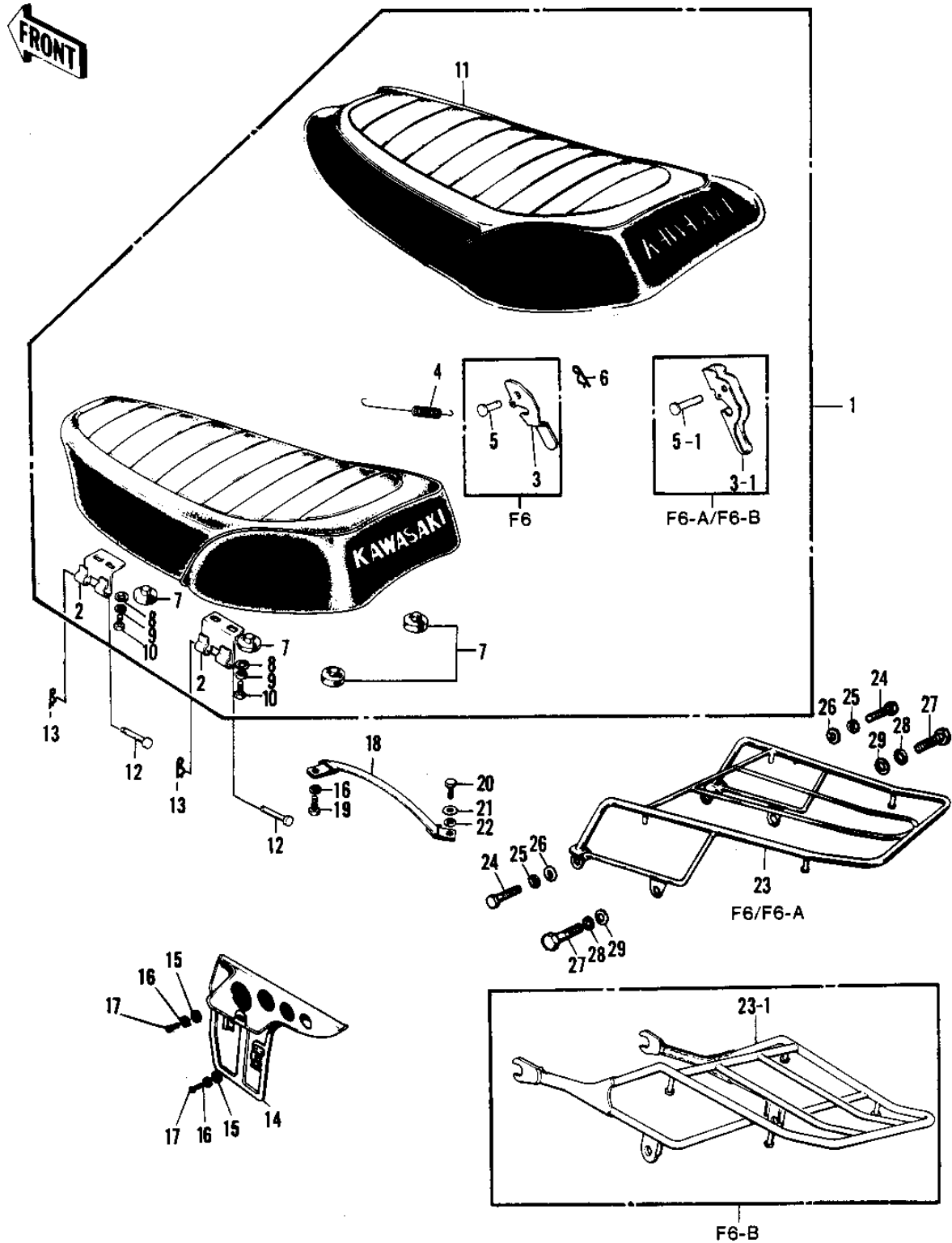



1971 F6 PARTS LIST

SEAT/CARRIER/CHAIN COVER

| ITEM NAME | PART NUMBER | QUANTITY |
|----------------------------------|--------------|----------|
| SEAT-DUAL (Ref # 1) | 53002-021 | 1 |
| SEAT ASSY-DUAL (Ref # 1) | 53002-043 | 1 |
| HINGE (Ref # 2) | 53009-015 | 2 |
| HOOK (Ref # 3) | 53008-008 | 1 |
| HOOK (Ref # 3-1) | 53008-012 | 1 |
| SPRING,HOOK (Ref # 4) | 53012-013 | 1 |
| PIN DUAL SEAT PIVOT (Ref # 5) | 53011-001 | 1 |
| PIN-DUAL SEAT PIVOT (Ref # 5-1) | 53011-004 | 1 |
| COTTER PIN (Ref # 6) | 92041-003 | 1 |
| DAMPER RUBB DUAL SEAT (Ref # 7) | 92075-023 | 5 |
| WASHER PLAIN 6MM (Ref # 8) | 411B0600 | 4 |
| WASHER SPRING 6MM (Ref # 9) | 461F0600 | 5 |
| BOLT-UPSET 6X14 (Ref # 10) | 112B0614 | 4 |
| COVER-DUAL SEAT (Ref # 11) | 53003-006 | 1 |
| PIN (Ref # 12) | 53011-002 | 2 |
| COTTER PIN (Ref # 13) | 92041-003 | 2 |
| CASE-CHAIN,BLACK (Ref # 14) | 36014-035-21 | 1 |
| WASHER PLAIN 6MM (Ref # 15) | 411B0600 | 2 |
| WASHER SPRING 6MM (Ref # 16) | 461F0600 | 3 |
| SCREW PAN HEAD 6X12 (Ref # 17) | 220B0612 | 2 |
| BAND-SEAT STOPPER (Ref # 18) | 92072-038 | 1 |
| BAND-SEAT STOPPER (Ref # 18) | 92072-038 | 1 |
| BOLT,6X10 (Ref # 19) | 112G0610 | 1 |
| BOLT-UPSET,6X12 (Ref # 20) | 112G0612 | 1 |
| WASHER LOCK 6MM (Ref # 21) | 464H0600 | 1 |
| WASHER PLAIN 6MM (Ref # 22) | 410B0600 | 1 |
| CARRIER-LUGGAGE (Ref # 23) | 53029-038 | 1 |
| CARRIER-LUGGAGE (Ref # 23-1) | 53029-045 | 1 |
| BOLT-SMALL-UPSET,8X18 (Ref # 24) | 115G0818 | 2 |

1971 F6 PARTS LIST

SEAT/CARRIER/CHAIN COVER

| ITEM NAME | PART NUMBER | QUANTITY |
|--------------------------------|-------------|----------|
| WASHER SPRING 8MM (Ref # 25) | 461F0800 | 2 |
| WASHER PLAIN 8MM (Ref # 26) | 410B0800 | 2 |
| BOLT,HEX HEAD,10X18 (Ref # 27) | 113G1018 | 2 |
| BOLT,10X28 (Ref # 27) | 113G1028 | 2 |
| WASHER SPRING 10MM (Ref # 28) | 461F1000 | 2 |
| WASHER PLAIN 10MM (Ref # 29) | 410B1000 | 2 |