

# 1972 F7-A PARTS DIAGRAM

HANDLEBAR (F7/F7-A)

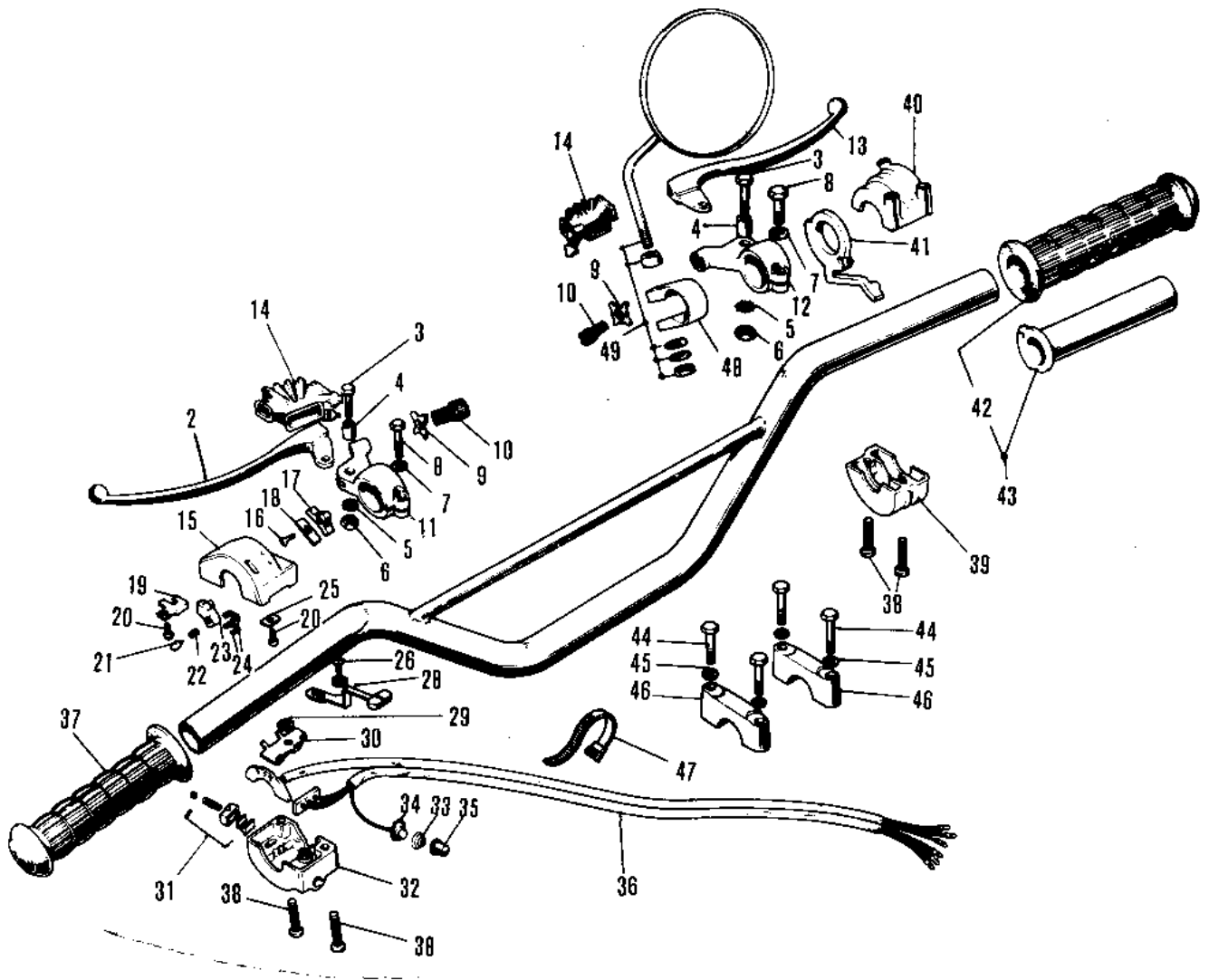

# 1972 F7-A PARTS LIST

## HANDLEBAR (F7/F7-A)

| ITEM NAME                               | PART NUMBER | QUANTITY |
|---|-------------|----------|
| HANDLEBAR (Ref # 1)                     | 46004-016   |          |
| LEVER ASSY-CLUTCH (Ref # 2 ~11)         | 46076-014   |          |
| LEVER-CLUTCH (Ref # 2)                  | 46092-015   |          |
| BOLT HEX HEAD 5X20 (Ref # 3)            | 92007-020   |          |
| COLLAR LEVER (Ref # 4)                  | 46059-011   |          |
| WASHER LOCK 5MM (Ref # 5)               | 464H0500    |          |
| NUT 5MM (Ref # 6)                       | 312B0500    |          |
| WASHER PLAIN 6MM (Ref # 7)              | 410B0600    |          |
| BOLT, HEX HEAD 6X22 (Ref # 8)           | 110N0622    |          |
| NUT LOCK ADJUST SCREW (Ref # 9)         | 46056-001   |          |
| SCREW CABLE ADJUST (Ref # 10)           | 46055-003   |          |
| HOLDER,CLUTCH LEVER (Ref # 11)          | 46094-010   |          |
| LEVER ASSY-FRNT BRAKE (Ref # 3 ~ 10)    | 46021-010   |          |
| UNAVAILABLE IN PRICE BOOK (Ref # 12,13) |             |          |
| HOLDER-FR BRAKE LEVER (Ref # 12)        | 46060-006   |          |
| LEVER FRONT BRAKE (Ref # 13)            | 46058-004   |          |
| DUST COVER (Ref # 14)                   | 46071-001   |          |
| CASE ASSY-L.H (Ref # 15~36,)            | 46091-004   |          |
| CASE L.H SWITCH UPPER (Ref # 15)        | 46086-013   |          |
| SCREW CNTSNK HD 3X8 (Ref # 16)          | 221B0308A   |          |
| KNOB-L.H SWITCH (Ref # 17)              | 46044-011   |          |
| SPRING L.H SW KNOB (Ref # 18)           | 46031-003   |          |
| HOLDER L.H SW LOWER B (Ref # 19)        | 46085-014   |          |
| SCREW PAN HEAD 3X5 (Ref # 20)           | 220B0305A   |          |
| CONTACT L.H SWITCH (Ref # 21)           | 46079-002   |          |
| SPRING L.H SWITCH (Ref # 22)            | 46031-004   |          |
| SWITCH L.H (Ref # 23)                   | 46089-003   |          |
| PLATE L.H SW CONTACT (Ref # 24)         | 46080-002   |          |
| HOLDER L.H SW UPPER A (Ref # 25)        | 46085-013   |          |

# 1972 F7-A PARTS LIST

## HANDLEBAR (F7/F7-A)

| ITEM NAME                        | PART NUMBER | QUANTITY |
|----------------------------------|-------------|----------|
| SCREW PAN HEAD 3X8 (Ref # 26)    | 220B0308    |          |
| KNOB-SWITCH (Ref # 28)           | 46044-006   |          |
| WASHER (Ref # 29)                | 92095-010   |          |
| HOLDER L.H SW LOWER (Ref # 30)   | 46085-015   |          |
| SLIDE BLOCK AY-L.H SW (Ref # 31) | 46089-004   |          |
| CASE L.H SWITCH LOWER (Ref # 32) | 46077-015   |          |
| SWITCH ASSY,HORN BUTN (Ref # 33) | 27010-1009  |          |
| SWITCH ASSY,HORN BUTN (Ref # 34) | 27010-1009  |          |
| SWITCH ASSY,HORN BUTN (Ref # 35) | 27010-1009  |          |
| WIRING HARNESS-L.H SW (Ref # 36) | 46082-017   |          |
| RUBBER-L.H GRIP (Ref # 37)       | 46075-017   |          |
| SCREW PAN HEAD 5X22 (Ref # 38)   | 220B0522    |          |
| CASE ASSY-R.H (Ref # 38 ~ 4)     | 46018-019   |          |
| CASE-R.H LOWER (Ref # 39)        | 46023-005   |          |
| CASE-R.H LOWER (Ref # 39)        | 46023-005   |          |
| CASE-R.H.UPPER (Ref # 40)        | 46041-005   |          |
| LEVER-STARTER (Ref # 41)         | 46096-006   |          |
| RUBBER-R.H GRIP (Ref # 42)       | 46061-012   |          |
| GRIP ASSY-THROTTLE (Ref # 43)    | 46019-013   |          |
| GRIP ASSY-THROTTLE (Ref # 43)    | 46019-018   |          |
| BOLT 8X38 (Ref # 44)             | 92001-1405  |          |
| WASHER SPRING 8MM (Ref # 45)     | 461F0800    |          |
| HOLDER-HANDLEBAR (Ref # 46)      | 46012-008   |          |
| HOLDER UPPER HANDLBAR (Ref # 46) | 46012-004   |          |
| BAND,SHORT (Ref # 47)            | 92072-030   |          |
| BRACKET (Ref # 48)               | 56006-001   |          |
| REAR VIEW MIRROR LH (Ref # 49)   | 56003-016   |          |
| REAR VIEW MIRROR R.H. (Ref # 49) | 56002-024   |          |