

1971 F7 PARTS DIAGRAM

FENDERS (F7)

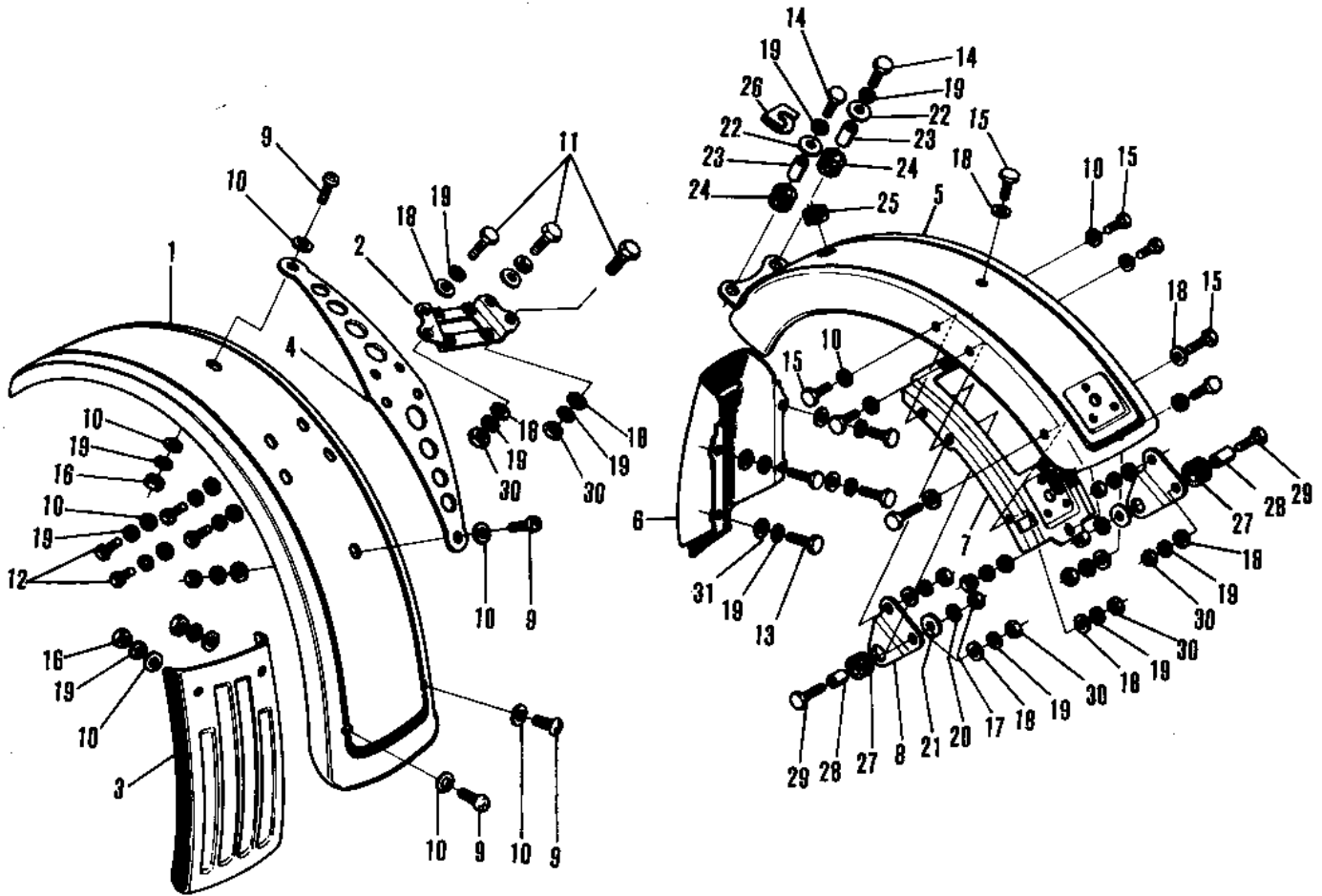

1971 F7 PARTS LIST

FENDERS (F7)

| ITEM NAME | PART NUMBER | QUANTITY |
|----------------------------------|--------------|----------|
| FENDER-FR,YELLOW (Ref # 1) | 35004-055-53 | 1 |
| BRACKET-FRONT FENDER (Ref # 2) | 35012-013 | 1 |
| FLAP-FR FENDER,RUBBER (Ref # 3) | 35019-004 | 1 |
| PLATE FRONT FENDER (Ref # 4) | 35013-003 | 1 |
| FENDER-REAR,B YELLOW (Ref # 5) | 35022-054-53 | 1 |
| FENDER-RR (Ref # 6) | 35022-053 | 1 |
| BRACE-REAR FENDER (Ref # 7) | 35034-012 | 1 |
| BRACKET-REAR FENDER (Ref # 8) | 35025-019 | 2 |
| SCREW PAN HEAD 6X12 (Ref # 9) | 220E0612 | 4 |
| WASHER 6.5X20X1.6T (Ref # 10) | 92022-125 | 16 |
| BOLT-UPSET (Ref # 11) | 112G0625 | 4 |
| BOLT-UPSET,6X12 (Ref # 12) | 112G0612 | 4 |
| BOLT-UPSET 6X14 (Ref # 13) | 112B0614 | 4 |
| BOLT-UPSET (Ref # 14) | 112G0618 | 2 |
| SCREW PAN HEAD 6X14 (Ref # 15) | 220B0614 | 10 |
| NUT 6MM (Ref # 16) | 312B0600 | 4 |
| NUT,8MM (Ref # 17) | 311B0800 | 2 |
| WASHER PLAIN 6MM (Ref # 18) | 411B0600 | 22 |
| WASHER SPRING 6MM (Ref # 19) | 461F0600 | 30 |
| WASHER SPRING 8MM (Ref # 20) | 461F0800 | 2 |
| WASHER,8X26X2.3 (Ref # 21) | 92022-1564 | 2 |
| WASHER 6.5X20X1.6T (Ref # 22) | 92022-125 | 2 |
| COLLAR (Ref # 23) | 92027-103 | 2 |
| DAMPER RUBBER (Ref # 24) | 92075-051 | 2 |
| GROMMET HARNESS 10MM (Ref # 25) | 92071-010 | 1 |
| PLATE-GROUND WIRE (Ref # 26) | 26015-001 | 1 |
| DAMPER RUBB TANK FRNT (Ref # 27) | 92075-013 | 2 |
| SPACER FUEL TANK MONT (Ref # 28) | 92027-012 | 2 |
| BOLT-SMALL-UPSET (Ref # 29) | 115B0832 | 2 |

1971 F7 PARTS LIST

FENDERS (F7)

| ITEM NAME | PART NUMBER | QUANTITY |
|--------------------------------|-------------|----------|
| NUT 6MM (Ref # 30) | 311B0600 | 12 |
| COLLAR (Ref # 31) | 92027-122 | 4 |
| EMBLEM-FRONT FENDER (Ref # 32) | 56027-015 | 2 |
| EMBLEM-REAR FENDER (Ref # 33) | 56027-016 | 4 |
| EMBLEM-FENDER (Ref # 34) | 56027-017 | 1 |