

1975 F7-D PARTS DIAGRAM

FENDERS (F7-B)

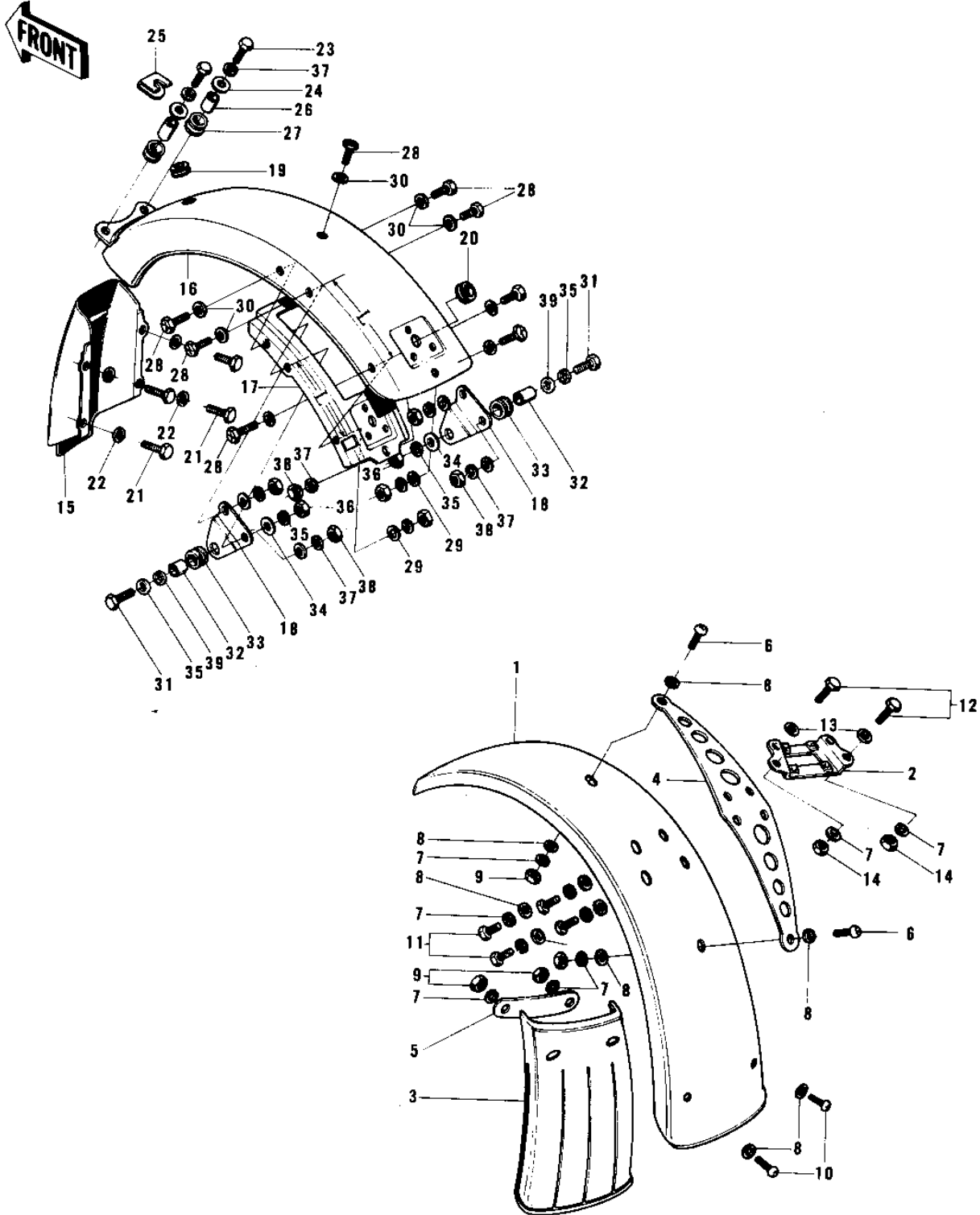

1975 F7-D PARTS LIST

FENDERS (F7-B)

| ITEM NAME | PART NUMBER | QUANTITY |
|---------------------------------|--------------|----------|
| FENDER,B.ORANGE (Ref # 1) | 35004-072-88 | |
| FENDER-FR,C.BLUE (Ref # 1) | 35004-072-93 | |
| BRACKET-FRONT FENDER (Ref # 2) | 35012-013 | |
| FLAP-FR FENDER,RUBBER (Ref # 3) | 35019-004 | |
| PLATE FRONT FENDER (Ref # 4) | 35013-003 | |
| PLATE-FR FENDER FLAP (Ref # 5) | 35020-007 | |
| SCREW PAN HEAD 6X12 (Ref # 6) | 220E0612 | |
| WASHER SPRING 6MM (Ref # 7) | 461F0600 | |
| WASHER 6.5X20X1.6T (Ref # 8) | 92022-125 | |
| NUT 6MM (Ref # 9) | 312B0600 | |
| SCREW PAN HEAD 6X14 (Ref # 10) | 220E0614 | |
| BOLT-UPSET,6X12 (Ref # 11) | 112G0612 | |
| BOLT-HEX HEAD,6X32 (Ref # 12) | 110N0632 | |
| WASHER PLAIN 6MM (Ref # 13) | 411B0600 | |
| NUT 6MM (Ref # 14) | 311B0600 | |
| FENDER-RR (Ref # 15) | 35022-053 | |
| FENDER-RR,B.ORANGE (Ref # 16) | 35022-074-88 | |
| FENDER-RR,C.BLUE (Ref # 16) | 35022-074-93 | |
| GUSSET-REAR FENDER (Ref # 17) | 35034-017 | |
| BRACKET-REAR FENDER (Ref # 18) | 35025-019 | |
| GROMMET HARNESS 10MM (Ref # 19) | 92071-010 | |
| GROMMET HARNESS 10MM (Ref # 20) | 92071-019 | |
| BOLT-UPSET 6X14 (Ref # 21) | 112B0614 | |
| COLLAR (Ref # 22) | 92027-122 | |
| BOLT-UPSET (Ref # 23) | 112G0618 | |
| WASHER 6.5X20X1.6T (Ref # 24) | 92022-125 | |
| PLATE-GROUND WIRE (Ref # 25) | 26015-001 | |
| COLLAR (Ref # 26) | 92027-103 | |
| DAMPER RUBBER (Ref # 27) | 92075-051 | |

1975 F7-D PARTS LIST

FENDERS (F7-B)

| ITEM NAME | PART NUMBER | QUANTITY |
|----------------------------------|-------------|----------|
| SCREW PAN HEAD 6X14 (Ref # 28) | 220B0614 | |
| WASHER PLAIN 6MM (Ref # 29) | 411B0600 | |
| WASHER PLAIN (Ref # 30) | 92022-024 | |
| BOLT FLANGED 8X55 (Ref # 31) | 92001-1398 | |
| SPACER FUEL TANK MONT (Ref # 32) | 92027-012 | |
| DAMPER RUBB TANK FRNT (Ref # 33) | 92075-013 | |
| WASHER,8X26X2.3 (Ref # 34) | 92022-1564 | |
| WASHER SPRING 8MM (Ref # 35) | 461F0800 | |
| NUT,8MM (Ref # 36) | 311B0800 | |
| WASHER SPRING 6MM (Ref # 37) | 461F0600 | |
| NUT 6MM (Ref # 38) | 311B0600 | |
| WASHER PLAIN 8MM (Ref # 39) | 410B0800 | |