

1978 KE175 PARTS DIAGRAM

TRANSMISSION

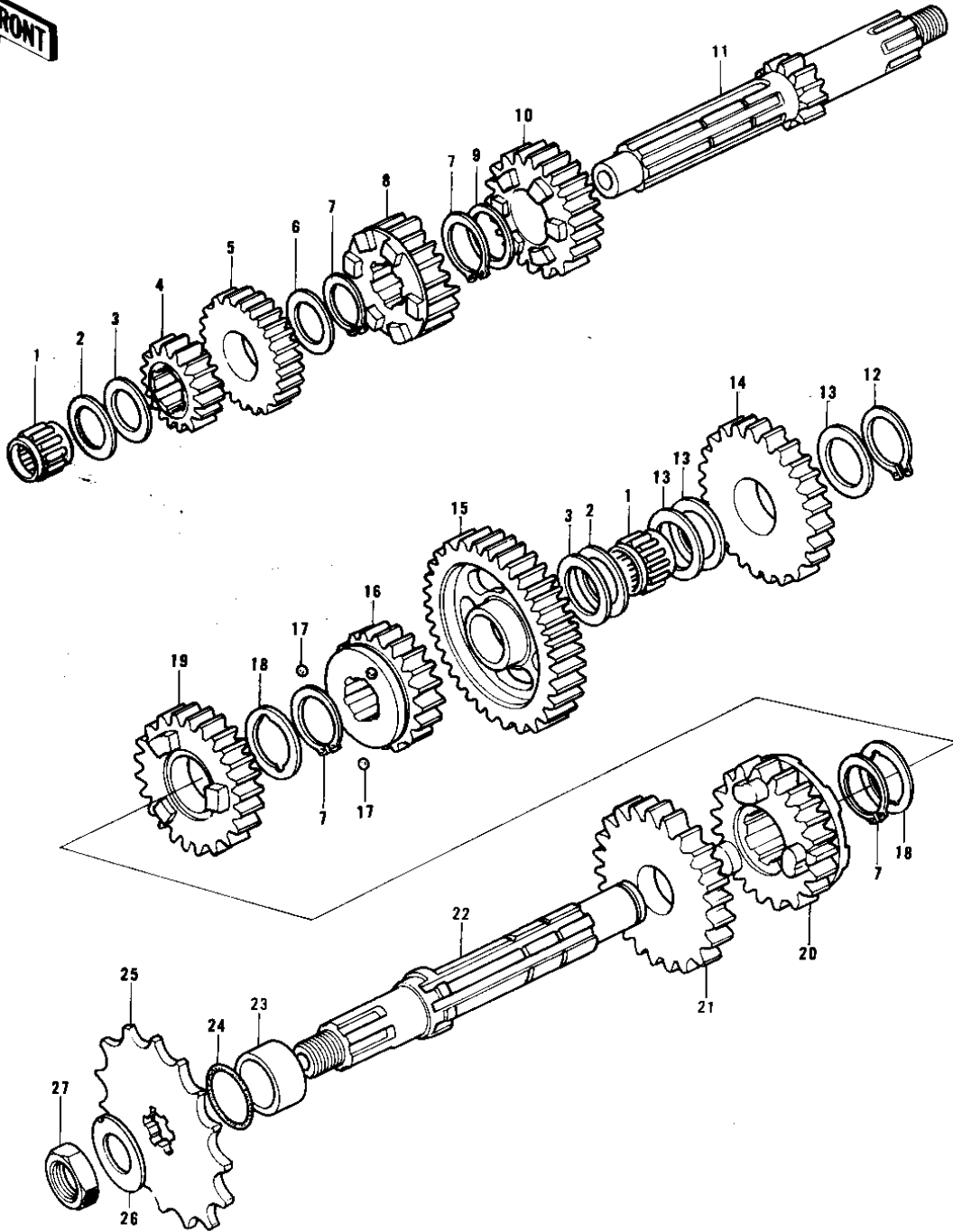

1978 KE175 PARTS LIST

TRANSMISSION

| ITEM NAME | PART NUMBER | QUANTITY |
|----------------------------------|-------------|----------|
| BEARING-NEEDLE (Ref # 1) | 92046-026 | |
| WASHER-THRUST (Ref # 2) | 92022-170 | |
| WASHER-THRUST (Ref # 3) | 92022-171 | |
| 2ND GEAR-DRIVE (Ref # 4) | 13130-024 | |
| 4TH GEAR,DRIVE (Ref # 5) | 13134-023 | |
| WASHER-PLAIN (Ref # 6) | 92022-181 | |
| CIRCLIP,21MM (Ref # 7) | 480J2100 | |
| 3RD GEAR-DRIVE (Ref # 8) | 13132-022 | |
| WASHER 22MM (Ref # 9) | 92022-106 | |
| TOP GEAR,DRIVE (Ref # 10) | 13136-052 | |
| SHAFT-DRIVE (Ref # 11) | 13127-029 | |
| CIRCLIP 15MM (Ref # 12) | 480J1500 | |
| WASHER-PLAIN (Ref # 13) | 92022-169 | |
| IDLE GEAR-KICKSTARTER (Ref # 14) | 13073-009 | |
| LOW GEAR,OUTPUT SHAFT (Ref # 15) | 13129-051 | |
| TOP GEAR,OUTER (Ref # 16) | 13137-034 | |
| BALL STEEL 5/32' (Ref # 17) | 600A0500 | |
| WASHER-LOCK (Ref # 18) | 92024-031 | |
| 3RD GEAR-OUTPUT (Ref # 19) | 13133-021 | |
| 4TH GEAR,OUTER (Ref # 20) | 13135-029 | |
| 2ND GEAR-OUTPUT (Ref # 21) | 13131-029 | |
| SHAFT-OUTPUT (Ref # 22) | 13128-028 | |
| COLLAR-ENG SPROCKET (Ref # 23) | 92027-180 | |
| "0" RING (Ref # 24) | 92055-022 | |
| SPROCKET-OUTPUT,14T (Ref # 25) | 13144-1058 | |
| SPROCKET-OUTPUT,14T (Ref # 25) | 13144-1058 | |
| ENGINE SPROCKET,13T (Ref # 25) | 13144-053 | |
| ENGINE SPROCKET,1ST (Ref # 25) | 13144-054 | |
| WASHER LOCK 12MM (Ref # 26) | 92024-002 | |