

# 1983 Duckster PARTS DIAGRAM

ENGINE COVERS ('83 KLT200-A4/A4A)

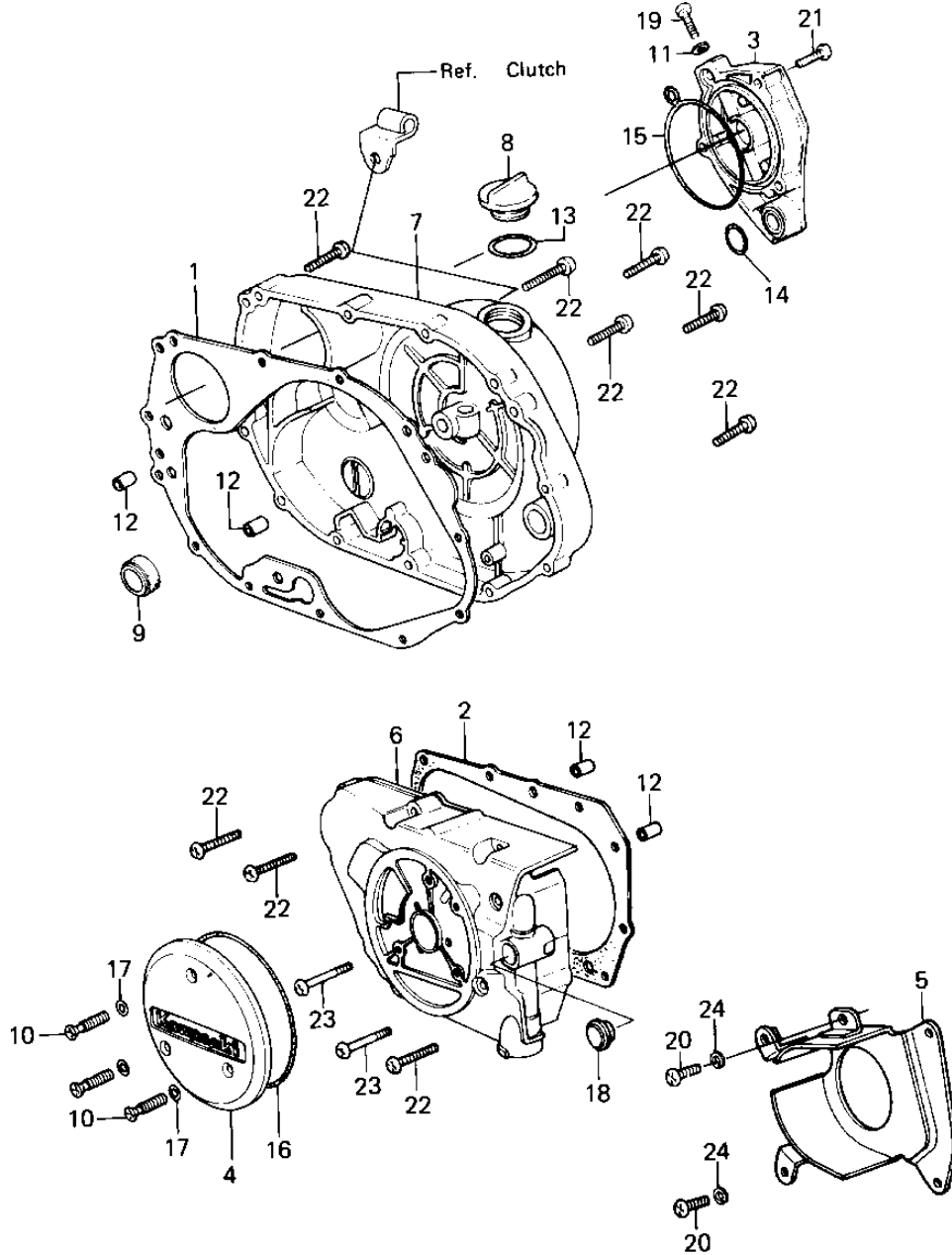

E1431-0089



# 1983 Duckster PARTS LIST

## ENGINE COVERS ('83 KLT200-A4/A4A)

ITEM NAME	PART NUMBER	QUANTITY
GASKET,ENGINE COV,RH (Ref # 1)	11009-1235	1
GASKET,L.H ENGINE COV (Ref # 2)	14045-031	1
COVER,FILTER,F.BLACK (Ref # 3)	14025-1102	1
COVER,DYNAMO (Ref # 4)	14025-1239	1
COVER-CHAIN,BLACK (Ref # 5)	14026-1052	1
COVER-GENERATOR (Ref # 6)	14031-1067	1
COVER-CLUTCH,BLACK (Ref # 7)	14032-1097	1
PLUG,OIL FILLER (Ref # 8)	16115-013	1
GAUGE,OIL LEVEL (Ref # 9)	52005-1009	1
SCREW OVL CNTSK 6X25 (Ref # 10)	222E0625	3
WASHER,PLAIN (Ref # 11)	92022-304	1
PIN-DOWEL (Ref # 12)	92042-007	4
"O" RING,31MM (Ref # 13)	92055-049	1
"O" RING (Ref # 14)	92055-098	1
"O" RING,FILTER COVER (Ref # 15)	92055-1048	1
"O" RING,DYNAMO COVER (Ref # 16)	92055-108	1
"O" RING,DYNAMO COVER (Ref # 17)	92055-109	3
PLUG (Ref # 18)	92066-065	1
BOLT HEX HEAD 6X8 (Ref # 19)	110B0608	1
SCREW PAN HEAD 6X10 (Ref # 20)	220B0610	2
SCREW PAN HEAD 6X25 (Ref # 21)	220B0625	3
SCREW PAN HEAD 6X30 (Ref # 22)	220B0630	19
SCREW PAN HEAD 6X60 (Ref # 23)	220B0660	2
WASHER SPRING 6MM (Ref # 24)	461F0600	2