

1983 Duckster PARTS DIAGRAM

REAR BRAKE/CHAIN ('83 KLT200-A4/A4A)

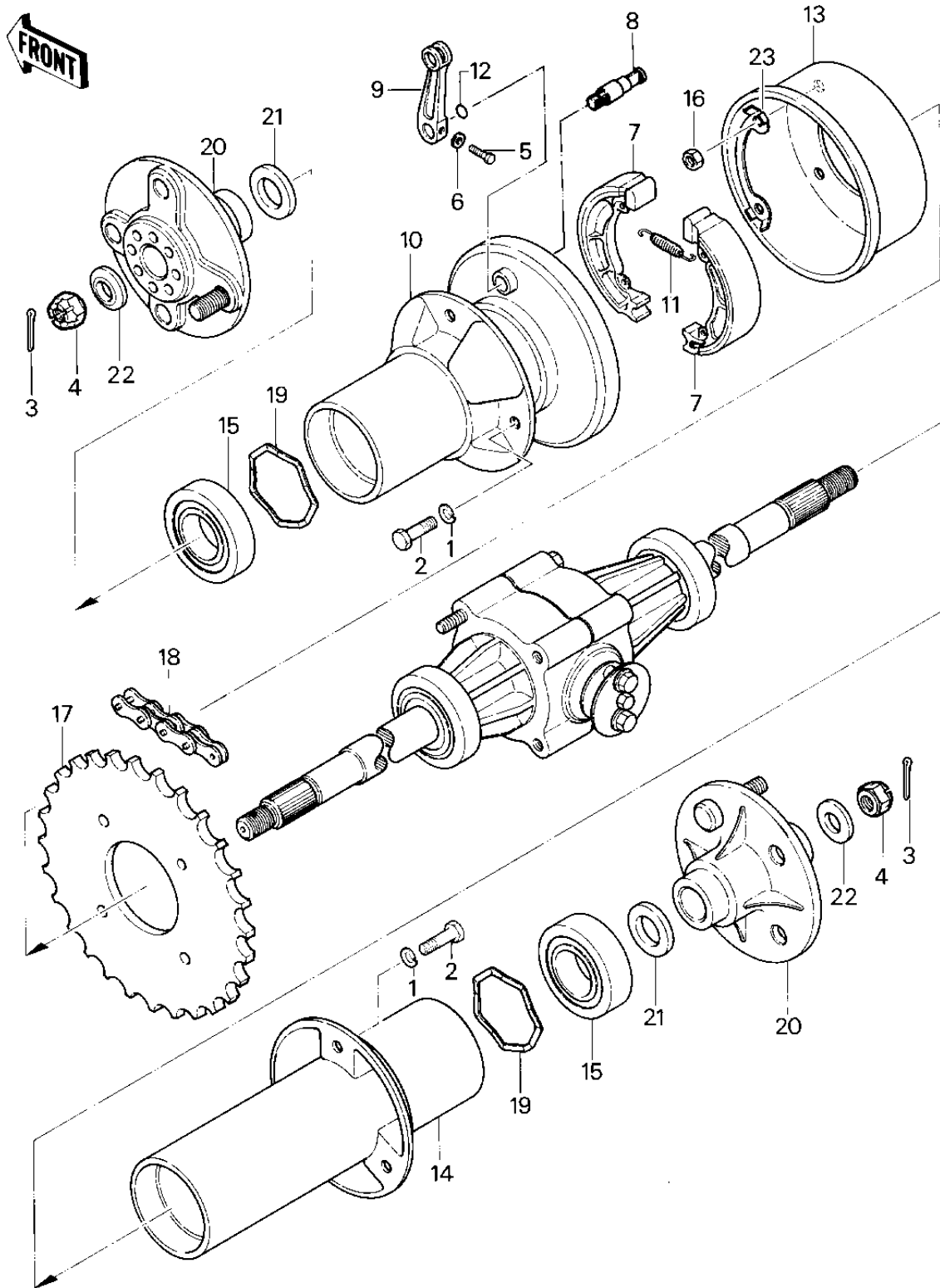

1983 Duckster PARTS LIST

REAR BRAKE/CHAIN ('83 KLT200-A4/A4A)

| ITEM NAME | PART NUMBER | QUANTITY |
|---------------------------------|-------------|----------|
| WASHER SPRING 10MM (Ref # 1) | 461F1000 | 6 |
| BOLT (Ref # 2) | 92001-160 | 6 |
| PIN COTTER 4.0X30 (Ref # 3) | 550D4030 | 2 |
| NUT (Ref # 4) | 92015-4015 | 2 |
| BOLT-UPSET (Ref # 5) | 112G0622 | 1 |
| WASHER PLAIN 6MM (Ref # 6) | 411B0600 | 1 |
| SHOE-BRAKE (Ref # 7) | 41048-1068 | 2 |
| CAM SHAFT,BRAKE (Ref # 8) | 41050-1002 | 1 |
| LEVER BRAKE CAM (Ref # 9) | 41053-1022 | 1 |
| PANEL,REAR BRAKE (Ref # 10) | 42016-4001 | 1 |
| SPRING-BRAKE SHOE (Ref # 11) | 42020-004 | 2 |
| "O" RING,15MM (Ref # 12) | 670B2015 | 1 |
| DRUM,REAR (Ref # 13) | 41038-4009 | 1 |
| HOUSING,BEARING (Ref # 14) | 41046-4001 | 1 |
| BEARING (Ref # 15) | 601A6008UU | 2 |
| NUT,10MM (Ref # 16) | 92015-1429 | 4 |
| SPROCKET-HUB,50T (Ref # 17) | 42041-4008 | 1 |
| CHAIN,EK520SH-0,98L (Ref # 18) | 92057-4011 | 1 |
| SPRING,BEARING (Ref # 19) | 92081-4013 | 2 |
| HUB (Ref # 20) | 49030-4001 | 2 |
| WASHER (Ref # 21) | 92022-4020 | 2 |
| WASHER,STEERG STM HD (Ref # 22) | 92022-230 | 2 |
| WASHER (Ref # 23) | 92022-4022 | 2 |