

# 1979 KZ200-A2 PARTS DIAGRAM

## ROCKER ARMS/VALVES

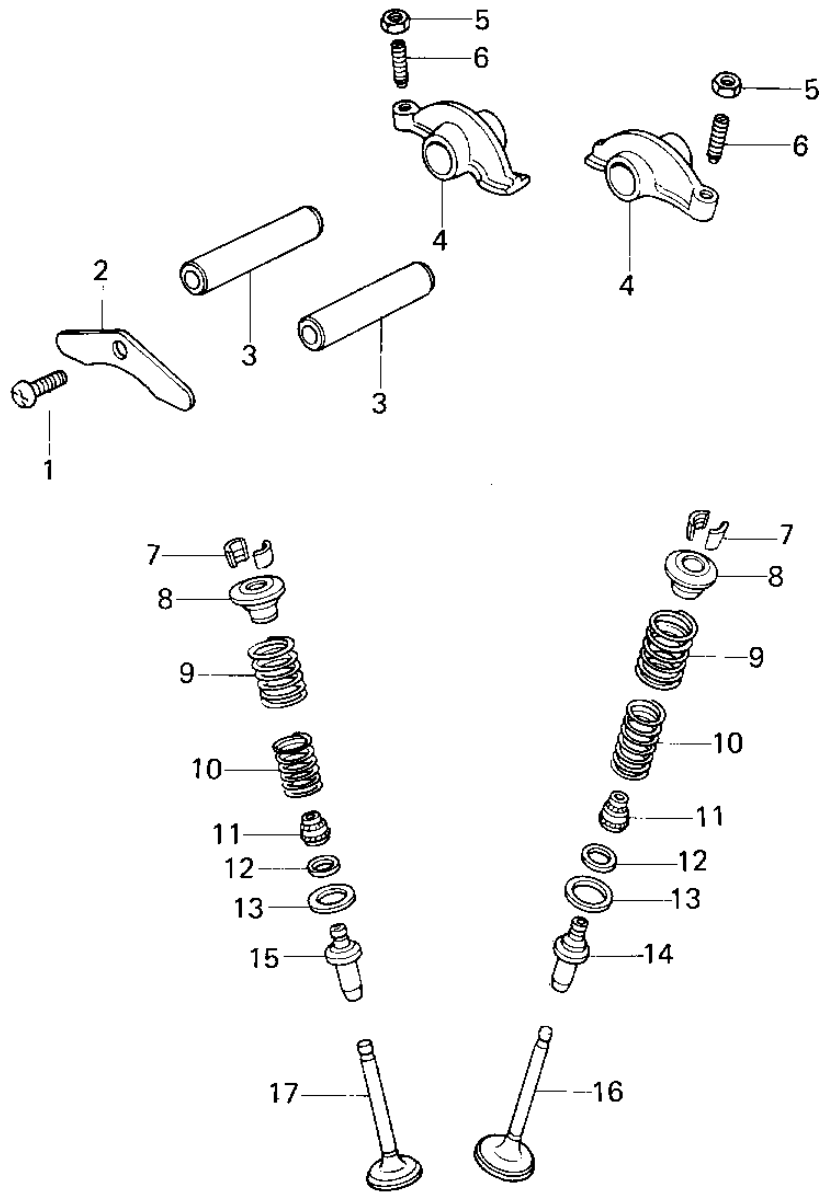

# 1979 KZ200-A2 PARTS LIST

## ROCKER ARMS/VALVES

ITEM NAME	PART NUMBER	QUANTITY
SCREW PAN HEAD 6X14 (Ref # 1)	220B0614	
PLATE,POSITIONING (Ref # 2)	14014-034	
SHAFT,ROCKER ARM (Ref # 3)	12020-004	
ARM,ROCKER (Ref # 4)	12016-012	
NUT,ROCKER ARM FITTNG (Ref # 5)	92016-061	
SCREW,SLOTTED,ROCKER (Ref # 6)	92013-009	
SPLIT KEEPER (Ref # 7)	12011-004	
RETAINER,VALVE SPRING (Ref # 8)	12009-006	
SPRING,OUTER VALVE (Ref # 9)	12007-013	
SPRING,INNER VALVE (Ref # 10)	12007-014	
OIL SEAL,RV37129.5 (Ref # 11)	92049-016	
SEAT,VLV INNER SPRING (Ref # 12)	12010-006	
SEAT,VLV OUTER SPRING (Ref # 13)	12010-005	
GUIDE,INLET VALVE (Ref # 14)	12013-003	
GUIDE,EXHAUST VALVE (Ref # 15)	49002-1010	
VALVE,INLET (Ref # 16)	12004-018	
VALVE,EXHAUST (Ref # 17)	12005-010	