

# 1972 F8-A PARTS DIAGRAM

METERS

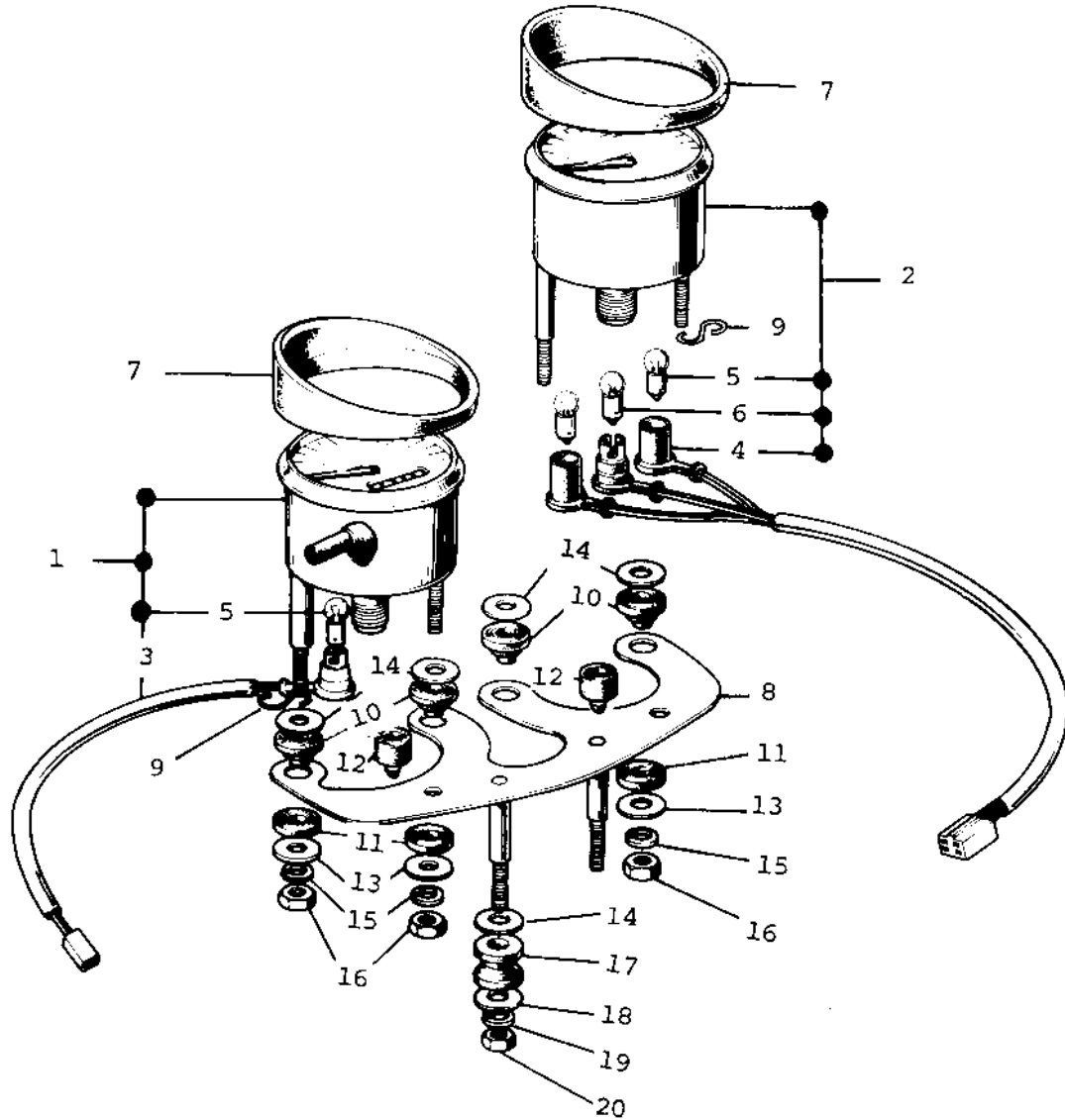

# 1972 F8-A PARTS LIST

## METERS

| ITEM NAME                        | PART NUMBER | QUANTITY |
|----------------------------------|-------------|----------|
| SPEEDOMETER ASSY,MPH (Ref # 1)   | 25001-045   | 1        |
| TACHOMETER ASSY (Ref # 2)        | 25015-009   | 1        |
| SOCKET-SPEEDOMETER (Ref # 3)     | 25011-015   | 1        |
| SOCKET-TACHOMETER (Ref # 4)      | 25011-016   | 1        |
| BULB-6V 3W (Ref # 5)             | 92069-053   | 3        |
| BULB 6V 1.5W (Ref # 6)           | 92069-024   | 1        |
| COVER-SPEEDOMETER (Ref # 7)      | 25012-003   | 2        |
| BRACKET SPEEDOMETER (Ref # 8)    | 25008-009   | 1        |
| CLAMP CABLE (Ref # 9)            | 25022-002   | 2        |
| DAMPER RUBBER (Ref # 10)         | 92075-065   | 4        |
| DAMPER RUBBER (Ref # 11)         | 92075-066   | 4        |
| DAMPER RUBB SPEEDMETR (Ref # 12) | 92075-035   | 2        |
| WASHER PL 5.5X20X1.2 (Ref # 13)  | 92022-104   | 4        |
| WASHER PLAIN 8MM (Ref # 14)      | 411B0800    | 6        |
| WASHER SPRING 5MM (Ref # 15)     | 461F0500    | 4        |
| NUT,5MM (Ref # 16)               | 311B0500    | 4        |
| DAMPER RUBB SPEEDMETR (Ref # 17) | 92075-024   | 2        |
| WASHER 6.5X20X1.6T (Ref # 18)    | 92022-125   | 2        |
| WASHER SPRING 6MM (Ref # 19)     | 461F0600    | 2        |
| NUT 6MM (Ref # 20)               | 311B0600    | 2        |