

1972 F8-A PARTS DIAGRAM

OPTIONAL PARTS

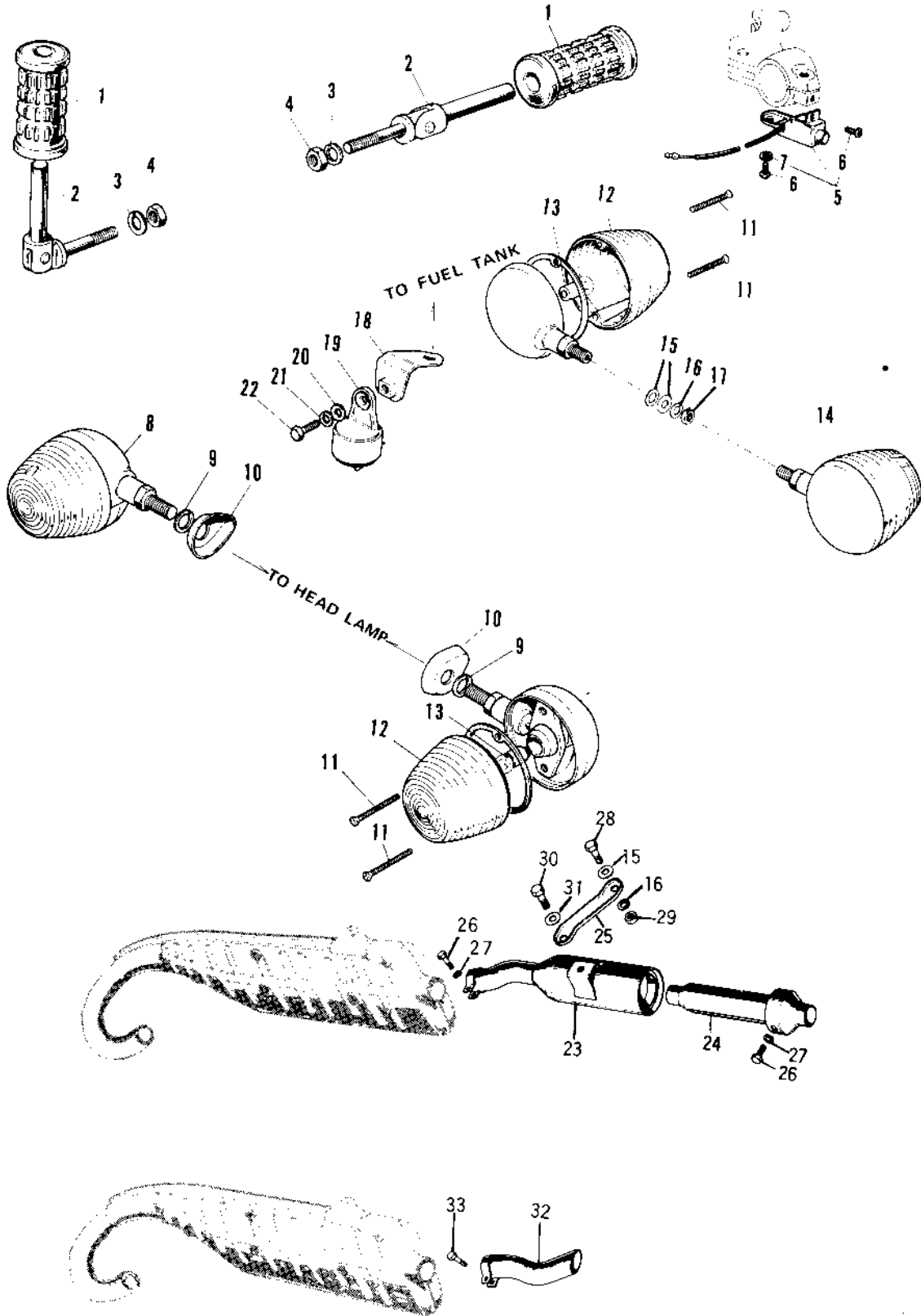

1972 F8-A PARTS LIST

OPTIONAL PARTS

ITEM NAME	PART NUMBER	QUANTITY
RUBBER REAR FOOTREST (Ref # 1)	92076-008	2
FOOTREST BAR REAR (Ref # 2)	34027-013	2
WASHER SPRING 10MM (Ref # 3)	461F1000	2
NUT,10MM (Ref # 4)	314B1000	2
SWITCH ASSY-ENG STOP (Ref # 5-7)	46027-006	1
SCREW-PAN-HEAD 3X6 (Ref # 6)	220B0306	2
WASHER SPRING 3MM (Ref # 7)	461F0300	2
LAMP-FRONT TURN SIG (Ref # 8)	23040-032	2
WASHER PLAIN 10MM (Ref # 9)	411B1000	(2
DAMPER RUBBER (Ref # 10)	92075-058	(2
SCREW OVL CNTSNK 3X15 (Ref # 11)	222B0315A	8
LENS TURN SIGNAL LAMP (Ref # 12)	23048-011	4
BULB,6V 8W (Ref # 13)	92069-042	4
LAMP-REAR TURN SIGNAL (Ref # 14)	23043-030	2
WASHER PLAIN 10MM (Ref # 15)	410B1000	5
WASHER SPRING 10MM (Ref # 16)	461F1000	3
NUT 10MM (Ref # 17)	315B1000	2
BRACKET-TRN.SGNL.RLY (Ref # 18)	27023-001	1
RELAY-TURN SIGNAL (Ref # 19)	27002-009	1
WASHER PLAIN 6MM (Ref # 20)	410B0600	1
WASHER SPRING 6MM (Ref # 21)	461F0600	1
SCREW PAN HEAD 6X16 (Ref # 22)	220B0616	1
TAIL PIECE (Ref # 23)	18048-013	1
SPARK ARRESTER COMP (Ref # 24)	18033-044	1
BRACKET-MUFFLER (Ref # 25)	18024-016	1
BOLT,6X10 (Ref # 26)	112G0610	2
WASHER LOCK 6MM (Ref # 27)	464H0600	2
BOLT-HEX HEAD,10X35 (Ref # 28)	110B1035	1
NUT 10MM (Ref # 29)	312B1000	1

1972 F8-A PARTS LIST

OPTIONAL PARTS

ITEM NAME	PART NUMBER	QUANTITY
BOLT-SMALL-UPSET,8X14 (Ref # 30)	115B0814	1
WASHER SPRING 8MM (Ref # 31)	461F0800	1
TAIL PIECE (Ref # 32)	18048-016	1
SCREW PAN HEAD 6X20 (Ref # 33)	220B0620	1