

1972 F8-A PARTS DIAGRAM

AIR CLEANER/MUFFLER (71 F81M)

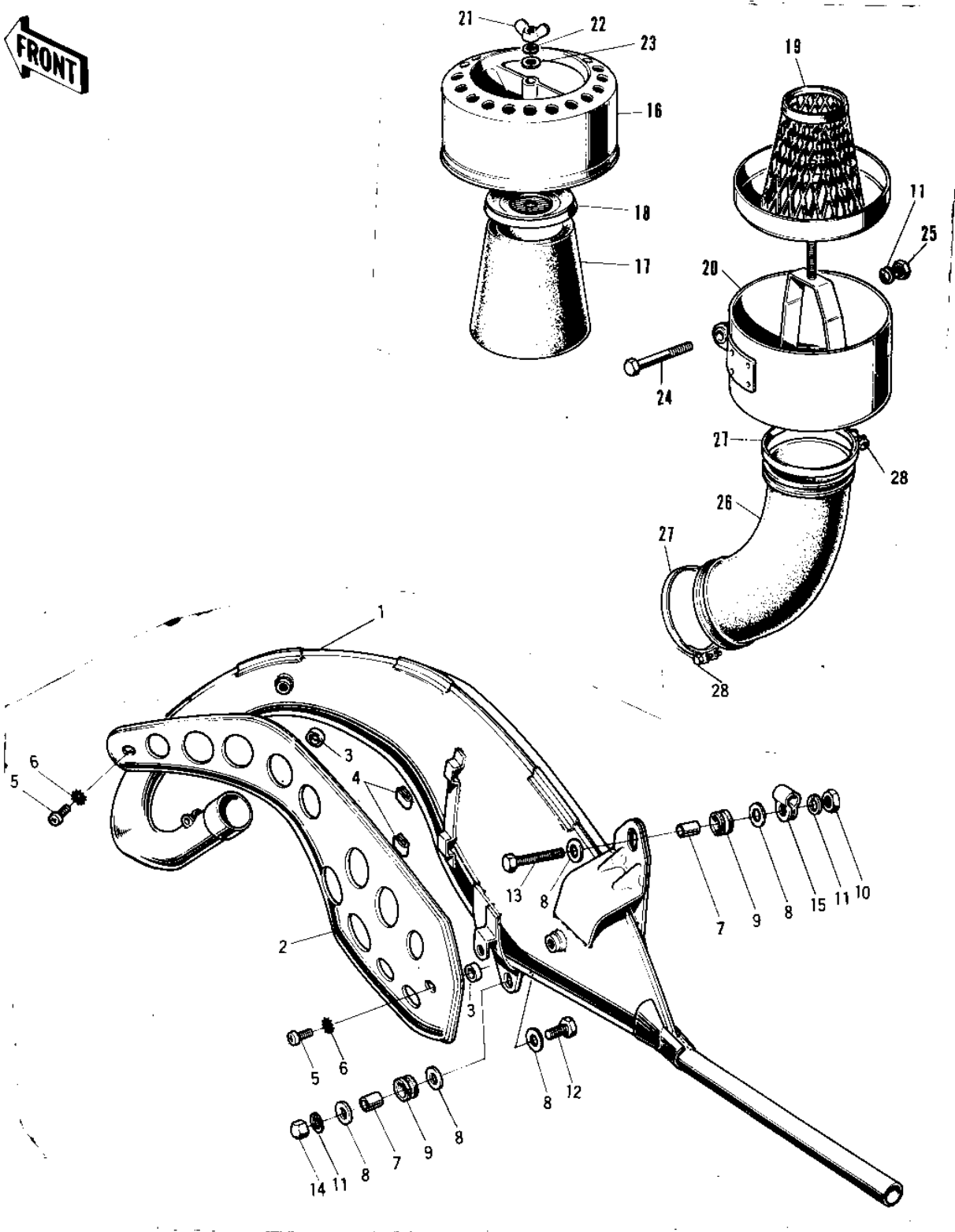

H
16

1972 F8-A PARTS LIST

AIR CLEANER/MUFFLER (71 F81M)

ITEM NAME	PART NUMBER	QUANTITY
MUFFLER ASSY (Ref # 1)	18002-068	1
COVER-MUFFLER (Ref # 2)	18064-004	1
INSULATOR HEAT (Ref # 3)	18065-002	2
INSULATOR (Ref # 4)	18065-007	2
SCREW PAN HEAD 6X10 (Ref # 5)	220E0610	2
WASHER LOCK 6MM (Ref # 6)	463H0600	2
COLLAR (Ref # 7)	92027-102	2
WASHER,8X26X2.3 (Ref # 8)	92022-1564	4
DAMPER RUBBER-MUFFLER (Ref # 9)	18063-005	2
NUT 8MM (Ref # 10)	312B0800	1
WASHER SPRING 8MM (Ref # 11)	461F0800	3
BOLT HEX HEAD 8X28 (Ref # 12)	114G0828	1
BOLT,FLANGED,8X35 (Ref # 13)	92001-1577	1
NUT FUEL TANK FRONT (Ref # 14)	92020-007	1
BRACKET,UPPER MUFFLER (Ref # 15)	32069-039	1
AIR CLEANER ASSY (Ref # 16~23)	11010-038	1
CAP-AIR CLEANER (Ref # 16)	11012-014	1
ELEMENT,AIR CLNR,MAIN (Ref # 17)	11013-021	1
ELEMENT,AIR CLNR,TOP (Ref # 18)	11013-022	1
WIRE NET-AIR CLEANER (Ref # 19)	11014-002	1
BODY-AIR CLEANER (Ref # 20)	11011-011	1
NUT-WING,6MM (Ref # 21)	92015-030	1
WASHER SPRING 6MM (Ref # 22)	461F0600	1
WASHER PLAIN 6MM (Ref # 23)	411B0600	1
BOLT,EXCLUSIVE (Ref # 24)	92001-1456	1
NUT 6MM (Ref # 25)	311B0600	1
CONNECTOR (Ref # 26)	11026-002	1
CLAMP,AIR CLEANER (Ref # 27)	92037-129	2
SCREW PAN HEAD 6X30 (Ref # 28)	220B0630	2