

1972 F8-A PARTS DIAGRAM

IGNITION

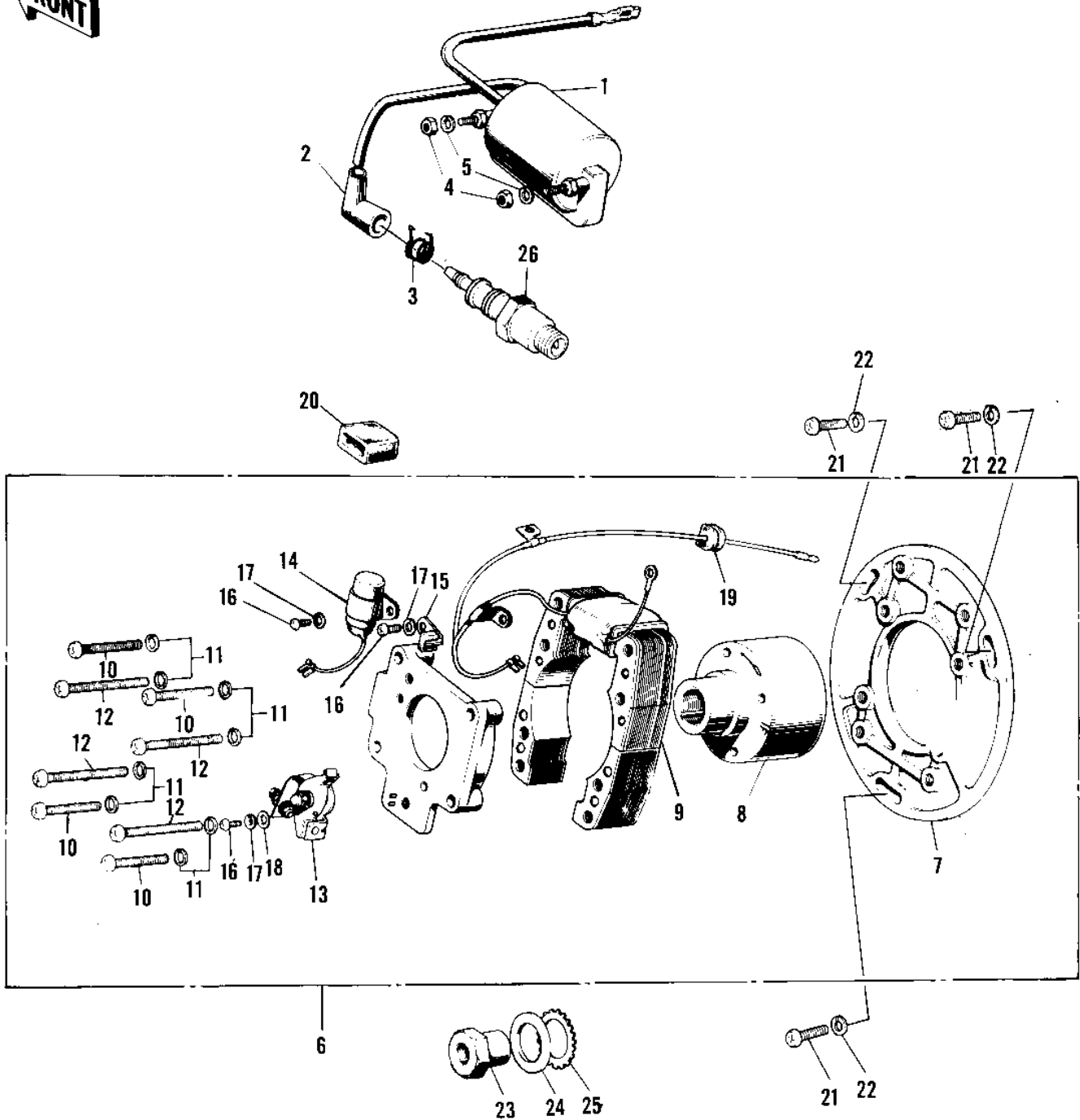

1972 F8-A PARTS LIST

IGNITION

ITEM NAME	PART NUMBER	QUANTITY
COIL-IGNITION (Ref # 1)	21121-042	1
CAP SPARK PLUG (Ref # 2)	21130-009	1
SPRING-SPARK PLUG CAP (Ref # 3)	92101-001	1
NUT 6MM (Ref # 4)	311B0600	2
WASHER SPRING 6MM (Ref # 5)	461F0600	2
MAGNETO ASSY (Ref # 6)	21002-024	1
.BASE-MAGNETO (Ref # 7)	21048-012	1
.ROTOR (Ref # 8)	21007-019	1
.COIL-PRIMARY (Ref # 9)	21049-014	1
.SCREW-PAN-CROS (Ref # 10)	220B0535	4
.WASHER SPRING 5MM (Ref # 11)	461F0500	8
.SCREW PAN HEAD 5X55 (Ref # 12)	220B0555A	4
.BREAKER-CONTACT (Ref # 13)	21008-019	1
.CONDENSER (Ref # 14)	21013-024	1
.FELT OIL (Ref # 15)	21019-005	1
FELT OIL (Ref # 15)	21019-005	1
.SCREW PAN HEAD 4X8 (Ref # 16)	21085-004	3
SCREW PAN HEAD 4X8 (Ref # 16)	220B0408	3
.WASHER SPRING 4MM (Ref # 17)	461F0400	3
.WASHER PLAIN 4MM (Ref # 18)	410B0400	1
.GROMMET WIRING HARN C (Ref # 19)	21017-005	1
GROMMET (Ref # 20)	92071-048	1
SCREW PAN HEAD 5X20 (Ref # 21)	220B0520	3
WASHER PLAIN 5MM (Ref # 22)	410B0500	3
NUT, 14MM (Ref # 23)	92015-048	1
WASHER-PLAIN,18MM (Ref # 24)	92022-184	1
WASHER LOCK 18MM (Ref # 25)	463G1800	1
SPARK PLUG B9HS (Ref # 26)	B9HS	1
SPARK PLUG B9HS (Ref # 26)	B9HS	1