

1972 F8-A PARTS DIAGRAM

HANDLEBAR (71 F81M)

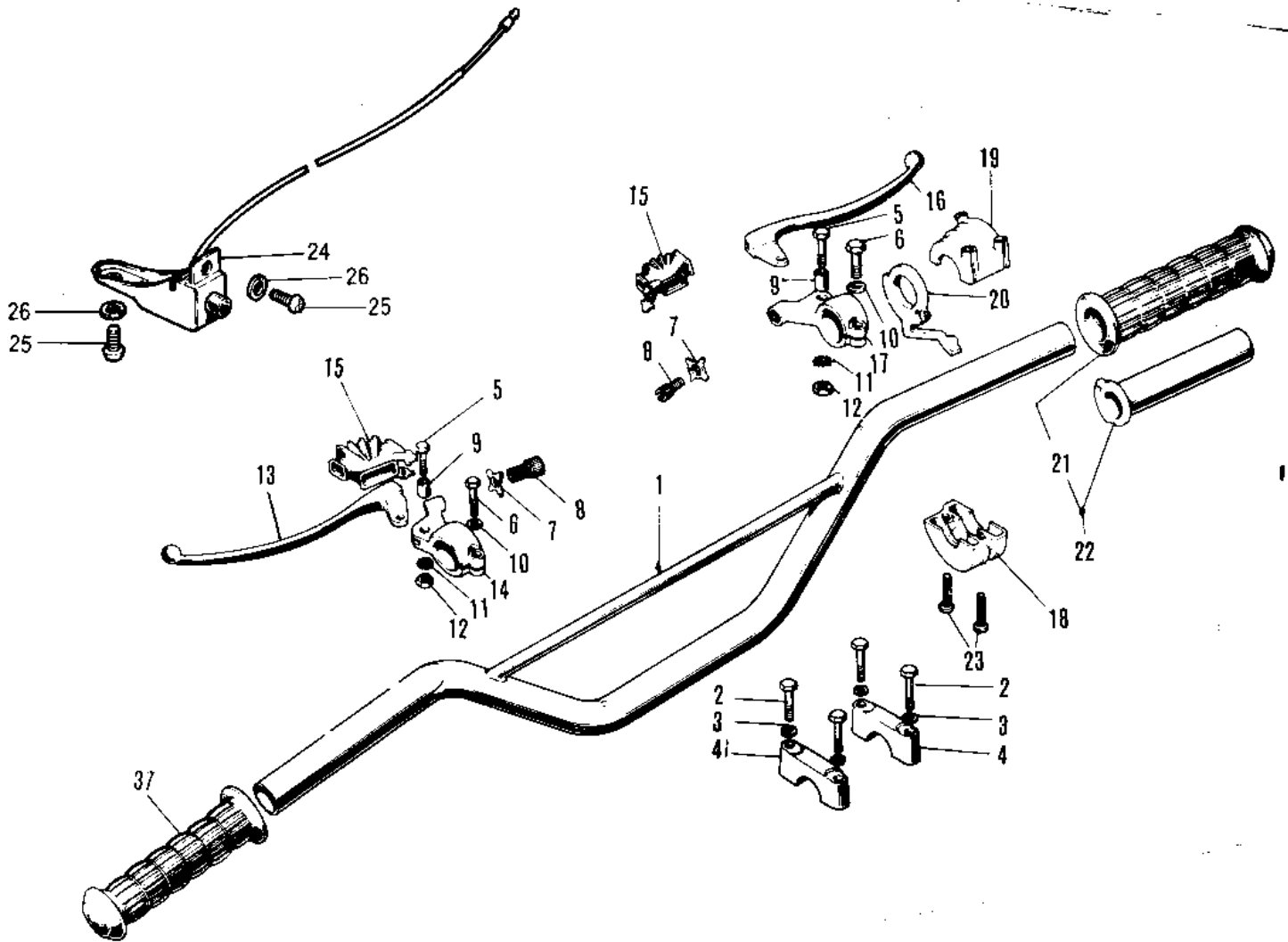

1972 F8-A PARTS LIST

HANDLEBAR ('71 F81M)

ITEM NAME	PART NUMBER	QUANTITY
HANDLEBAR (Ref # 1)	46004-017	1
BOLT HEX HEAD 8X35 (Ref # 2)	110N0835	4
WASHER SPRING 8MM (Ref # 3)	461F0800	4
HOLDER-HANDLEBAR (Ref # 4)	46012-008	2
LEVER ASSY-CLUTCH (Ref # 5~15)	46076-014	1
BOLT HEX HEAD 5X20 (Ref # 5)	92007-020	2
BOLT-UPSET (Ref # 6)	112N0620	2
NUT LOCK ADJUST SCREW (Ref # 7)	46056-001	2
SCREW CABLE ADJUST (Ref # 8)	46055-003	2
COLLAR LEVER (Ref # 9)	46059-011	2
WASHER PLAIN 6MM (Ref # 10)	410B0600	2
WASHER LOCK 5MM (Ref # 11)	464H0500	2
NUT 5MM (Ref # 12)	312B0500	2
LEVER-CLUTCH (Ref # 13)	46092-015	1
HOLDER,CLUTCH LEVER (Ref # 14)	46094-010	1
DUST COVER (Ref # 15)	46071-001	2
LEVER ASSY-FRNT BRAKE (Ref # 5~12)	46021-010	1
LEVER FRONT BRAKE (Ref # 16)	46058-004	1
HOLDER-FR BRAKE LEVER (Ref # 17)	46060-006	1
CASE ASSY-R.H (Ref # 18~23)	46018-019	1
CASE-R.H LOWER (Ref # 18)	46023-005	1
CASE-R.H.UPPER (Ref # 19)	46041-005	1
LEVER-STARTER (Ref # 20)	46096-006	1
RUBBER-R.H GRIP (Ref # 21)	46061-012	1
GRIP ASSY-THROTTLE (Ref # 22)	46019-013	1
SCREW PAN HEAD 5X22 (Ref # 23)	220B0522	2
SWITCH ASSY-ENG STOP (Ref # 24)	46027-006	1
SCREW-PAN-HEAD 3X6 (Ref # 25)	220B0306	2
WASHER SPRING 3MM (Ref # 26)	461F0300	2