

1973 F11M PARTS DIAGRAM

HANDLEBAR (F11-A)

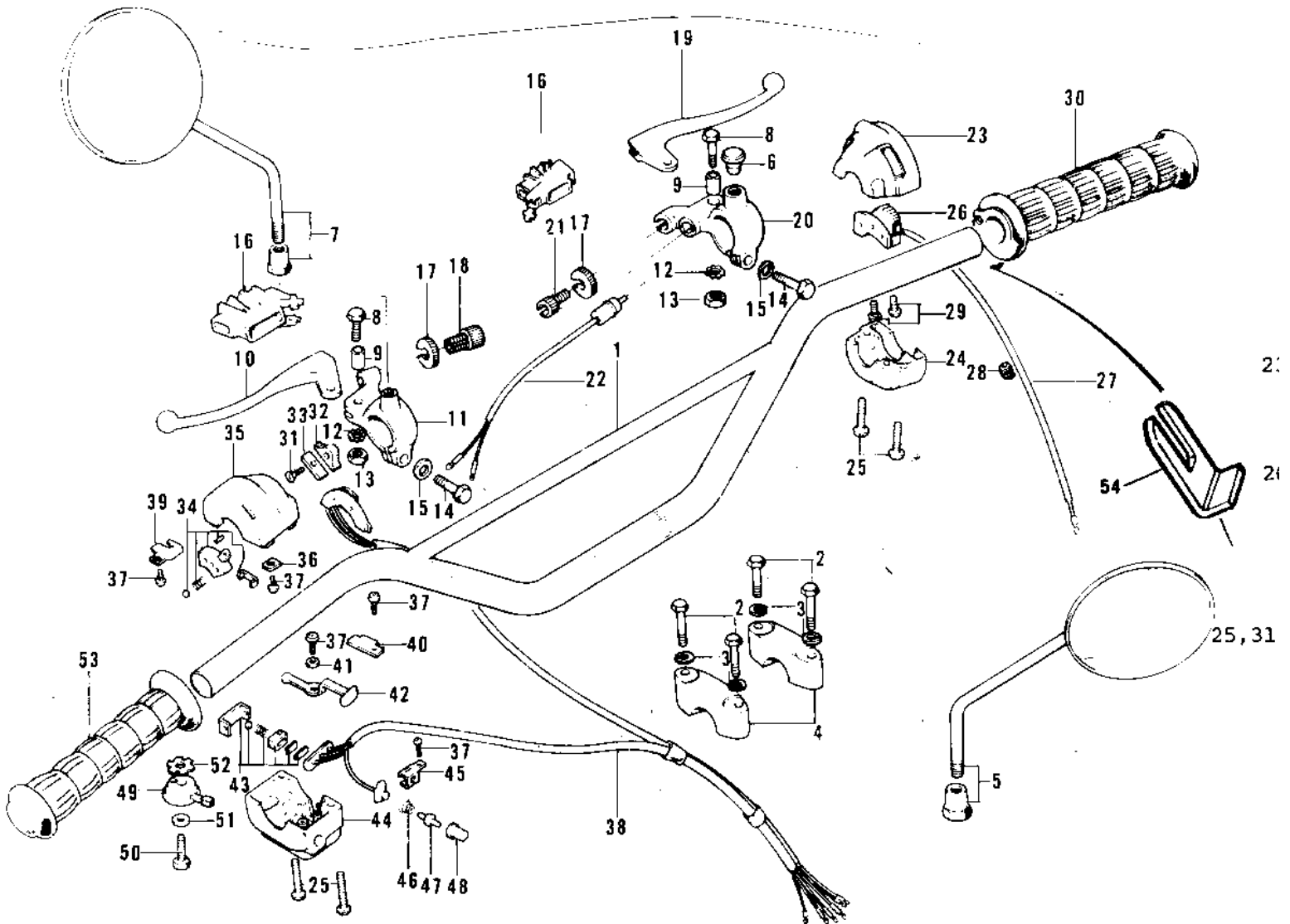

re



1973 F11M PARTS LIST

HANDLEBAR (F11-A)

| ITEM NAME | PART NUMBER | QUANTITY |
|------------------------------------|--------------|----------|
| HANDLEBAR (Ref # 1) | 46004-019 | |
| BOLT 8X38 (Ref # 2) | 92001-1405 | |
| WASHER SPRING 8MM (Ref # 3) | 461F0800 | |
| HOLDER-HANDLEBAR (Ref # 4) | 46012-008 | |
| REAR VIEW MIRROR,R.H (Ref # 5) | 56002-020 | |
| CAP-RR VIEW MIRROR (Ref # 6) | 92102-009 | |
| REAR VIEW MIRROR,L.H (Ref # 7) | 56003-009 | |
| BOLT HEX HEAD 5X20 (Ref # 8) | 92007-020 | |
| COLLAR LEVER (Ref # 9) | 46059-011 | |
| LEVER-CLUTCH (Ref # 10) | 46092-015 | |
| HOLDER-CLUTCH LEV,BL (Ref # 11) | 46094-011-21 | |
| WASHER LOCK 5MM (Ref # 12) | 464H0500 | |
| NUT 5MM (Ref # 13) | 312B0500 | |
| BOLT HEX HEAD 6X25 (Ref # 14) | 110N0625 | |
| WASHER PLAIN 6MM (Ref # 15) | 410B0600 | |
| DUST COVER (Ref # 16) | 46071-002 | |
| NUT-LOCK (Ref # 17) | 46056-005 | |
| SCREW CABLE ADJUST (Ref # 18) | 46055-003 | |
| LEVER FRONT BRAKE (Ref # 19) | 46058-004 | |
| HOLDER-FR BRK LEV,BL (Ref # 20) | 46060-009-21 | |
| SCREW,CABLE ADJUST (Ref # 21) | 46055-010 | |
| SWITCH-FR BRAKE LAMP (Ref # 22) | 27021-005 | |
| CASE ASSY-R.H,F.BLAC (Ref # 23~30) | 46018-023-21 | |
| CASE-R.H UPPER,BLACK (Ref # 23) | 46041-009-21 | |
| CASE-R.H LOWER,BLACK (Ref # 24) | 46023-009-21 | |
| SCREW PAN HEAD 5X22 (Ref # 25) | 220B0522 | |
| SWITCH ASSY-ENG STOP (Ref # 26~28) | 46027-010 | |
| SWITCH-ENGINE STOP (Ref # 26) | 46028-004 | |
| WIRING HARNESS-STP S (Ref # 27) | 46082-024 | |

1973 F11M PARTS LIST

HANDLEBAR (F11-A)

| ITEM NAME | PART NUMBER | QUANTITY |
|-------------------------------------|--------------|----------|
| GROMMET-WIRING HARNE (Ref # 28) | 92071-060 | |
| SCREW-PAN-HEAD 3X6 (Ref # 29) | 220B0306 | |
| GRIP ASSY-THROTTLE (Ref # 30) | 46019-022 | |
| CASE ASSY-L.H,F.BLAC (Ref # 25,31~) | 46091-011-21 | |
| SCREW CNTSNK HD 3X8 (Ref # 31) | 221B0308A | |
| KNOB-L.H SWITCH (Ref # 32) | 46044-011 | |
| SPRING L.H SW KNOB (Ref # 33) | 46031-003 | |
| SWITCH ASSY,L.H (Ref # 34) | 46089-012 | |
| CASE-L.H UPPER,BLACK (Ref # 35) | 46086-016-21 | |
| HOLDER-L.H SW UPPER, (Ref # 36) | 46085-019 | |
| SCREW-PAN-HEAD 3X6 (Ref # 37) | 220B0306 | |
| WIRING HARNESS-L.H S (Ref # 38) | 46082-025 | |
| HOLDER-LH SW UPPER,A (Ref # 39) | 46085-020 | |
| HOLDER-L.H SW LOWER, (Ref # 40) | 46085-016 | |
| WASHER (Ref # 41) | 92095-010 | |
| KNOB-SWITCH (Ref # 42) | 46044-012 | |
| SLIDE BLOCK AY-L.H S (Ref # 43) | 46089-007 | |
| CASE-L.H LOWER,BLACK (Ref # 44) | 46077-017-21 | |
| HOLDER-L.H SW LOWER, (Ref # 45) | 46085-017 | |
| SWITCH ASSY,HORN BUT (Ref # 46) | 27010-1009 | |
| SWITCH ASSY,HORN BUT (Ref # 47) | 27010-1009 | |
| SWITCH ASSY,HORN BUT (Ref # 48) | 27010-1009 | |
| LEVER,STARTER,BLACK (Ref # 49) | 46096-008-10 | |
| BOLT HEX HEAD 6X8 (Ref # 50) | 110B0608 | |
| BOLT-UPSET,6X8 (Ref # 50) | 112B0608 | |
| WASHER PLAIN 6MM (Ref # 51) | 410B0600 | |
| WASHER LOCK (Ref # 52) | 92095-012 | |
| RUBBER-L.H GRIP (Ref # 53) | 46075-019 | |
| HOLDER,CONTROL CABLE (Ref # 54) | 46037-023 | |