

1978 KE250-B2 PARTS DIAGRAM

FENDERS

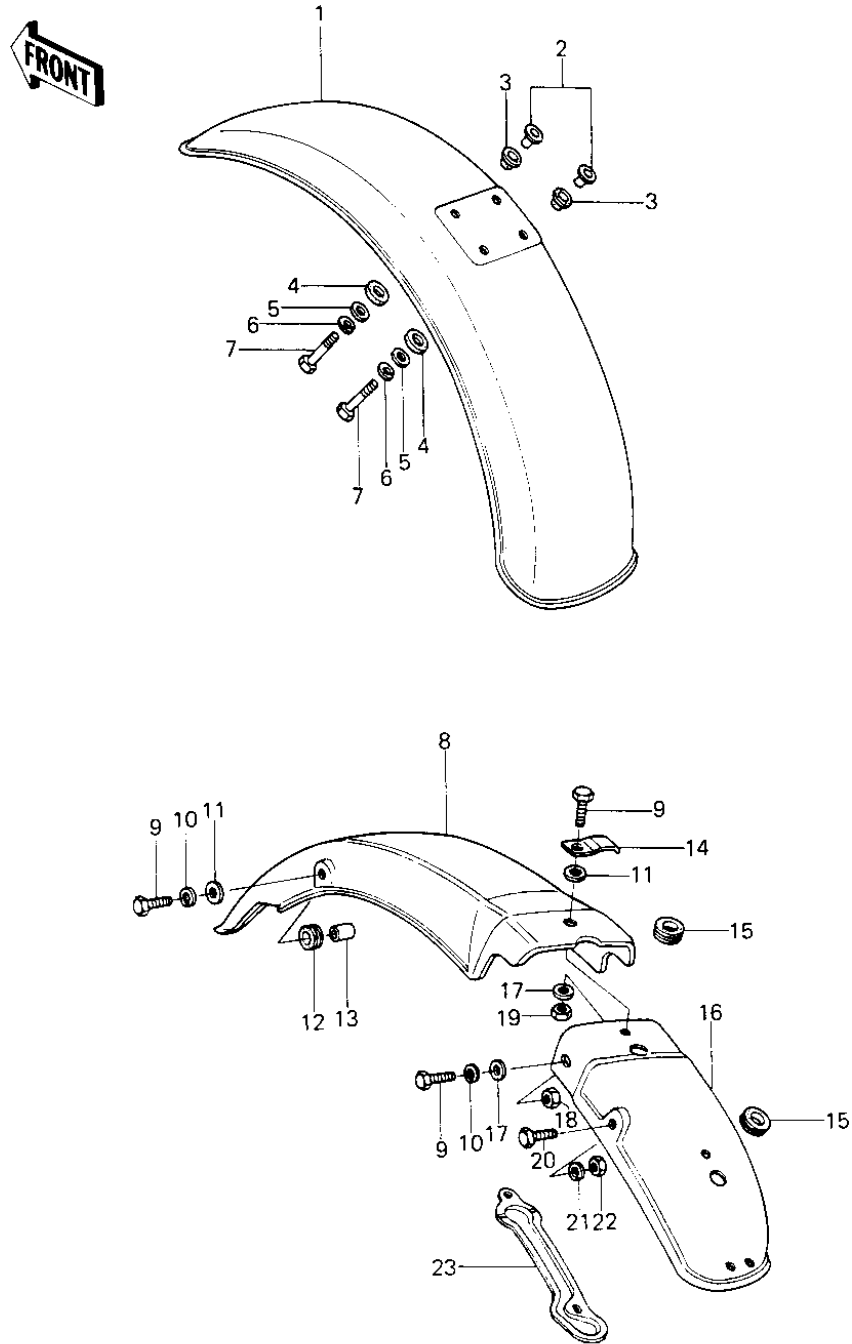

1978 KE250-B2 PARTS LIST

FENDERS

ITEM NAME	PART NUMBER	QUANTITY
FENDER-FR,SILVER (Ref # 1)	35004-107-1W	
FENDER-FR,F.RED (Ref # 1)	35004-1030-6L	
COLLAR (Ref # 2)	92027-194	
DAMPER RUBBER (Ref # 3)	92075-103	
DAMPER RUBBER,RR FEND (Ref # 4)	92075-121	
WASHER,PLAIN,7MM (Ref # 5)	92022-228	
WASHER SPRING 6MM (Ref # 6)	461F0600	
BOLT-UPSET (Ref # 7)	112G0625	
FENDER-RR (Ref # 8)	35022-158	
BOLT-UPSET (Ref # 9)	112G0618	
WASHER SPRING 6MM (Ref # 10)	461F0600	
WASHER 6.5X20X1.6T (Ref # 11)	92022-125	
DAMPER RUBBER (Ref # 12)	92075-105	
COLLAR (Ref # 13)	92027-103	
CLIP WIRING HARNESS (Ref # 14)	35024-002	
GROMMET,TL LMP WIRE (Ref # 15)	92071-079	
FENDER-RR,SILVER (Ref # 16)	35022-159-1W	
FENDER-RR,F.RED (Ref # 16)	35022-159-B1	
WASHER PLAIN 6MM (Ref # 17)	410B0600	
NUT 6MM (Ref # 18)	311B0600	
NUT,LOCK 6MM (Ref # 19)	92017-014	
BOLT 8X38 (Ref # 20)	92001-1405	
WASHER SPRING 8MM (Ref # 21)	461F0800	
NUT,8MM (Ref # 22)	311B0800	
GUIDE,REAR FENDER (Ref # 23)	35021-007	