

# 1974 Mach I PARTS DIAGRAM

## CRANKSHAFT/PISTONS

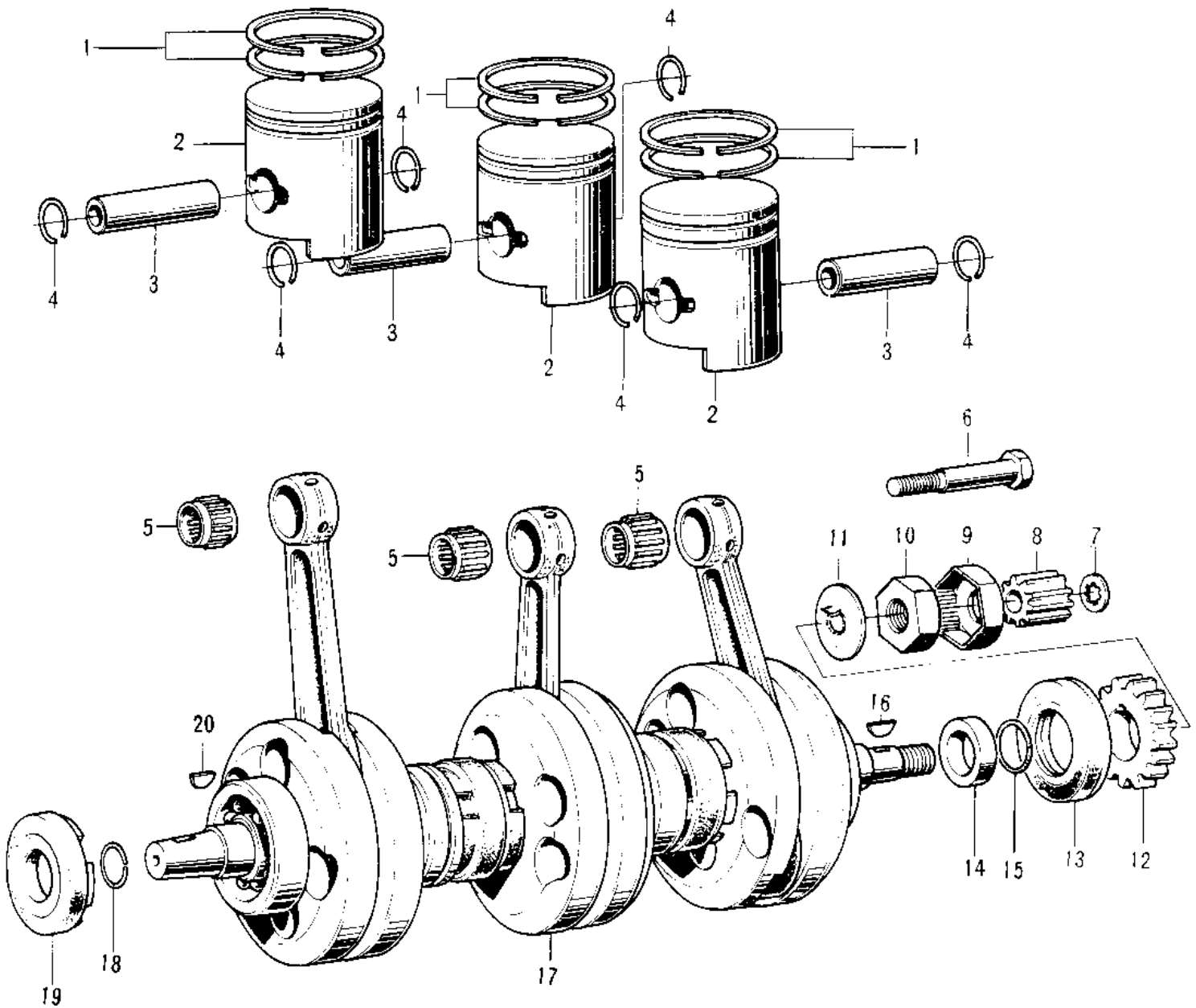

# 1974 Mach I PARTS LIST

## CRANKSHAFT/PISTONS

ITEM NAME	PART NUMBER	QUANTITY
RING SET,STD (Ref # 1)	13008-033	
RING SET,0.040'O.S (Ref # 1)	13024-041	
RING SET,0.020'O.S (Ref # 1)	13025-038	
PISTON,STD (Ref # 2)	13001-056	
PISTON,0.040'O.S (Ref # 2)	13027-055	
PISTON,0.020' O.S (Ref # 2)	13029-057	
PIN-PISTON (Ref # 3)	13002-021	
CIRCLIP PISTON PIN (Ref # 4)	92036-005	
NEEDLE BEARING SM END (Ref # 5)	13033-007	
BOLT-OIL PUMP GEAR (Ref # 6)	92003-068	
WASHER LOCK 6MM (Ref # 7)	463H0600	
PINION-OIL PUMP (Ref # 8)	16084-014	
WASHER LOCK (Ref # 9)	92024-021	
NUT 18MM (Ref # 10)	92015-019	
WASHER,LOCK,18MM (Ref # 11)	92024-067	
PINION-PRIMARY (Ref # 12)	13121-021	
OIL SEAL,TC326210 (Ref # 13)	92050-052	
COLLAR CRANK OIL SEAL (Ref # 14)	92027-031	
"0" RING,22MM (Ref # 15)	92055-018	
WOODRUFF KEY (Ref # 16)	92038-015	
CRANK CONROD ASSY (Ref # 17)	13031-1008	
CIRCLIP (Ref # 18)	92036-013	
OIL SEAL TCY256210 (Ref # 19)	92050-041	
WOODRUFF KEY (Ref # 20)	92038-001	