

# 1974 Mach I PARTS DIAGRAM

FRAME/FRAME FITTINGS (S1-A)

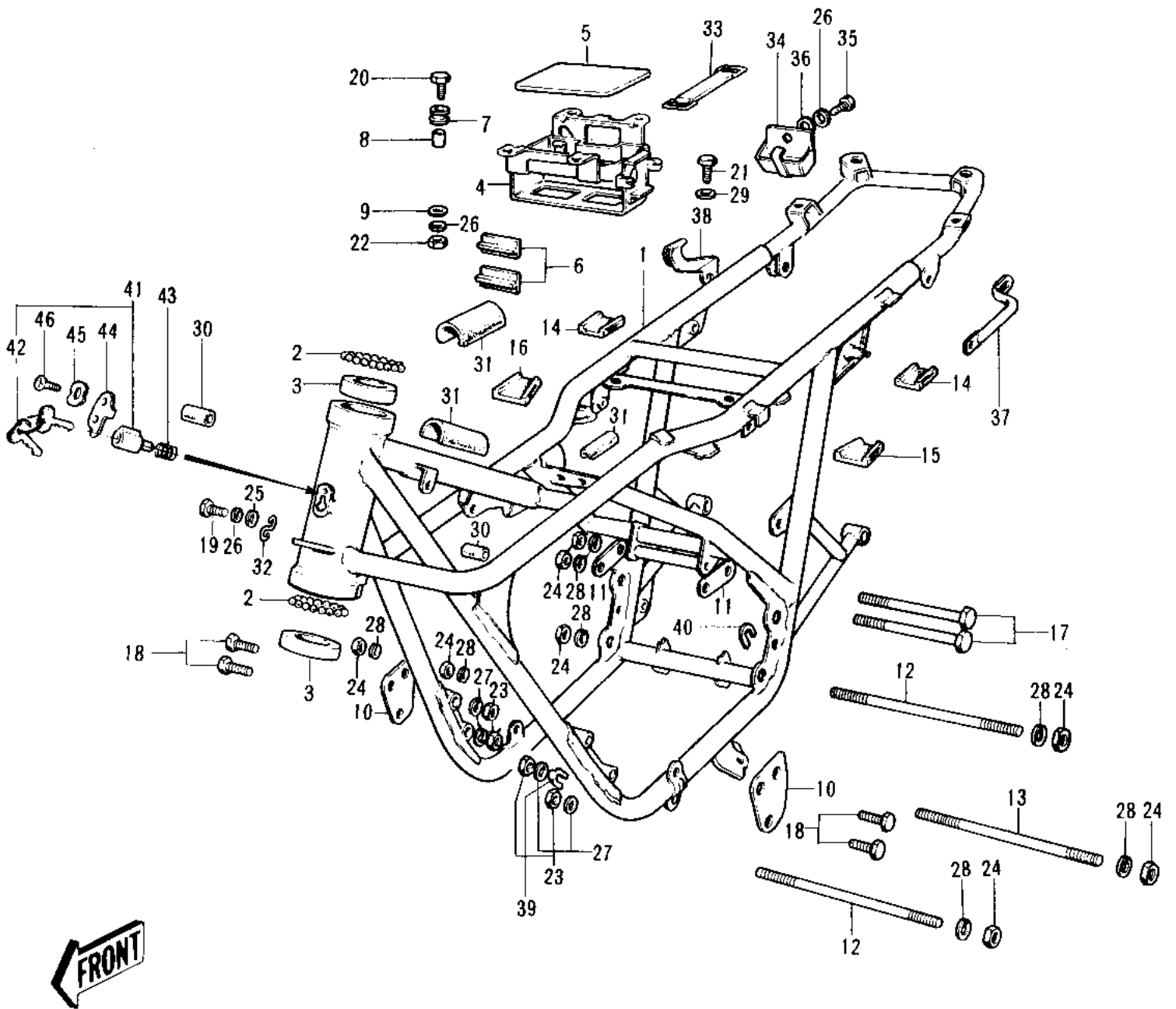

# 1974 Mach I PARTS LIST

## FRAME/FRAME FITTINGS (S1-A)

ITEM NAME	PART NUMBER	QUANTITY
FRAME (Ref # 1)	32002-061	
BALL STEEL 1/4' (Ref # 2)	600A0800	
RACE STRNG STEM BERNG (Ref # 3)	92048-006	
CASE-BATTERY (Ref # 4)	32099-008	
MAT BATTERY (Ref # 5)	32103-006	
SEAT RECTIFIER RUBBER (Ref # 6)	32103-003	
DAMPER RUBBER (Ref # 7)	92075-076	
COLLAR,6.8X10X8.5 (Ref # 8)	92027-129	
WASHER 6.5X20X1.6T (Ref # 9)	92022-125	
PLATE-ENGINE MOUNT (Ref # 10)	32030-022	
PLATE-ENGINE MOUNT (Ref # 11)	32030-023	
BOLT,10X237 (Ref # 12)	92003-182	
BOLT,10X225 (Ref # 13)	92003-181	
RUBBER PAD (Ref # 14)	31082-007	
RUBBER PAD (Ref # 15)	31082-008	
RUBBER PAD (Ref # 16)	31082-009	
BOLT, FLANGED, 10X110 (Ref # 17)	92001-1602	
BOLT,10X45 (Ref # 18)	92001-1182	
BOLT-UPSET,6X12 (Ref # 19)	112G0612	
BOLT 6X22 (Ref # 20)	112B0622	
SCREW PAN HEAD 6X14 (Ref # 21)	220B0614	
NUT 6MM (Ref # 22)	311B0600	
NUT,8MM (Ref # 23)	311B0800	
NUT,10MM (Ref # 24)	314B1000	
WASHER PLAIN 6MM (Ref # 25)	410B0600	
WASHER SPRING 6MM (Ref # 26)	461F0600	
WASHER SPRING 8MM (Ref # 27)	461F0800	
WASHER SPRING 10MM (Ref # 28)	461F1000	
WASHER LOCK 6MM (Ref # 29)	464H0600	

# 1974 Mach I PARTS LIST

## FRAME/FRAME FITTINGS (S1-A)

ITEM NAME	PART NUMBER	QUANTITY
DAMPER RUBBER (Ref # 30)	92075-044	
MAT FUEL TANK (Ref # 31)	51067-002	
CLAMP (Ref # 32)	92037-108	
GROMMET HARNESS 22MM (Ref # 33)	92071-012	
COVER-SPARK PLUG (Ref # 34)	32132-001	
BOLT-UPSET 6X14 (Ref # 35)	112B0614	
WASHER PLAIN (Ref # 36)	92022-024	
FRAME GRIP (Ref # 37)	32109-013	
BRACKET-HELMET HOLDER (Ref # 38)	32122-006	
SHIM-ENG FIT RR,0.5MM (Ref # 39)	92025-048	
SHIM-ENG FIT RR,0.8MM (Ref # 39)	92025-049	
SHIM-ENG FIT RR,1.0MM (Ref # 39)	92025-050	
SHIM-ENG FIT RR,1.6MM (Ref # 39)	92025-051	
SHIM-ENG FIT RR,2.0MM (Ref # 39)	92025-052	
SHIM-ENG FIT FR,0.5MM (Ref # 40)	92025-053	
SHIM-ENG FIT FR,0.8MM (Ref # 40)	92025-054	
SHIM-ENG FIT FR,1.0MM (Ref # 40)	92025-055	
SHIM-ENG FIT FR,1.6MM (Ref # 40)	92025-056	
SHIM-ENG FIT FR,2.0MM (Ref # 40)	92025-057	
SHIM-ENG FIT FR,2.3MM (Ref # 40)	92025-058	
LOCK ASSY-STEERING (Ref # 41)	27016-030	
KEY SET,#265 (Ref # 42)	27018-016-65	
KEY SET,#279 (Ref # 42)	27018-016-79	
SPRING-STEERING LOCK (Ref # 43)	27032-001	
CAP,STEERING LOCK (Ref # 44)	11012-1134	
WASHER (Ref # 45)	92097-003	
SCREW-TAPPING (Ref # 46)	92008-007	