

1973 Mach I PARTS DIAGRAM

FRAME/FRAME FITTINGS (S1-B/C,KH250-A5)

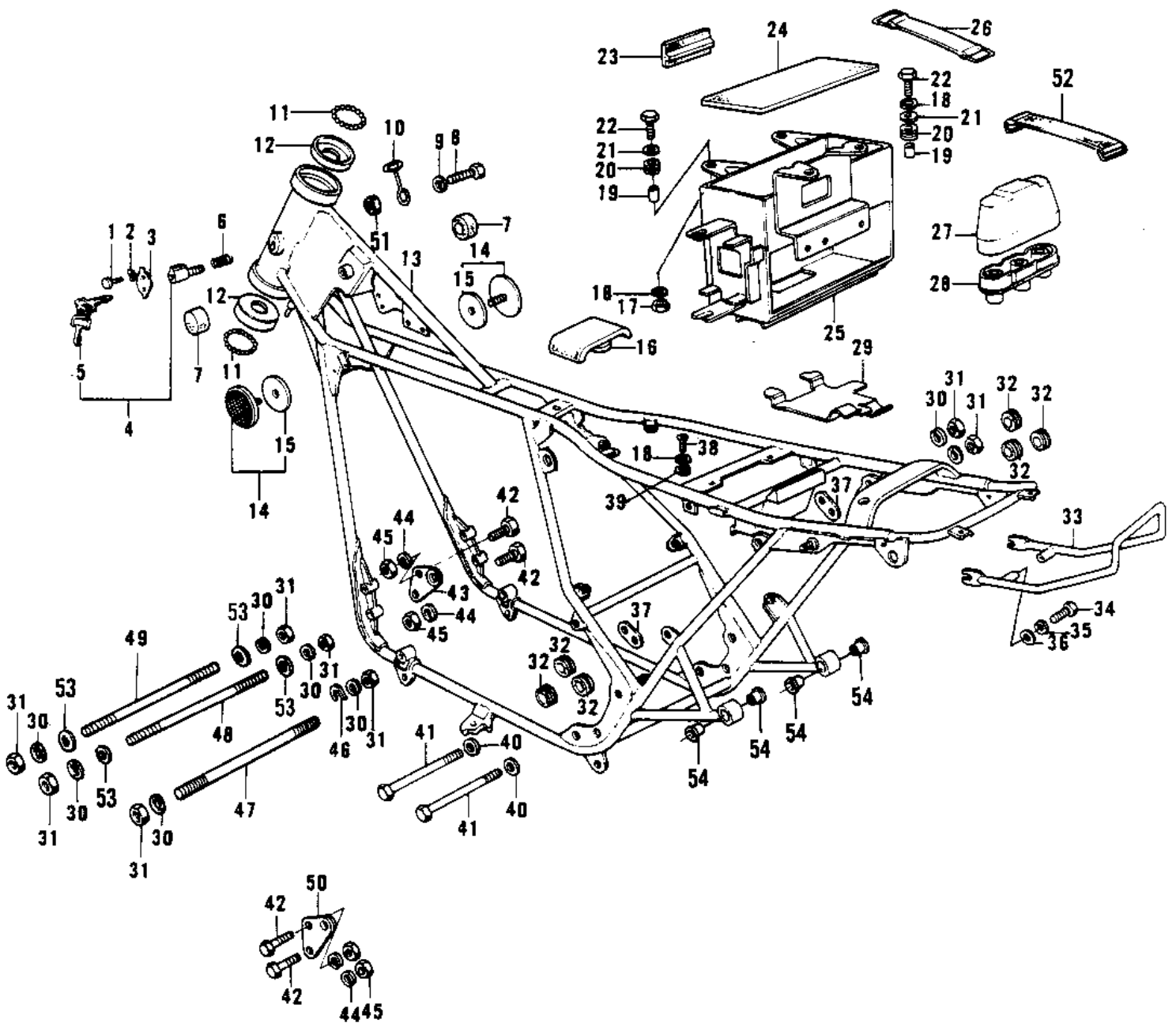

1973 Mach I PARTS LIST

FRAME/FRAME FITTINGS (S1-B/C,KH250-A5)

ITEM NAME	PART NUMBER	QUANTITY
SCREW-TAPPING (Ref # 1)	92008-007	1
WASHER (Ref # 2)	92097-003	1
CAP,STEERING LOCK (Ref # 3)	11012-1134	1
LOCK ASSY,STEERING (Ref # 4)	27016-038	1
KEY SET,#901 (Ref # 5)	27008-055-01	AR
KEY SET,#910 (Ref # 5)	27008-055-10	AR
SPRING-STEERING LOCK (Ref # 6)	27032-001	1
DAMPER RUBBER-FL TANK (Ref # 7)	92075-101	2
BOLT HEX HEAD 8X16 (Ref # 8)	110N0816	1
BOLT-UPSET,6X12 (Ref # 8)	112G0612	1
WASHER SPRING 8MM (Ref # 9)	461F0800	1
WASHER SPRING 6MM (Ref # 9)	461F0600	1
CLAMP,CABLE (Ref # 10)	92037-124	1
CLAMP,CABLE (Ref # 10)	92037-139	1
CLAMP (Ref # 10)	92037-108	1
BALL STEEL 1/4' (Ref # 11)	600A0800	38
RACE STRNG STEM BERNG (Ref # 12)	92048-006	2
FRAME (Ref # 13)	32002-077	1
FRAME (Ref # 13)	32002-129	1
UNAVAILABLE IN PRICE BOOK (Ref # 13)	32003-133	1
REFLECTOR,REFLEX (Ref # 14)	28001-026	2
DAMPER RUBBER,REFLECT (Ref # 15)	92094-011	2
DAMPER RUBBER,FL TANK (Ref # 16)	92075-214	1
NUT 6MM (Ref # 17)	311B0600	2
WASHER SPRING 6MM (Ref # 18)	461F0600	5
COLLAR,6.8X10X8.5 (Ref # 19)	92027-129	4
DAMPER RUBBER (Ref # 20)	92075-076	4
WASHER 6.5X20X1.6T (Ref # 21)	92022-125	4
BOLT 6X22 (Ref # 22)	112B0622	4

1973 Mach I PARTS LIST

FRAME/FRAME FITTINGS (S1-B/C,KH250-A5)

ITEM NAME	PART NUMBER	QUANTITY
SEAT RECTIFIER RUBBER (Ref # 23)	32103-003	2
SEAT RECTIFIER RUBBER (Ref # 23)	32103-003	1
MAT BATTERY (Ref # 24)	32103-006	1
CASE,BATTERY (Ref # 25)	32097-031	1
CASE,BATTERY (Ref # 25)	32097-037	1
BAND,OIL TANK (Ref # 26)	92072-045	1
COVER-SPARK PLUG (Ref # 27)	32132-003	1
HOLDER-SPARK PLUG COV (Ref # 28)	32132-002	1
BRACKET,FUSE CASE (Ref # 29)	32116-004	1
WASHER,SPRING,10MM (Ref # 30)	461F1000	8
NUT,10MM (Ref # 31)	314B1000	8
GROMMET (Ref # 32)	92071-056	6
STAY,REAR FENDER (Ref # 33)	35032-028	6
BOLT,8X20 (Ref # 34)	115G0820	1
WASHER SPRING 8MM (Ref # 35)	461F0800	3
WASHER SPRING 8MM (Ref # 35)	461F0800	2
WASHER PLAIN 8MM (Ref # 36)	411B0800	3
WASHER PLAIN 8MM (Ref # 36)	411B0800	2
PLATE-ENGINE MOUNT (Ref # 37)	32030-023	2
SCREW PAN HEAD 6X14 (Ref # 38)	220B0614	1
SCREW PAN HEAD 6X14 (Ref # 38)	220B0614	1
WASHER LOCK 6MM (Ref # 39)	464H0600	1
WASHER,PLAIN,10MM (Ref # 40)	92022-265	2
BOLT, FLANGED, 10X110 (Ref # 41)	92001-1602	2
BOLT,10X45 (Ref # 42)	92001-1182	4
PLATE,ENGINE MOUNT,FR (Ref # 43)	32030-030	1
PLATE,L.H ENG MOUNT (Ref # 43)	32030-033	1
PLATE,R.H ENG MOUNT (Ref # 43)	32030-032	1
WASHER SPRING 8MM (Ref # 44)	461F0800	4