

1973 Mach I PARTS DIAGRAM

FENDERS (S1-A/B/C)

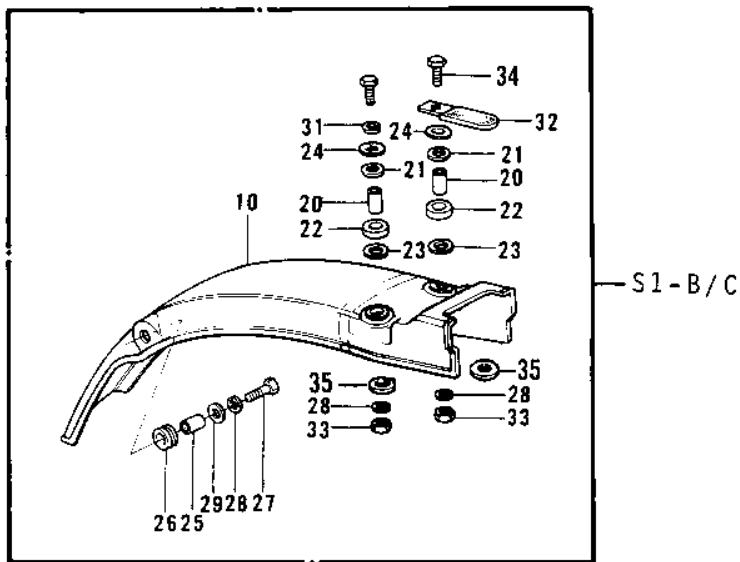
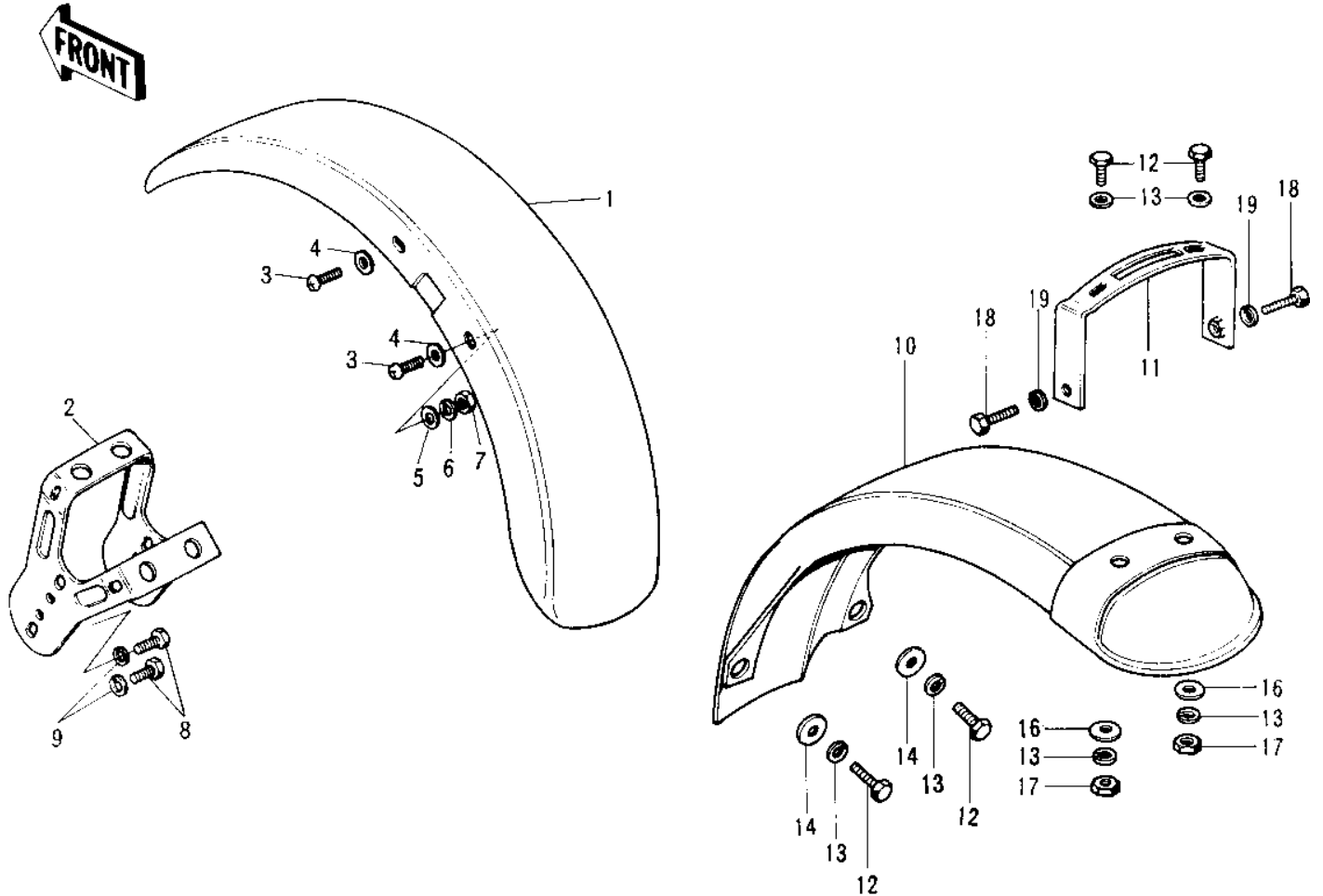

1973 Mach I PARTS LIST

FENDERS (S1-A/B/C)

ITEM NAME	PART NUMBER	QUANTITY
FENDER-FR (Ref # 1)	35004-075	1
FENDER-FR (Ref # 1)	35004-084	1
BRACE,FRONT FENDER (Ref # 2)	35009-026	1
BRACE,FRONT FENDER (Ref # 2)	35009-030	1
SCREW PAN HEAD 6X14 (Ref # 3)	220E0614	4
WASHER-PLAIN (Ref # 4)	92022-193	4
WASHER PLAIN 6MM (Ref # 5)	411B0600	4
WASHER SPRING 6MM (Ref # 6)	461F0600	4
NUT 6MM (Ref # 7)	311B0600	4
BOLT HEX HEAD 8X16 (Ref # 8)	116B0816	4
WASHER SPRING 8MM (Ref # 9)	461F0800	4
FENDER-RR (Ref # 10)	35022-056	1
FENDER-RR (Ref # 10-1)	35022-099	1
BRACKET-REAR FENDER (Ref # 11)	35025-021	1
BOLT-UPSET,6X16 (Ref # 12)	112G0616	4
WASHER SPRING 6MM (Ref # 13)	461F0600	4
COLLAR (Ref # 14)	92027-122	2
WASHER 6.5X20X1.6T (Ref # 15)	92022-125	2
WASHER PLAIN 6MM (Ref # 16)	411B0600	2
NUT 6MM (Ref # 17)	311B0600	2
BOLT,HEX HEAD,10X25 (Ref # 18)	113N1025	2
WASHER SPRING 10MM (Ref # 19)	461F1000	2
COLLAR,REAR FENDER (Ref # 20)	92027-162	2
DAMPER RUBBER,RR FEND (Ref # 21)	92075-121	2
DAMPER RUBBER,RR FEND (Ref # 22)	92075-133	2
WASHER,PLAIN,7MM (Ref # 23)	92022-227	2
WASHER,PLAIN,7MM (Ref # 24)	92022-228	2
COLLAR (Ref # 25)	92027-103	2
DAMPER RUBBER (Ref # 26)	92075-105	2