

# 1980 KLX250 PARTS DIAGRAM

## TRANSMISSION

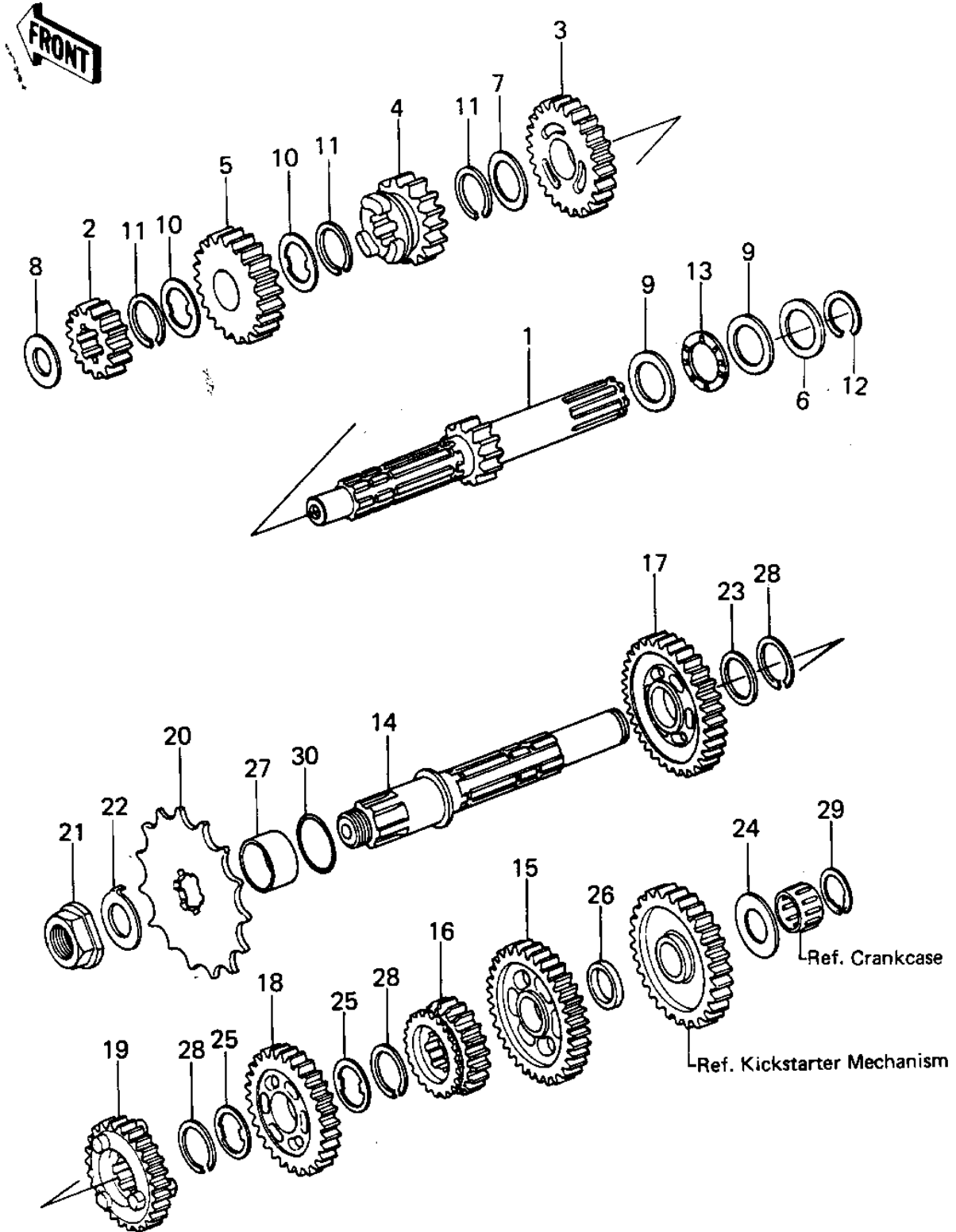

# 1980 KLX250 PARTS LIST

## TRANSMISSION

ITEM NAME	PART NUMBER	QUANTITY
SHAFT,DRIVE (Ref # 1)	13127-053	
2ND GEAR,DRIVE SHAFT (Ref # 2)	13129-1022	
TOP GEAR,DRV SHFT,24T (Ref # 3)	13129-1050	
GEAR,INPUT,3RD,20T (Ref # 4)	13129-1284	
4TH GEAR,DRIVE SHAFT (Ref # 5)	13134-026	
WASHER THRUST (Ref # 6)	92022-112	
WASHER-PLAIN (Ref # 7)	92022-198	
WASHER,THRUST,15MM (Ref # 8)	92022-279	
WASHER,PLAIN (Ref # 9)	92022-314	
WASHER-LOCK (Ref # 10)	92024-039	
CIRCLIP,25MM (Ref # 11)	92033-025	
CIRCLIP,18MM (Ref # 12)	92033-029	
BRG,NEEDLE,AXK1104 (Ref # 13)	92046-052	
SHAFT,OUTPUT (Ref # 14)	13128-1007	
LOW GEAR,OUTPUT SHAFT (Ref # 15)	13129-058	
TOP GEAR,OUT SHFT,21T (Ref # 16)	13129-1051	
2ND GEAR,OUTPUT 26T (Ref # 17)	13131-044	
3RD GEAR,OUTPUT SHAFT (Ref # 18)	13133-044	
GEAR,OUTPUT 4TH,21T (Ref # 19)	13129-1285	
ENGINE SPROCKET,14T (Ref # 20)	13144-1005	
ENGINE SPROCKET,13T (Ref # 20)	13144-1027	
ENGINE SPROCKET,15T (Ref # 20)	13144-069	
NUT,LOCK,16M/M (Ref # 21)	92015-1013	
WASHER,LOCK (Ref # 22)	92022-1017	
WASHER-PLAIN (Ref # 23)	92022-198	
WASHER,PLAIN (Ref # 24)	92022-270	
WASHER-LOCK (Ref # 25)	92024-039	
SPACER (Ref # 26)	92026-114	
COLLAR,ENGINE SPROCKT (Ref # 27)	92027-287	