

1979 KLX250 PARTS DIAGRAM

FUEL TANK

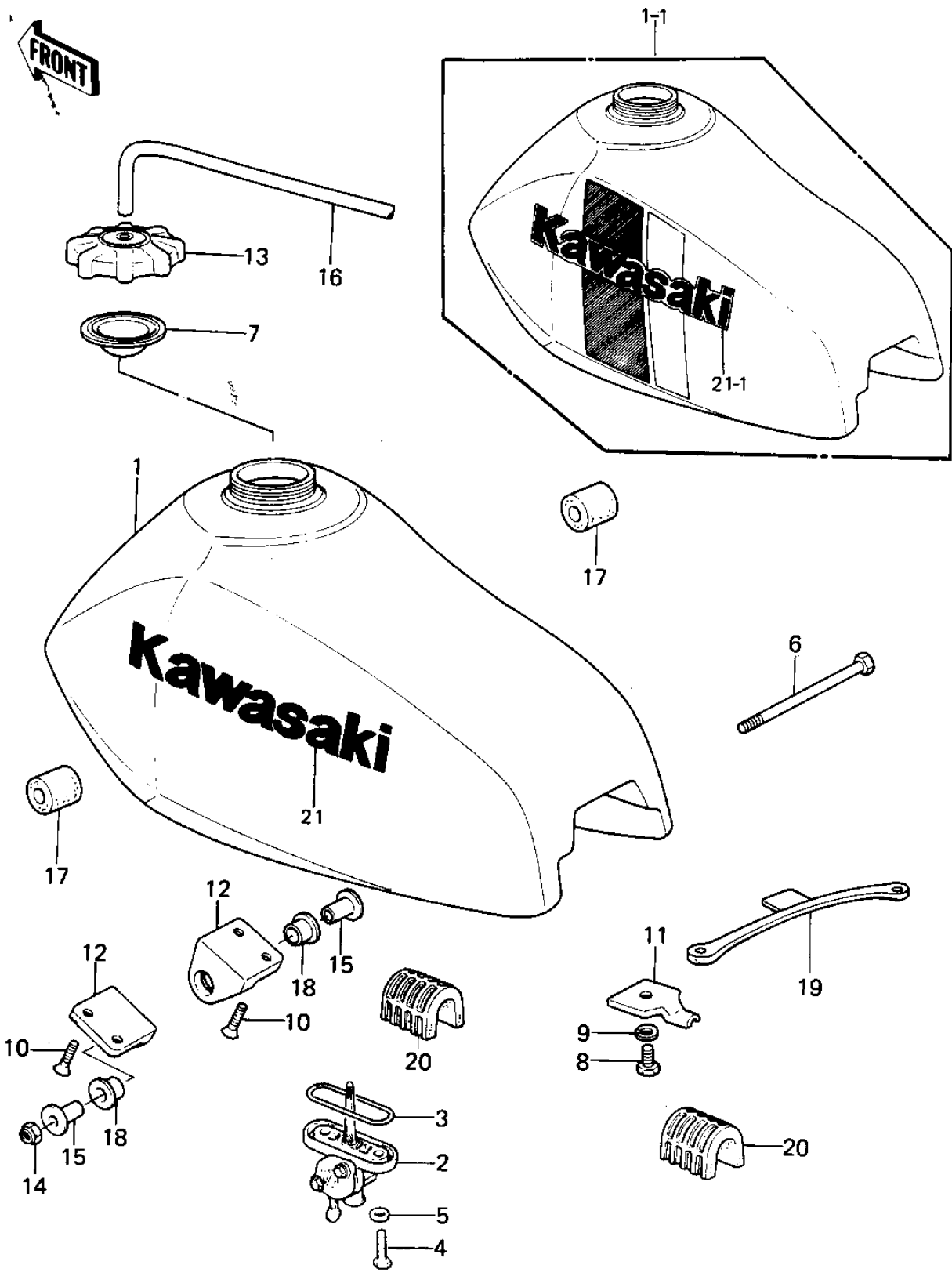

1979 KLX250 PARTS LIST

FUEL TANK

| ITEM NAME | PART NUMBER | QUANTITY |
|---------------------------------|---------------|----------|
| TANK-FUEL,L.GREEN (Ref # 1) | 51001-1080-6W | 1 |
| TANK-FUEL,L.GREEN (Ref # 1-1) | 51001-5106-6W | 1 |
| COCK ASSY,FUEL (Ref # 2) | 51023-4002 | 1 |
| "O" RING (Ref # 3) | 51039-003 | 1 |
| BOLT,6X20,FUEL TAP (Ref # 4) | 92001-1091 | 2 |
| WASHER-PLAIN (Ref # 5) | 92022-183 | 2 |
| BOLT-UPSET,6X105 (Ref # 6) | 112G06105 | 1 |
| GASKET,FUEL TANK (Ref # 7) | 11009-1452 | 1 |
| BOLT,6X10 (Ref # 8) | 112G0610 | 1 |
| WASHER SPRING 6MM (Ref # 9) | 461F0600 | 1 |
| SCREW CNTSNK HD 6X14 (Ref # 10) | 221B0614 | 4 |
| BRACKET,FUEL TANK (Ref # 11) | 32052-1009 | 1 |
| BRACKET,FUEL TANK (Ref # 12) | 32052-1010 | 2 |
| CAP-TANK,FUEL (Ref # 13) | 51049-1006 | 1 |
| NUT (Ref # 14) | 92019-008 | 1 |
| SPACER,FUEL TANK (Ref # 15) | 92026-1015 | 2 |
| TUBE,VINYL (Ref # 16) | 92059-1022 | 1 |
| DAMPER RUBBER,FUEL (Ref # 17) | 92075-1047 | 2 |
| DAMPER RUBBER,FUEL (Ref # 18) | 92075-1048 | 2 |
| BAND,FUEL TANK (Ref # 19) | 92072-1033 | 1 |
| DAMPER RUBBER,FUEL (Ref # 20) | 92075-1027 | 2 |
| DECAL,FUEL TANK (Ref # 21) | 56014-1023 | 2 |
| EMBLEM,LH (Ref # 21-1) | 56014-4005 | 1 |
| EMBLEM,RH (Ref # 21-1) | 56014-4006 | 1 |