

# 1976 KX250-A3 PARTS DIAGRAM

ENGINE COVERS (74-76)

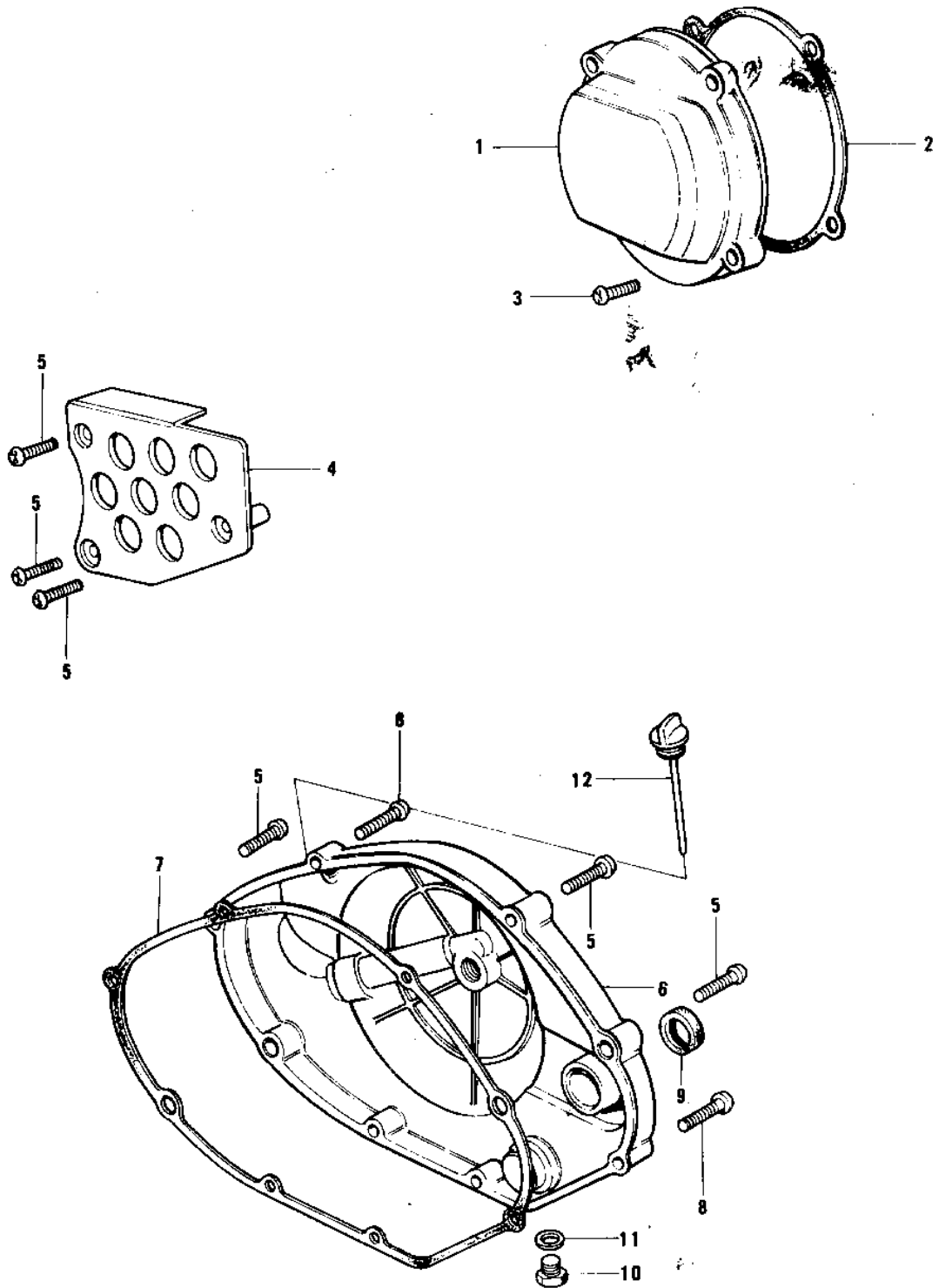

# 1976 KX250-A3 PARTS LIST

## ENGINE COVERS (74-76)

| ITEM NAME                       | PART NUMBER   | QUANTITY |
|---------------------------------|---------------|----------|
| COVER,L.H ENGINE,BLK (Ref # 1)  | 14031-075-21  |          |
| GASKET,L.H ENG COVER (Ref # 2)  | 14045-018     |          |
| SCREW PAN HEAD 6X25 (Ref # 3)   | 220B0625      |          |
| COVER,FRONT CHAIN,BLK (Ref # 4) | 14026-021-21  |          |
| SCREW PAN HEAD 6X35 (Ref # 5)   | 220B0635      |          |
| COVER,R.H ENG,F.BLACK (Ref # 6) | 14032-1009-21 |          |
| GASKET,R.H ENG COVER (Ref # 7)  | 14046-030     |          |
| SCREW PAN HEAD 6X45 (Ref # 8)   | 220B0645      |          |
| OIL SEAL SB20285 (Ref # 9)      | 92049-012     |          |
| PLUG OIL DRAIN (Ref # 10)       | 92067-001     |          |
| GASKET CHECK VALVE (Ref # 11)   | 92065-058     |          |
| PLUG,OI FILLER (Ref # 12)       | 16115-024     |          |