

1979 KX250-A5 PARTS DIAGRAM

TRANSMISSION (78-79)

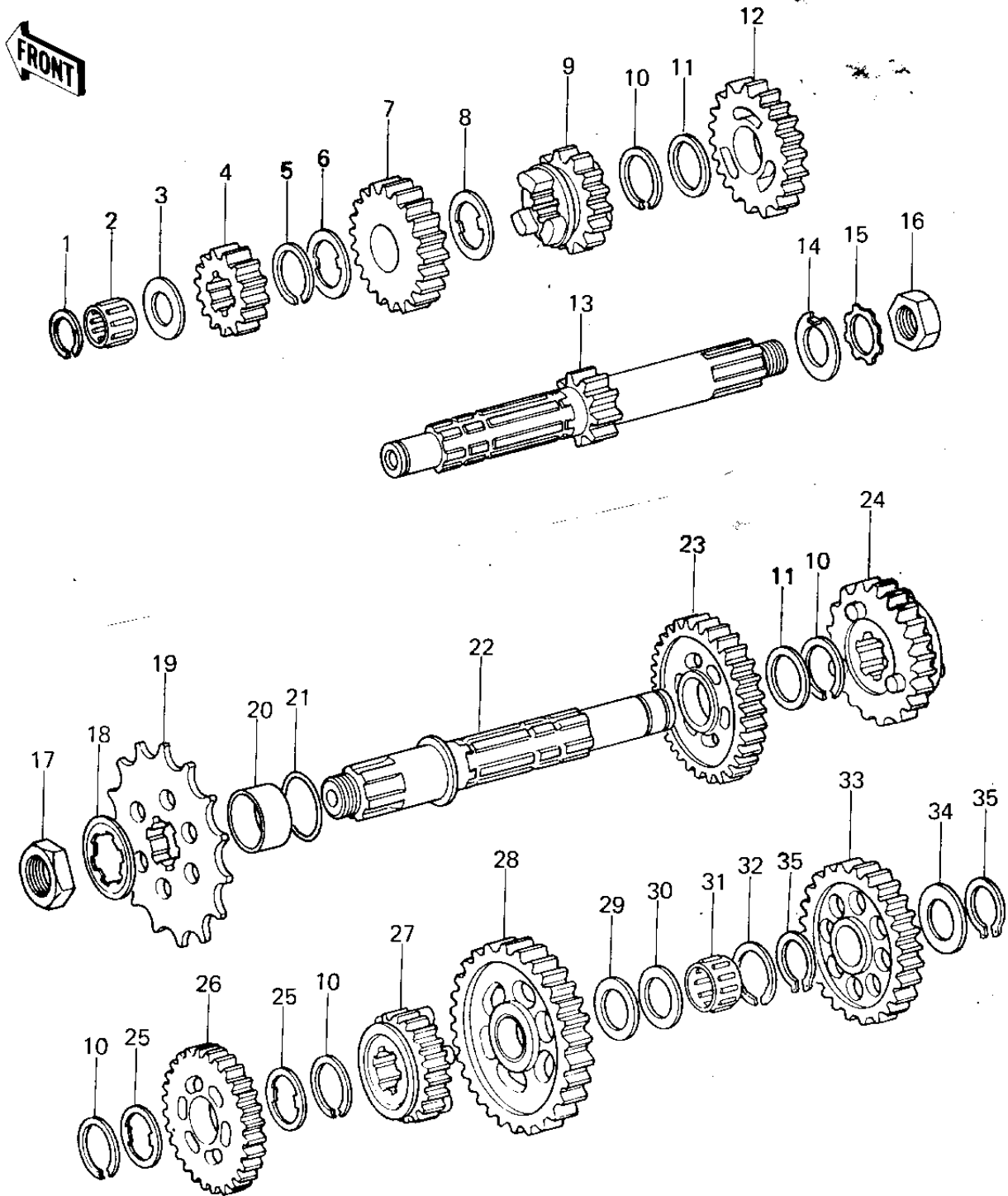

1979 KX250-A5 PARTS LIST

TRANSMISSION (78-79)

ITEM NAME	PART NUMBER	QUANTITY
CIRCLIP,DRIVE SHAFT (Ref # 1)	92033-030	
BEARING,BALL (Ref # 2)	92046-038	
WASHER,THRUST,15MM (Ref # 3)	92022-279	
2ND GEAR,DRIVE SHAFT (Ref # 4)	13129-1073	
2ND GEAR,DRIVE SHAFT (Ref # 4)	13129-1114	
CIRCLIP,18MM (Ref # 5)	92033-029	
WASHER,LOCK (Ref # 6)	92024-059	
4TH GEAR,DRIVE SHAFT (Ref # 7)	13129-1024	
WASHER,LOCK (Ref # 8)	92022-1033	
3RD GEAR,DRIVE SHAFT (Ref # 9)	13129-1023	
3RD GEAR,DRIVE SHAFT (Ref # 9)	13129-1115	
CIRCLIP,25MM (Ref # 10)	92033-025	
WASHER-PLAIN (Ref # 11)	92022-198	
TOP GEAR,DRIVE SHAFT (Ref # 12)	13129-1028	
SHAFT,DRIVE (Ref # 13)	13127-1002	
SHAFT,DRIVE (Ref # 13)	13127-1013	
WASHER,16.8X32X1.6 (Ref # 14)	92022-1277	
WASHER,LOCK,16MM (Ref # 15)	464H1600	
NUT,16M/M (Ref # 16)	92015-1016	
NUT BEARING ADJUST (Ref # 17)	42045-008	
WASHER,LOCK (Ref # 18)	92024-065	
ENGINE SPROCKET,14T (Ref # 19)	13144-1006	
COLLAR-ENG SPROKET (Ref # 20)	92027-163	
"O" RING (Ref # 21)	92055-035	
SHAFT,OUTPUT (Ref # 22)	13128-1003	
2ND GEAR,OUTPUT SHAFT (Ref # 23)	13129-1025	
2ND GEAR,OUTPUT SHAFT (Ref # 23)	13129-1117	
4TH GEAR,OUTPUT SHAFT (Ref # 24)	13129-1027	
WASHER-LOCK (Ref # 25)	92024-039	

1979 KX250-A5 PARTS LIST

TRANSMISSION (78-79)

ITEM NAME	PART NUMBER	QUANTITY
3RD GEAR,OUTPUT SHAFT (Ref # 26)	13129-1026	
3RD GEAR,OUTPUT SHAFT (Ref # 26)	13129-1118	
TOP GEAR,OUTPUT 20T (Ref # 27)	13137-030	
LOW GEAR,OUTPUT 28T (Ref # 28)	13129-052	
LOW GEAR,OUTPUT SHAFT (Ref # 28)	13129-1116	
WASHER,PLAIN (Ref # 29)	92022-280	
WASHER,PLAIN (Ref # 30)	92022-281	
BEARING-NEEDLE (Ref # 31)	92046-1184	
CIRCLIP,16MM (Ref # 32)	92033-032	
IDLE GEAR,KICKSTARTER (Ref # 33)	59051-1003	
WASHER-THRUST (Ref # 34)	92022-197	
CIRCLIP 16MM (Ref # 35)	480J1600	