

1979 KX250-A5 PARTS DIAGRAM

SWING ARM/SHOCK ABSORBERS (78-79)

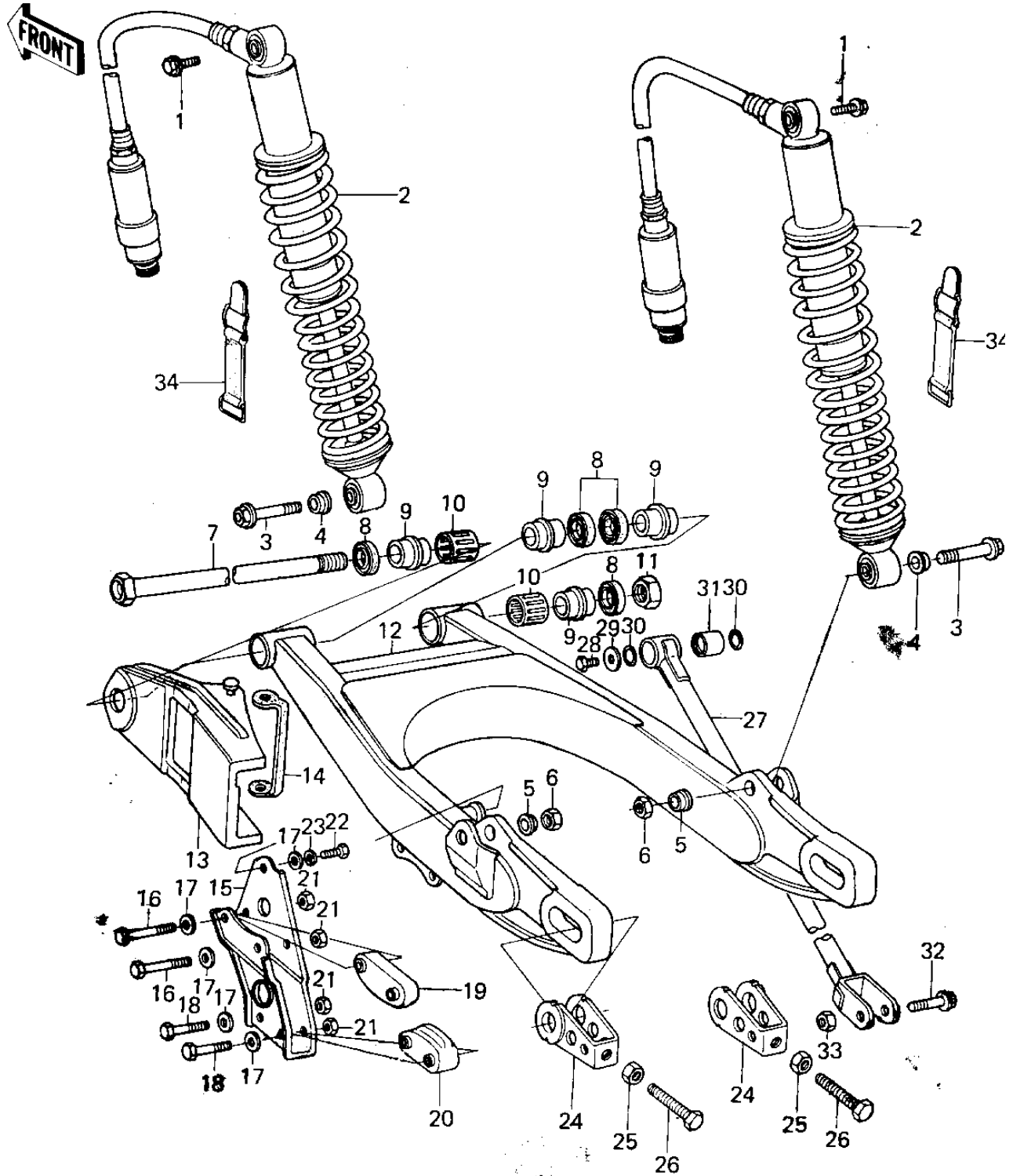

1979 KX250-A5 PARTS LIST

SWING ARM/SHOCK ABSORBERS (78-79)

| ITEM NAME | PART NUMBER | QUANTITY |
|---------------------------------|-------------|----------|
| BOLT,HEX HEAD,6X10 (Ref # 1) | 92001-1034 | |
| SHOCK ABSBR RR (Ref # 2) | 45014-1008 | |
| SHOCK ABSBR RR (Ref # 2) | 45014-1031 | |
| BOLT,HEX HEAD,10X48 (Ref # 3) | 92001-1029 | |
| COLLAR (Ref # 4) | 92027-1029 | |
| COLLAR (Ref # 5) | 92027-1030 | |
| NUT,LOCK,10MM (Ref # 6) | 92019-021 | |
| SHAFT,SWING ARM,PIVOT (Ref # 7) | 33032-1001 | |
| SHAFT,SWING ARM PIVOT (Ref # 7) | 33032-1010 | |
| OIL SEAL (Ref # 8) | 92049-1011 | |
| SLEEVE,SWING ARM (Ref # 9) | 42036-1026 | |
| BEARING,NEEDLE (Ref # 10) | 92046-1001 | |
| NUT-LOCK,14MM (Ref # 11) | 92019-011 | |
| ARM,SWING (Ref # 12) | 33001-1010 | |
| ARM,SWING (Ref # 12) | 33001-1030 | |
| GUIDE CHAIN,FRONT (Ref # 13) | 12053-1017 | |
| BAND (Ref # 14) | 92072-1018 | |
| GUARD, CHAIN (Ref # 15) | 55020-1015 | |
| BOLT,HEX HEAD,6X50 (Ref # 16) | 110G0650 | |
| WASHER PLAIN 6MM (Ref # 17) | 411B0600 | |
| BOLT 6X35 (Ref # 18) | 110R0635 | |
| GUIDE,CHAIN (Ref # 19) | 12053-1015 | |
| GUIDE,CHAIN,REAR (Ref # 20) | 12053-1011 | |
| NUT (Ref # 21) | 92019-008 | |
| BOLT-UPSET 6X14 (Ref # 22) | 112B0614 | |
| WASHER SPRING 6MM (Ref # 23) | 461F0600 | |
| ADJUSTER,CHAIN (Ref # 24) | 33040-1005 | |
| NUT,8MM (Ref # 25) | 312G0800 | |
| NUT 8MM (Ref # 25) | 318G0800 | |

1979 KX250-A5 PARTS LIST

SWING ARM/SHOCK ABSORBERS (78-79)

| ITEM NAME | PART NUMBER | QUANTITY |
|---------------------------------|-------------|----------|
| BOLT,CHAIN ADJUSTER (Ref # 26) | 92001-1027 | |
| ROD,TORQUE (Ref # 27) | 43007-1003 | |
| TORQUE LINK,RR.BRAKE (Ref # 27) | 43007-1009 | |
| BOLT,6X10 (Ref # 28) | 112G0610 | |
| WASHER,PLAIN,7MM (Ref # 29) | 92022-228 | |
| "O" RING,15MM (Ref # 30) | 670B2015 | |
| BUSHING,BRAKE ROD (Ref # 31) | 92028-1023 | |
| BOLT,HEX HEAD,8X36 (Ref # 32) | 92001-1041 | |
| NUT,LOCK,8MM (Ref # 33) | 92015-1124 | |
| BAND,FUEL TANK (Ref # 34) | 92072-076 | |
| GUARD,CHAIN (Ref # 35) | 55020-1020 | |
| GUARD,CHAIN (Ref # 36) | 55020-1021 | |
| GUIDE,CHAIN (Ref # 37) | 12053-1033 | |
| BOLT-UPSET 6X14 (Ref # 38) | 112B0614 | |
| WASHER PLAIN 6MM (Ref # 39) | 411B0600 | |
| BOLT,HEX HEAD,6X50 (Ref # 40) | 110G0650 | |
| BOLT-UPSET,6X40 (Ref # 41) | 112G0640 | |
| NUT (Ref # 42) | 92019-008 | |