

# 1968 Samurai PARTS DIAGRAM

## ENGINE COVERS

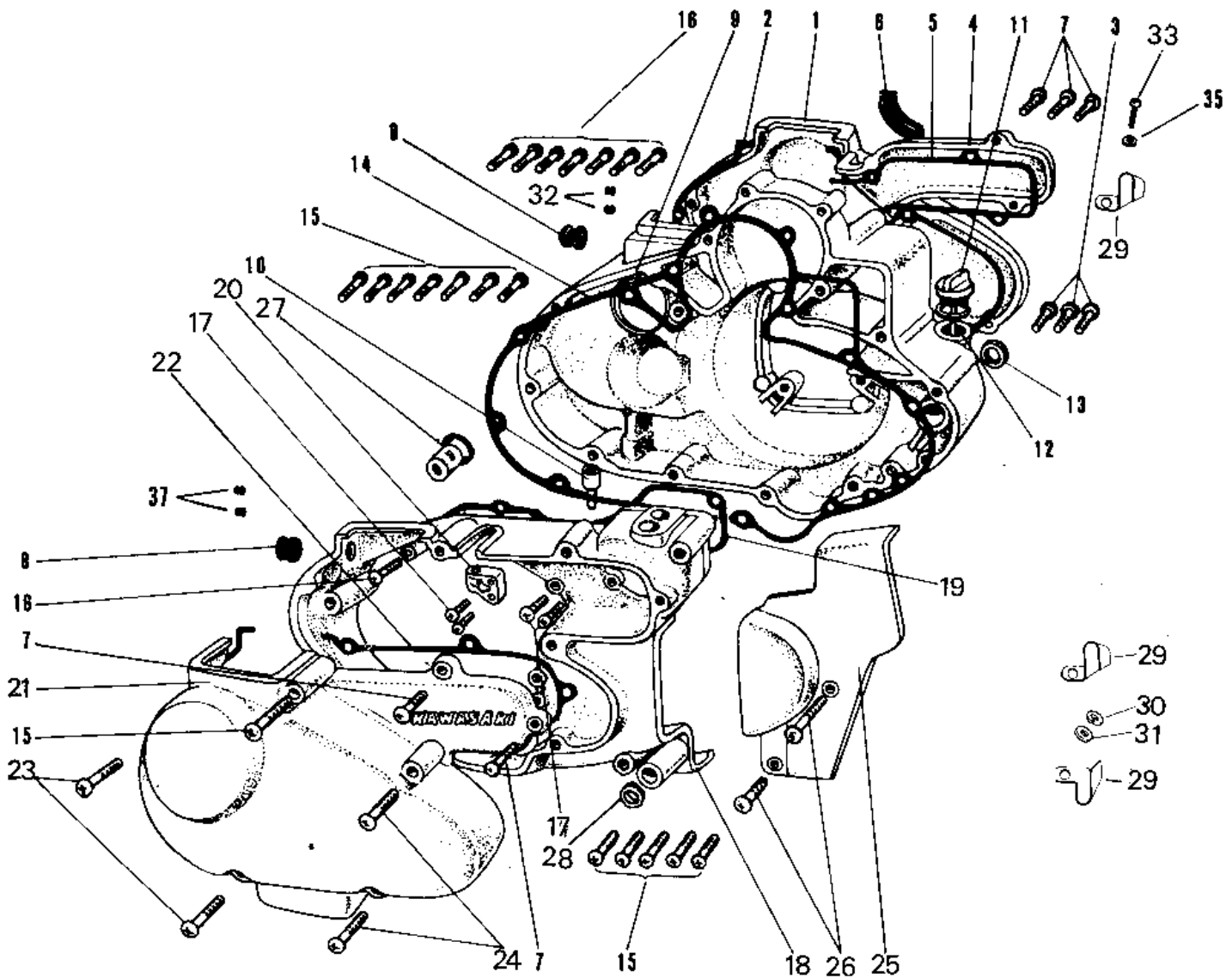

# 1968 Samurai PARTS LIST

## ENGINE COVERS

ITEM NAME	PART NUMBER	QUANTITY
COVER R.H CARBURETOR (Ref # 1)	14030-007	1
GASKET R.H CARB COVER (Ref # 2)	14047-004	1
SCREW OVL CNTSNK 6X25 (Ref # 3)	222B0625	3
CAP R.H ENGINE COVER (Ref # 4)	14034-001	1
GASKET R.H COV CAP A (Ref # 5)	14046-010	1
GSKT RH ENG COV CAP B (Ref # 6)	14016-011	1
SCREW PAN HEAD 6X20 (Ref # 7)	220B0620	5
CAP CARB MOUNT HOLE (Ref # 8)	14039-001	2
COVER R.H ENGINE (Ref # 9)	14032-023	1
PIPE FUEL OVERFLOW (Ref # 10)	16116-001	1
PLUG OIL FILLER (Ref # 11)	16115-002	1
"O" RING,20MM (Ref # 12)	670B2020	1
OIL SEAL TB16267 (Ref # 13)	92051-003	1
GASKET R.H ENGINE COV (Ref # 14)	14046-008	1
SCREW PAN HEAD 6X50 (Ref # 15)	220B0650	17
SCREW PAN HEAD 6X40 (Ref # 16)	220B0640	10
SCREW PAN HEAD 6X25 (Ref # 17)	220B0625	5
COVER L.H ENGINE (Ref # 18)	14031-029	1
GASKET L.H ENGINE COV (Ref # 19)	14045-002	1
GUIDE OIL PUMP CABLE (Ref # 20)	14044-004	1
COVER L.H CARBURETOR (Ref # 21)	14030-010	1
GASKET L.H CARB COVER (Ref # 22)	14047-006	1
SCREW OVL CNTSNK 6X50 (Ref # 23)	222B0650	2
SCREW OVL CNTSNK 6X40 (Ref # 24)	222B0640	2
COVER DRIVE CHAIN FR (Ref # 25)	14026-001	1
SCREW PAN HEAD 6X70 (Ref # 26)	220B0670	2
DRAIN AIR (Ref # 27)	16116-003	2
OIL SEAL SB12205 (Ref # 28)	92049-004	1
GUIDE OVERFLOW PIPE (Ref # 29)	16068-001	3

# 1968 Samurai PARTS LIST

## ENGINE COVERS

ITEM NAME	PART NUMBER	QUANTITY
WASHER PLAIN 6MM (Ref # 30)	410B0600	3
PLUG RUBBER (Ref # 32)	92074-016	2
SCREW OVL CNTSNK 6X20 (Ref # 33)	222B0620	1