

1966 Samurai PARTS DIAGRAM

IGNITION/GENERATOR A1/A7

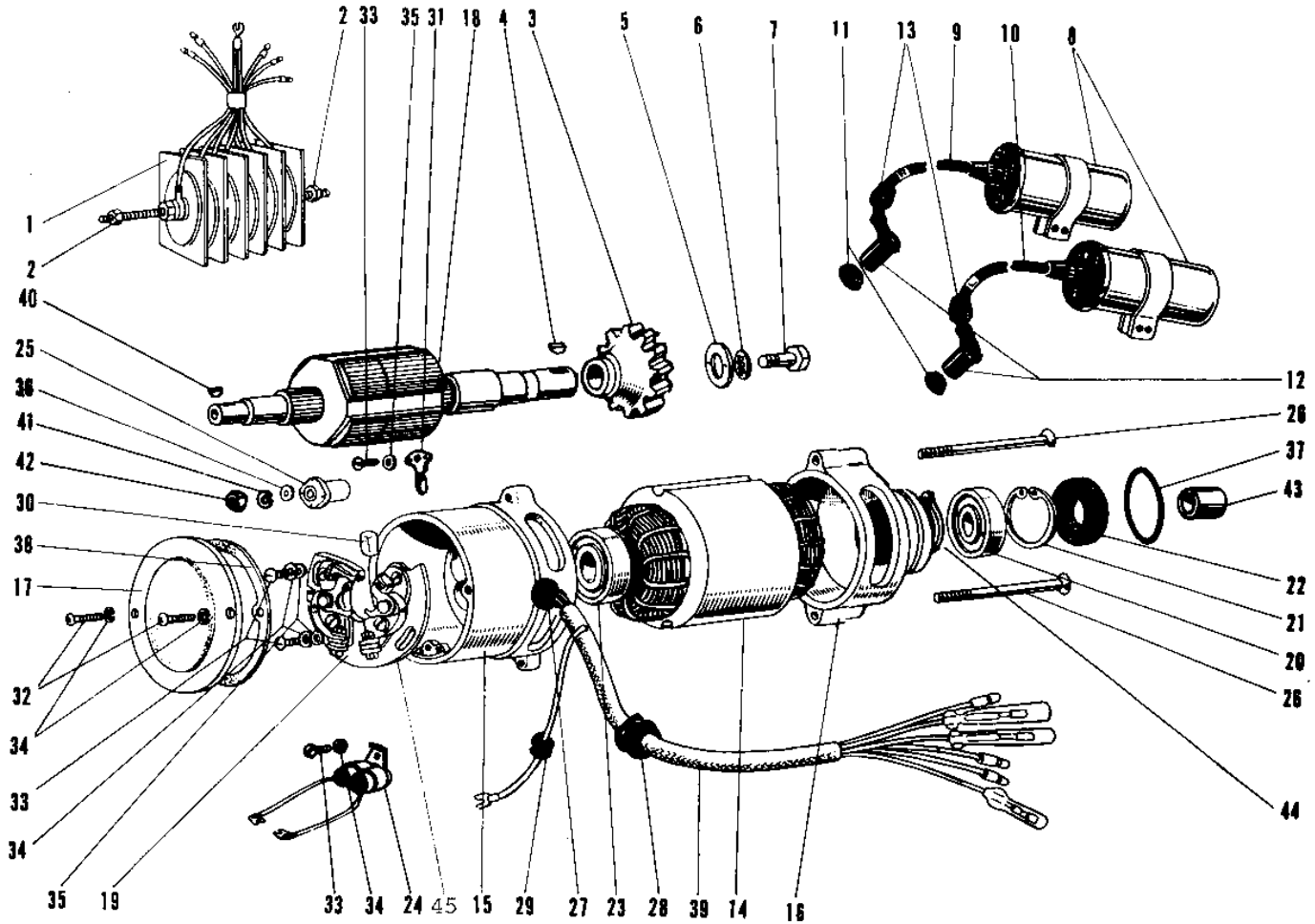

1966 Samurai PARTS LIST

IGNITION/GENERATOR A1/A7

ITEM NAME	PART NUMBER	QUANTITY
RECTIFIER (Ref # 1)	21061-005	1
NUT 6MM (Ref # 2)	312B0600	2
GEAR DYNAMO (Ref # 3)	21069-002	1
WOODRUFF KEY (Ref # 4)	510A3100	1
WASHER PLAIN 8MM (Ref # 5)	92022-079	1
WASHER LOCK 8MM (Ref # 6)	463H0800	1
BOLT,8X20 (Ref # 7)	115G0820	1
COIL IGNITION (Ref # 8)	21121-015	2
CORD HIGH TENSION R.H (Ref # 9)	21133-007	1
CORD HIGH TENSION L.H (Ref # 10)	21133-008	1
GROMMET PLUG CAP A (Ref # 11)	21131-002	2
CAP-SPARK PLUG (Ref # 12)	21130-016	2
GROMMET (Ref # 13)	92071-517	2
DYNAMO EN-11 (Ref # 14~45)	21001-009	1
STATOR (Ref # 14)	21003-003	1
UNAVAILABLE IN PRICE BOOK (Ref # 15)	21004-002	1
UNAVAILABLE IN PRICE BOOK (Ref # 16)	21005-002	1
COVER CONTACT BREAKER (Ref # 17)	21006-002	1
ROTOR (Ref # 18)	21007-004	1
CONTACT BREAKER ASSY (Ref # 19)	21008-008	1
BEARING BALL #6202 (Ref # 20)	21009-001	1
CIRCLIP 35MM (Ref # 21)	21010-002	1
OIL SEAL SB22357 (Ref # 22)	21011-002	1
BEARING BALL #6201ZZ (Ref # 23)	21009-002	1
CONDENSER (Ref # 24)	21013-008	1
CAM (Ref # 25)	21014-003	1
SCREW CNTSNK HD 6X80 (Ref # 26)	21015-002	2
GROMMET WIRING HARN A (Ref # 27)	21017-001	1
GROMMET WIRING HARN B (Ref # 28)	21017-003	1

1966 Samurai PARTS LIST

IGNITION/GENERATOR A1/A7

ITEM NAME	PART NUMBER	QUANTITY
GROMMET WIRING HARN C (Ref # 29)	21017-005	1
FELT OIL (Ref # 30)	21019-005	1
POINTER IGN TIMING (Ref # 31)	21020-001	1
SCREW PAN HEAD 4X10 (Ref # 32)	220B0410	2
SCREW PAN HEAD 4X6 (Ref # 33)	21022-010	(4
SCREW PAN HEAD 4X6 (Ref # 33)	220B0406	4
WASHER SPRING 4MM (Ref # 34)	461F0400	5
WASHER PLAIN 4MM (Ref # 35)	410B0400	3
WASHER PLAIN 6MM (Ref # 36)	410B0600	1
"O" RING,46MM (Ref # 37)	21027-002	1
GASKET CNTCT BRK COV (Ref # 38)	21028-002	1
WIRING HARNESS DYNAMO (Ref # 39)	21029-004	1
WOODRUFF KEY CAM (Ref # 40)	21030-002	1
WASHER SPRING 8MM (Ref # 41)	461F0800	1
NUT 8MM (Ref # 42)	21032-001	1
COLLER DYNAMO GEAR (Ref # 43)	21033-001	1
WASHER WAVE 19MM (Ref # 44)	21034-001	1
PLATE,CONTACT BREAKER (Ref # 44)	21156-012	1