

# 1971 A7SS-B PARTS DIAGRAM

IGNITION/GENERATOR A1/A7

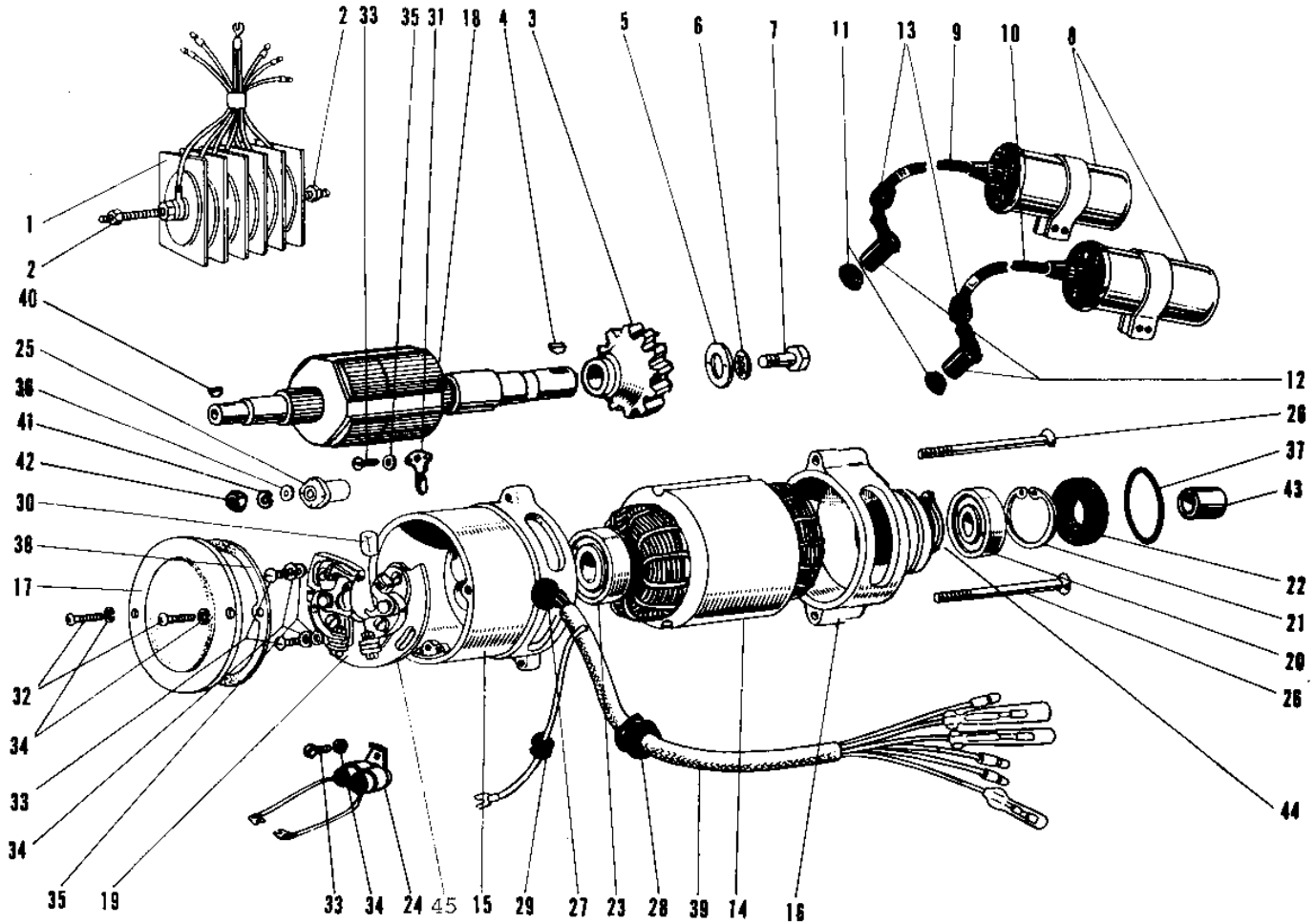

# 1971 A7SS-B PARTS LIST

## IGNITION/GENERATOR A1/A7

| ITEM NAME                            | PART NUMBER | QUANTITY |
|--------------------------------------|-------------|----------|
| RECTIFIER (Ref # 1)                  | 21061-005   | 1        |
| NUT 6MM (Ref # 2)                    | 312B0600    | 2        |
| GEAR DYNAMO (Ref # 3)                | 21069-002   | 1        |
| WOODRUFF KEY (Ref # 4)               | 510A3100    | 1        |
| WASHER PLAIN 8MM (Ref # 5)           | 92022-079   | 1        |
| WASHER LOCK 8MM (Ref # 6)            | 463H0800    | 1        |
| BOLT,8X20 (Ref # 7)                  | 115G0820    | 1        |
| COIL IGNITION (Ref # 8)              | 21121-015   | 2        |
| CORD HIGH TENSION R.H (Ref # 9)      | 21133-007   | 1        |
| CORD HIGH TENSION L.H (Ref # 10)     | 21133-008   | 1        |
| GROMMET PLUG CAP A (Ref # 11)        | 21131-002   | 2        |
| CAP-SPARK PLUG (Ref # 12)            | 21130-016   | 2        |
| GROMMET (Ref # 13)                   | 92071-517   | 2        |
| DYNAMO EN-11 (Ref # 14~45)           | 21001-009   | 1        |
| STATOR (Ref # 14)                    | 21003-003   | 1        |
| UNAVAILABLE IN PRICE BOOK (Ref # 15) | 21004-002   | 1        |
| UNAVAILABLE IN PRICE BOOK (Ref # 16) | 21005-002   | 1        |
| COVER CONTACT BREAKER (Ref # 17)     | 21006-002   | 1        |
| ROTOR (Ref # 18)                     | 21007-004   | 1        |
| CONTACT BREAKER ASSY (Ref # 19)      | 21008-008   | 1        |
| BEARING BALL #6202 (Ref # 20)        | 21009-001   | 1        |
| CIRCLIP 35MM (Ref # 21)              | 21010-002   | 1        |
| OIL SEAL SB22357 (Ref # 22)          | 21011-002   | 1        |
| BEARING BALL #6201ZZ (Ref # 23)      | 21009-002   | 1        |
| CONDENSER (Ref # 24)                 | 21013-008   | 1        |
| CAM (Ref # 25)                       | 21014-003   | 1        |
| SCREW CNTSNK HD 6X80 (Ref # 26)      | 21015-002   | 2        |
| GROMMET WIRING HARN A (Ref # 27)     | 21017-001   | 1        |
| GROMMET WIRING HARN B (Ref # 28)     | 21017-003   | 1        |

# 1971 A7SS-B PARTS LIST

## IGNITION/GENERATOR A1/A7

| ITEM NAME                        | PART NUMBER | QUANTITY |
|----------------------------------|-------------|----------|
| GROMMET WIRING HARN C (Ref # 29) | 21017-005   | 1        |
| FELT OIL (Ref # 30)              | 21019-005   | 1        |
| POINTER IGN TIMING (Ref # 31)    | 21020-001   | 1        |
| SCREW PAN HEAD 4X10 (Ref # 32)   | 220B0410    | 2        |
| SCREW PAN HEAD 4X6 (Ref # 33)    | 21022-010   | (4       |
| SCREW PAN HEAD 4X6 (Ref # 33)    | 220B0406    | 4        |
| WASHER SPRING 4MM (Ref # 34)     | 461F0400    | 5        |
| WASHER PLAIN 4MM (Ref # 35)      | 410B0400    | 3        |
| WASHER PLAIN 6MM (Ref # 36)      | 410B0600    | 1        |
| "O" RING,46MM (Ref # 37)         | 21027-002   | 1        |
| GASKET CNTCT BRK COV (Ref # 38)  | 21028-002   | 1        |
| WIRING HARNESS DYNAMO (Ref # 39) | 21029-004   | 1        |
| WOODRUFF KEY CAM (Ref # 40)      | 21030-002   | 1        |
| WASHER SPRING 8MM (Ref # 41)     | 461F0800    | 1        |
| NUT 8MM (Ref # 42)               | 21032-001   | 1        |
| COLLER DYNAMO GEAR (Ref # 43)    | 21033-001   | 1        |
| WASHER WAVE 19MM (Ref # 44)      | 21034-001   | 1        |