

# 1971 Avenger PARTS DIAGRAM

HANDLEBAR A1/SS, A7/SS

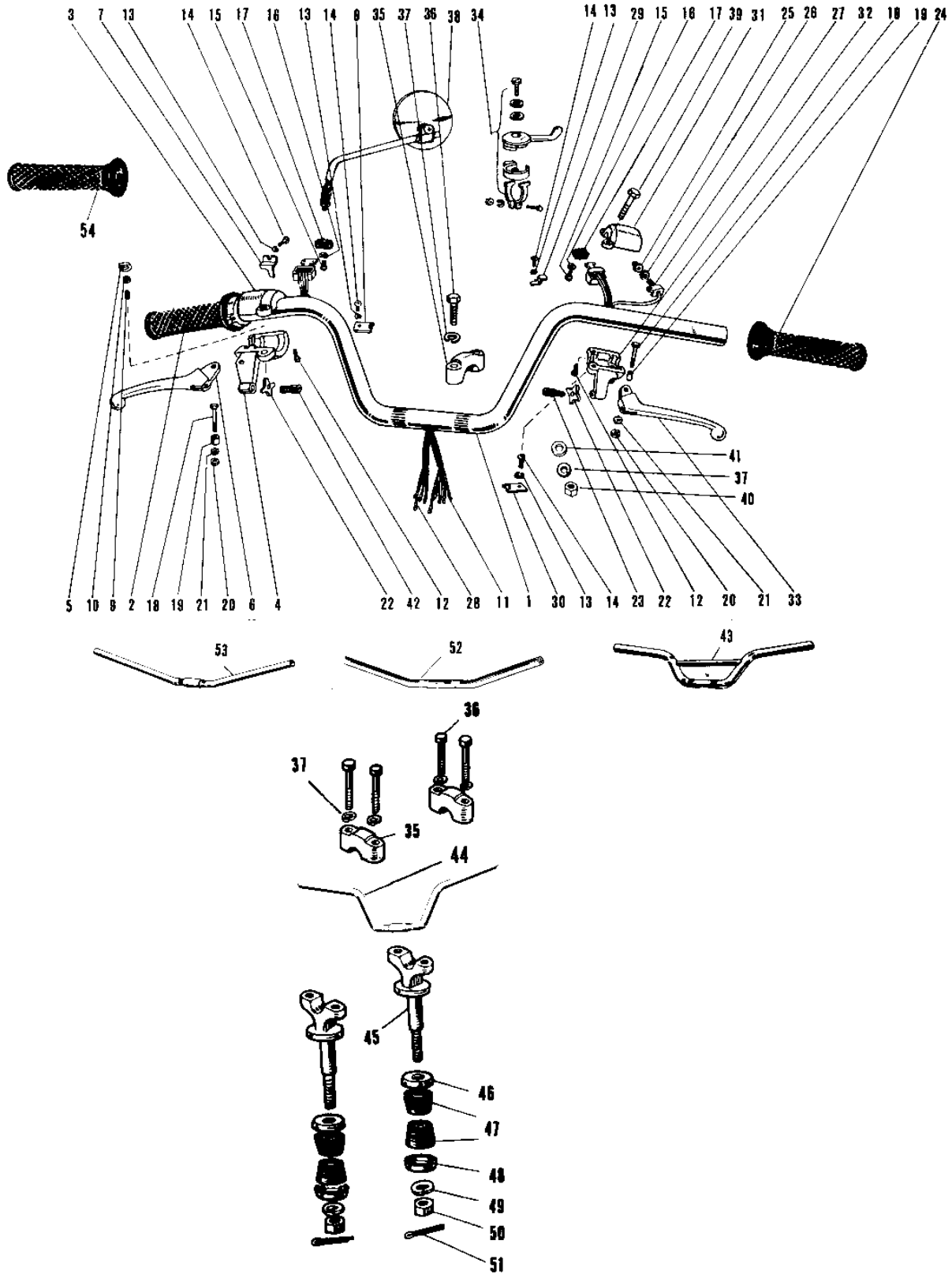

# 1971 Avenger PARTS LIST

## HANDLEBAR A1/SS, A7/SS

ITEM NAME	PART NUMBER	QUANTITY
HANDLEBAR (Ref # 1)	46003-018	1
GRIP ASSY-R.H (Ref # 2~22,4)	46017-042	1
GRIP ASSY THROTTLE (Ref # 2)	46019-005	1
CASE R.H SWITCH UPPER (Ref # 3)	46040-009	1
CASE R.H SWITCH LOWER (Ref # 4)	46022-011	1
SPRING GRIP ADJUST (Ref # 5)	46025-002	1
LEVER FRONT BRAKE (Ref # 6)	46058-005	1
HOLDER R.H SW UP WRNG (Ref # 7)	46037-012	1
HOLDER R.H SW LW WRNG (Ref # 8)	46037-011	1
SCREW GRIP ADJUST (Ref # 9)	46026-002	1
SCREW GRIP ADJUSTING (Ref # 9)	46026-007	1
NUT,5MM (Ref # 10)	311B0500	1
NUT,5MM (Ref # 10)	311B0500	1
WIRING HARNESS R.H SW (Ref # 11)	46032-013	1
SCREW SWITCH CASE (Ref # 12)	92011-010	4
SCREW SWITCH CASE (Ref # 12)	92011-017	4
WASHER SPRING 3MM (Ref # 13)	461F0300	5
SCREW-PAN-HEAD 3X6 (Ref # 14)	220B0306	5
SCREW-PAN-HEAD 3X6 (Ref # 14)	220B0306	5
SCREW PAN HEAD 2X6 (Ref # 15)	211B0206	4
SPRING-WASHER (Ref # 16)	92029-002	4
KNOB SWITCH (Ref # 17)	46044-003	2
BOLT HEX HEAD 5X20 (Ref # 18)	92007-018	2
BOLT HEX HEAD 5X20 (Ref # 18)	92007-020	2
COLLAR LEVER (Ref # 19)	46059-011	2
UNAVAILABLE IN PRICE BOOK (Ref # 20)	92015-038	2
NUT 5MM (Ref # 20)	312B0500	2
WASHER LOCK 5MM (Ref # 21)	464H0500	2
NUT LOCK ADJUST SCREW (Ref # 22)	46056-001	2

# 1971 Avenger PARTS LIST

HANDLEBAR A1/SS, A7/SS

ITEM NAME	PART NUMBER	QUANTITY
SCREW,CABLE ADJUST (Ref # 23)	46055-009	1
GRIP ASSY-L.H. (Ref # 12~22)	46074-112	1
RUBBER L.H GRIP (Ref # 24)	46075-007	1
SWITCH ASSY,HORN BUTN (Ref # 25)	27010-1009	1
CONTACT HORN BUTTON (Ref # 26)	46079-001	1
SWITCH ASSY,HORN BUTN (Ref # 27)	27010-1009	1
WIRING HARNESS L.H SW (Ref # 28)	46082-012	1
HOLDER L.H SW UP WRNG (Ref # 29)	46085-010	1
HOLDER L.H SW LW WRNG (Ref # 30)	46085-009	1
CASE-L.H SWITCH UPPER (Ref # 31)	46086-008	1
CASE L.H SWITCH LOWER (Ref # 32)	46077-009	1
LEVER CLUTCH (Ref # 33)	46092-006	1
LEVER ASSY,STARTER (Ref # 34)	46109-012	1
HOLDER UPPER HANDLEBAR (Ref # 35)	46012-004	2
BOLT 8X38 (Ref # 36)	92001-1405	4
WASHER SPRING 8MM (Ref # 37)	461F0800	5
REAR VIEW MIRROR (Ref # 38)	56001-005	1
BOLT HEX HEAD 8X40 (Ref # 39)	116B0840	1
NUT,8MM (Ref # 40)	311B0800	1
WASHER PLAIN 8MM (Ref # 41)	410B0800	1
SCREW CABLE ADJUST (Ref # 42)	46055-003	1
HANDLEBAR (Ref # 44)	46003-018	1
HOLDER HANDLEBAR LOW (Ref # 45)	46012-007	2
CAP HANDLEBAR HOLDER (Ref # 46)	46016-003	2
DAMPER RUBBER HANDLE (Ref # 47)	92075-039	4
CAP HANDLEBAR HOLDER (Ref # 48)	46016-003	2
WASHER SPRING 10MM (Ref # 49)	461F1000	2
NUT,10MM (Ref # 50)	314B1000	2
PIN COTTER 2.5X20 (Ref # 51)	550D2520	2