

# 1975 Mach II PARTS DIAGRAM

IGNITION/GENERATOR/REGULATOR ('74-'75 S3)

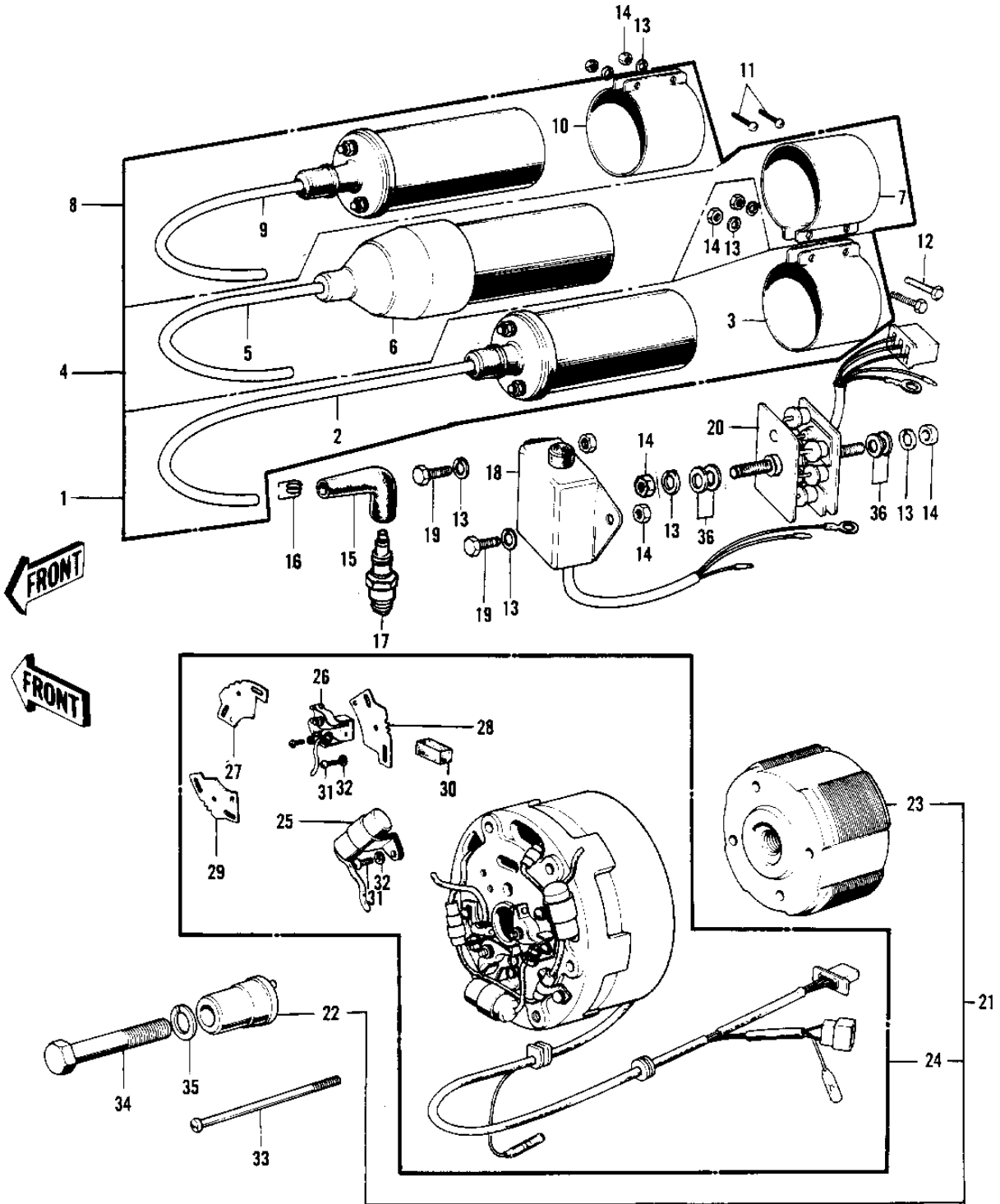

# 1975 Mach II PARTS LIST

IGNITION/GENERATOR/REGULATOR ('74-'75 S3)

ITEM NAME	PART NUMBER	QUANTITY
COIL-IGNITION,L.H (Ref # 1)	21121-051	
CORD-HIGH TENSION,L.H (Ref # 2)	21133-020	
BAND-IGNITION COIL (Ref # 3)	21126-004	
COIL-IGNITION,CENTER (Ref # 4)	21121-052	
CORD-HIGH TENSION,CNT (Ref # 5)	21133-021	
RUBBER CAP,IGN COIL (Ref # 6)	92073-018	
BAND-IGNITION COIL (Ref # 7)	21126-004	
COIL-IGNITION,R.H (Ref # 8)	21121-053	
CORD-HIGH TENSION,R.H (Ref # 9)	21133-022	
BAND-IGNITION COIL (Ref # 10)	21126-004	
SCREW PAN HEAD 6X40 (Ref # 11)	220B0640	
BOLT-UPSET,6X40 (Ref # 11)	112G0640	
BOLT-UPSET,6X20 (Ref # 12)	112G0620	
WASHER SPRING 6MM (Ref # 13)	461F0600	
NUT 6MM (Ref # 14)	311B0600	
CAP SPARK PLUG (Ref # 15)	21130-009	
SPRING-SPARK PLUG CAP (Ref # 16)	92101-001	
SPARK PLUG B9HS (Ref # 17)	B9HS	
SPARK PLUG B9HS1 (Ref # 17)	B9HS1	
SPARK PLUG B8HS (Ref # 17)	B8HS	
REGULATOR,VOLTAGE (Ref # 18)	21066-020	
BOLT-UPSET,6X12 (Ref # 19)	112G0612	
RECTIFIER (Ref # 20)	21061-011	
RECTIFIER (Ref # 20)	21061-029	
RECTIFIER (Ref # 20)	21061-029	
ALTERNATOR (Ref # 21)	21001-022	
CAM (Ref # 22)	21014-008	
ROTOR (Ref # 23)	21007-020	
STATOR ASSY (Ref # 24)	21003-016	

# 1975 Mach II PARTS LIST

IGNITION/GENERATOR/REGULATOR ('74-'75 S3)

ITEM NAME	PART NUMBER	QUANTITY
CONDENSER (Ref # 25)	21013-026	
BREAKER-CONTACT (Ref # 26)	21008-019	
PLATE-CNTCT BRKER,L.H (Ref # 27)	21156-003	
PLATE-CNTCT BRKER,CEN (Ref # 28)	21156-004	
PLATE-CNTCT BRKER,R.H (Ref # 29)	21156-005	
FELT-OIL (Ref # 30)	21019-011	
SCREW PAN HEAD 4X8 (Ref # 31)	220B0408	
WASHER SPRING 4MM (Ref # 32)	461F0400	
SCREW PAN HEAD 5X55 (Ref # 33)	220B0555A	
BOLT HEX HEAD 8X70 (Ref # 34)	114B0870	
WASHER SPRING 8MM (Ref # 35)	461F0800	
WASHER PLAIN 6MM (Ref # 36)	411B0600	
WIRE-LEAD (Ref # 37)	26011-084	