

# 1975 Mach II PARTS DIAGRAM

## SWING ARM/SHOCK ABSORBERS

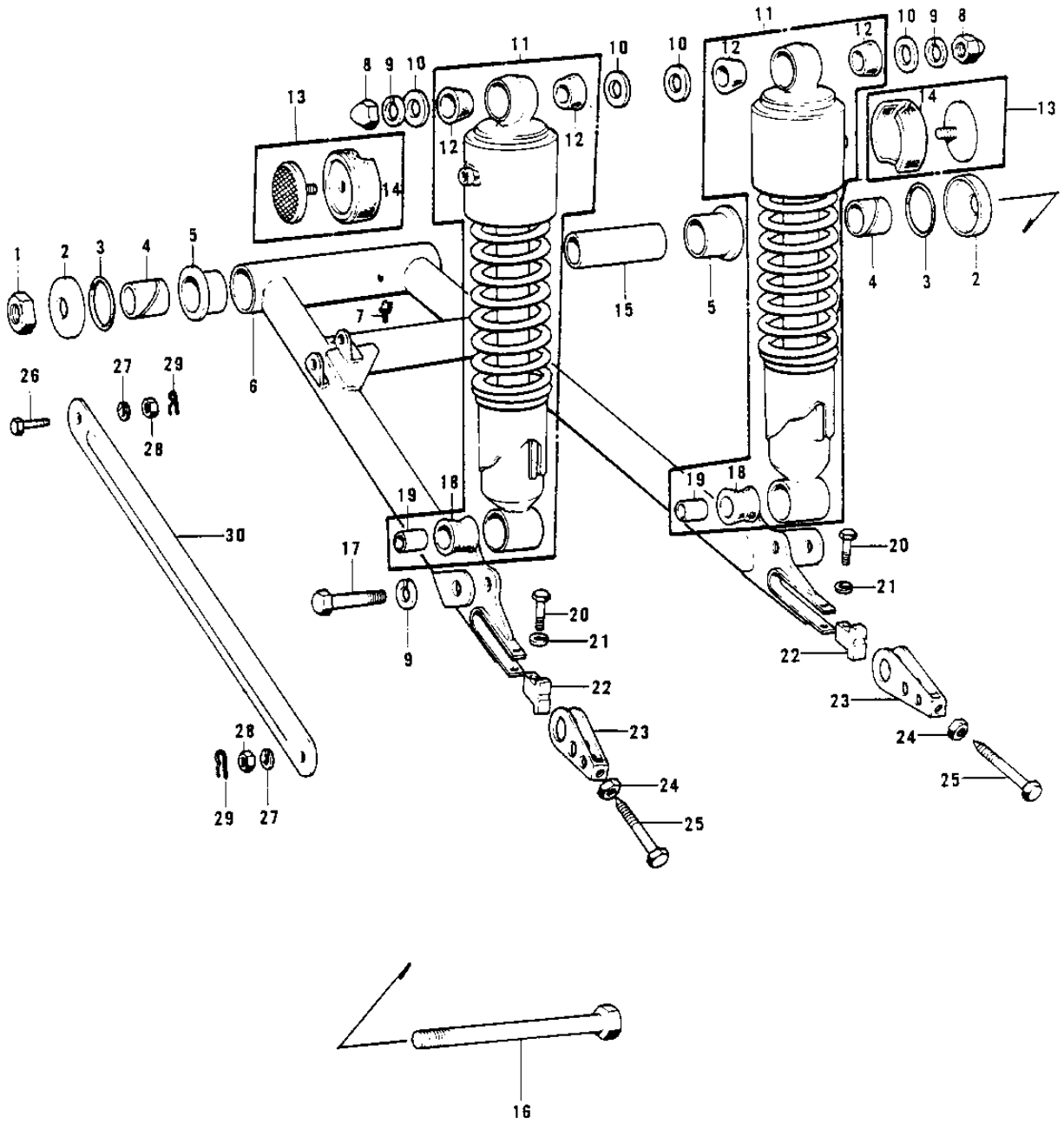

# 1975 Mach II PARTS LIST

## SWING ARM/SHOCK ABSORBERS

ITEM NAME	PART NUMBER	QUANTITY
NUT-LOCK,14MM (Ref # 1)	92019-011	
CAP,SWING ARM (Ref # 2)	33035-007	
"O" RING,30MM (Ref # 3)	671B2530	
SLEEVE-SWING ARM,SHRT (Ref # 4)	33034-013	
BUSHING-SWING ARM (Ref # 5)	33033-009	
ARM-COMP-SWING (Ref # 6)	33001-1089	
ARM-COMP-SWING (Ref # 6)	33001-1089	
GREASE NIPPLE (Ref # 7)	92005-002	
NUT SHOCK ABSORBER (Ref # 8)	92020-003	
WASHER SPRING 10MM (Ref # 9)	461F1000	
WASHER,PLAIN,10MM (Ref # 10)	92022-246	
SHOCK ABSBR RR (Ref # 11)	45014-110	
BUSH SHCK ABS RUBBER (Ref # 12)	45017-001	
REFLECTOR,REFLEX,REAR (Ref # 13)	28001-030	
DAMPER RUBBER,REFLEX (Ref # 14)	28016-003	
SLEEVE-SWING ARM,LONG (Ref # 15)	33034-012	
SHAFT-SWING ARM PIVOT (Ref # 16)	33032-037	
BOLT HEX HEAD 10X35 (Ref # 17)	113N1035	
BUSHING,SHCK ABS RUB (Ref # 18)	45017-018	
BUSH SHCK ABS PVT SFT (Ref # 19)	45016-003	
BOLT,FLANGED,8X35 (Ref # 20)	92001-1577	
BOLT,FLANGED,8X35 (Ref # 20)	92001-1577	
WASHER SPRING 8MM (Ref # 21)	461F0800	
STOPPER,CHAIN ADJUST (Ref # 22)	33044-002	
ADJUSTER,CHAIN (Ref # 23)	33040-056	
NUT 8MM (Ref # 24)	312B0800	
BOLT,8X50 (Ref # 25)	92001-1399	
BOLT,8X50 (Ref # 25)	92001-1399	
BOLT (Ref # 26)	92003-096	