

1978 KZ400-A2 PARTS DIAGRAM

CYLINDER/PISTONS/CRANKSHAFT

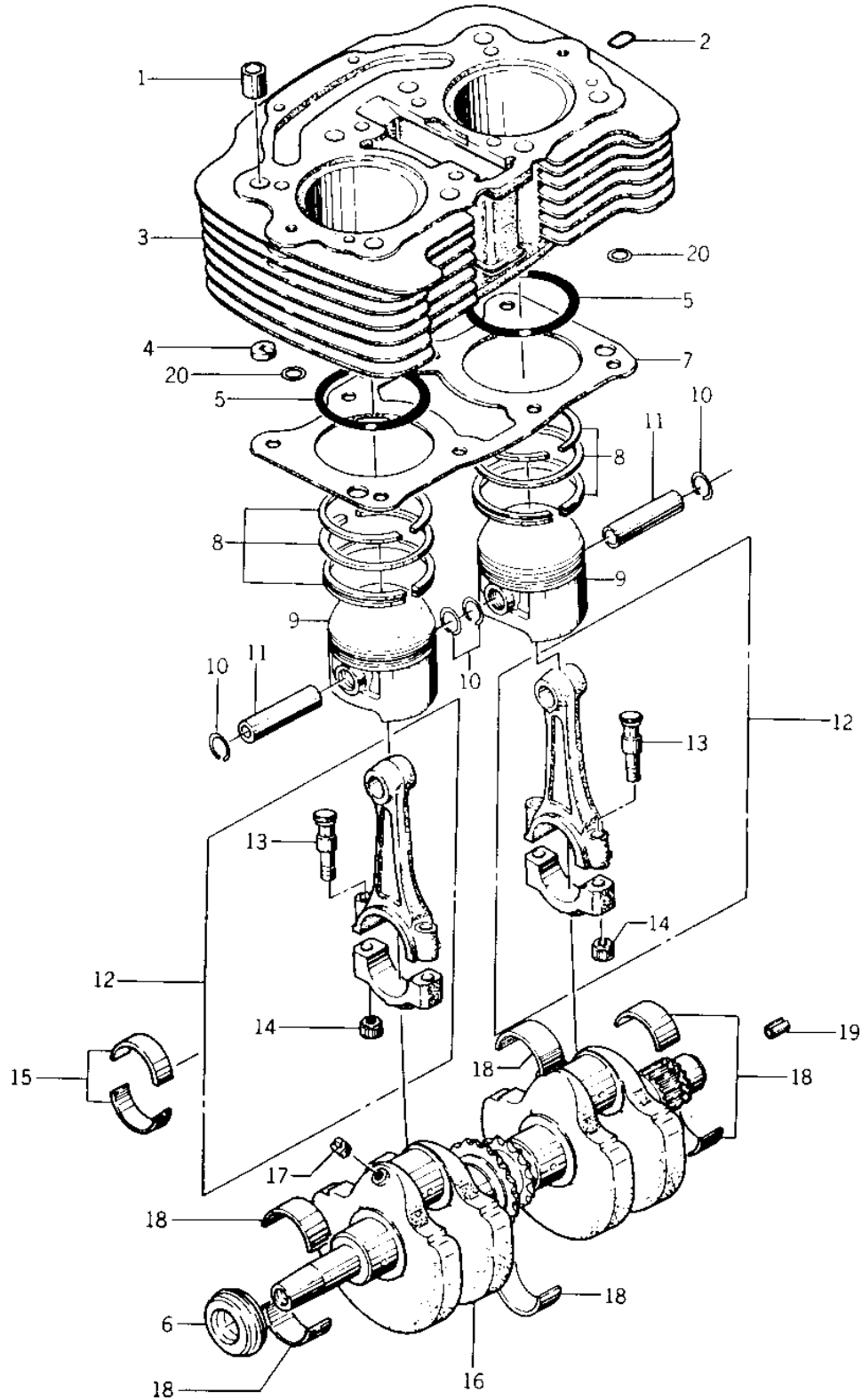

1978 KZ400-A2 PARTS LIST

CYLINDER/PISTONS/CRANKSHAFT

ITEM NAME	PART NUMBER	QUANTITY
PIN,DOWEL,14MM (Ref # 1)	92042-032	
"O" RING,CYLINDER (Ref # 2)	11009-1012	
CYLINDER, (Ref # 3)	11005-146	
DAMPER RUBBER,CYLNDR (Ref # 4)	92075-256	
"O" RING (Ref # 5)	92055-056	
OIL SEAL,L.H CRNKSFT (Ref # 6)	92050-064	
GASKET,CYLINDER BASE (Ref # 7)	11009-040	
RING SET,PISTON,STD (Ref # 8)	13008-5028	
RING SET,PISTON,STD (Ref # 8)	13008-5028	
RING SET,0.020",O/S (Ref # 8)	13025-5013	
RING SET,0.020",O/S (Ref # 8)	13025-5013	
RING SET,0.040",O/S (Ref # 8)	13024-5012	
RING SET,0.040",O/S (Ref # 8)	13024-5012	
PISTON,STD (Ref # 9)	13001-078	
PISTON,0.020'0.S (Ref # 9)	13029-073	
PISTON,0.040'0.S (Ref # 9)	13027-066	
CIRCLIP PISTON PIN (Ref # 10)	92036-005	
PIN-PISTON (Ref # 11)	13002-029	
CONNECTING ROD ASSY,H (Ref # 12)	13032-046-HH	
CONNECTING ROD ASSY,I (Ref # 12)	13032-046-II	
CONNECTING ROD ASSY,J (Ref # 12)	13032-046-JJ	
BOLT (Ref # 13)	92001-169	
NUT,FLANGED,8MM (Ref # 14)	92015-1311	
METAL,CONROD BEARING (Ref # 15)	13034-037	
METAL,CON ROD (Ref # 15)	13034-047	
METAL,CON ROD (Ref # 15)	13034-048	
CRANKSHAFT ASSY (Ref # 16)	13037-061	
SCREW,SLOTTED,6X8 (Ref # 17)	291H0608	
BUSHING,CRANKSHAFT (Ref # 18)	92028-1102	