

1978 KZ400-A2 PARTS DIAGRAM

CLUTCH

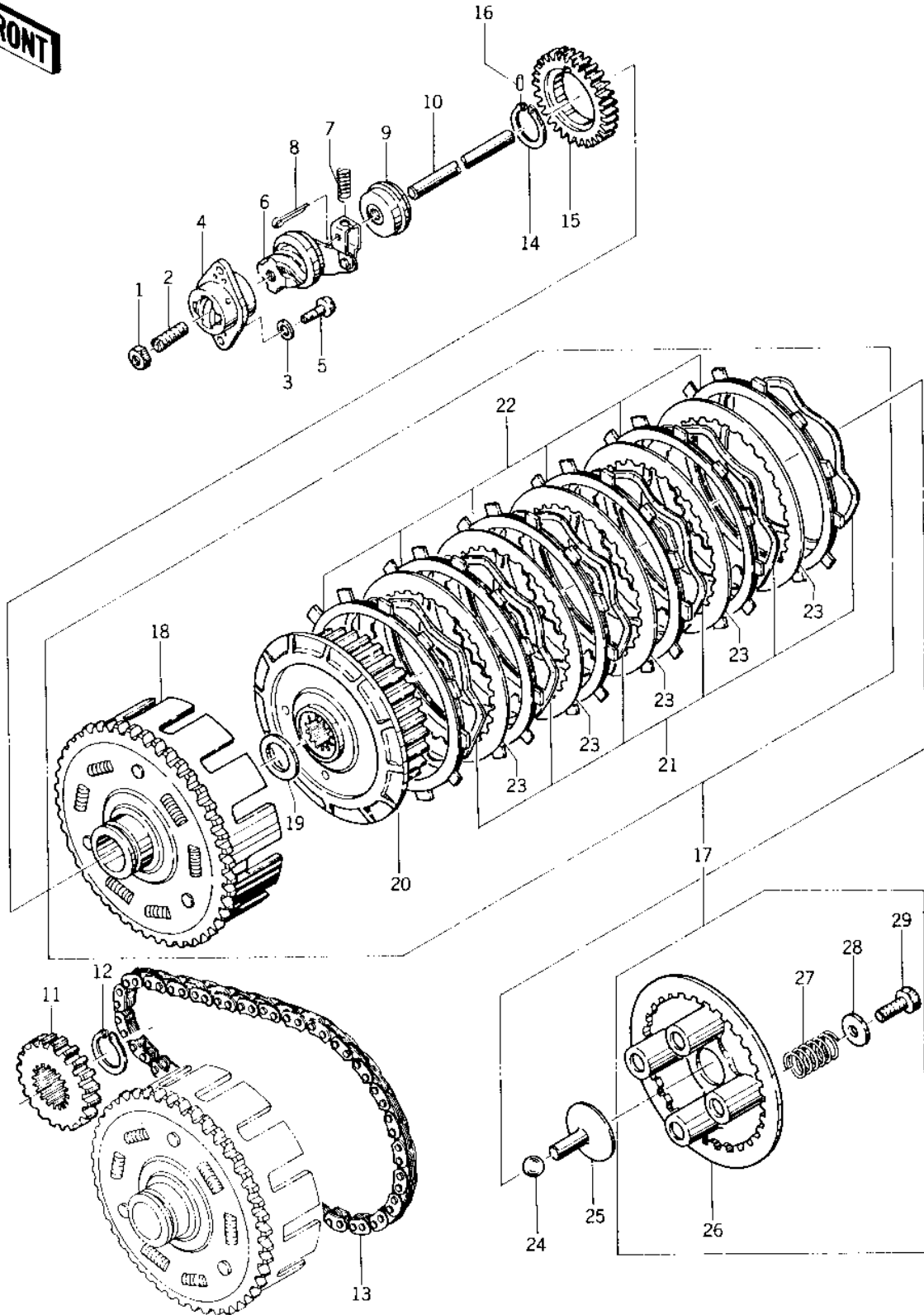

1978 KZ400-A2 PARTS LIST

CLUTCH

ITEM NAME	PART NUMBER	QUANTITY
NUT 8MM (Ref # 1)	318B0800	
SCREW,SLOTTED,8X25 (Ref # 2)	92014-014	
WASHER PLAIN 6MM (Ref # 3)	411B0600	
OUTER,CLUTCH RELEASE (Ref # 4)	13118-007	
SCREW PAN HEAD 6X16 (Ref # 5)	220B0616	
INNER,CLUTCH RELEASE (Ref # 6)	13102-013	
SPRING-CLUTCH RELEASE (Ref # 7)	92081-069	
PIN COTTER 1.6X15 (Ref # 8)	550D1615	
OIL SEAL,PUSH ROD (Ref # 9)	92050-068	
OIL SEAL,PUSH ROD (Ref # 9)	92049-1041	
ROD,PUSH,CLUTCH (Ref # 10)	13116-1017	
ROD,PUSH,CLUTCH (Ref # 10)	13116-1017	
SPROCKET,PRIMARY (Ref # 11)	13121-030	
CIRCLIP,30MM (Ref # 12)	480J3000	
CHAIN,PRIMARY DRIVE (Ref # 13)	13122-005	
CIRCLIP, 38MM (Ref # 14)	480J3800	
GEAR,OIL PUMP (Ref # 15)	16084-019	
GEAR,OIL PUMP (Ref # 15)	16084-019	
PIN, DOWELL, 6X6 (Ref # 16)	610A0606	
CLUTCH-ASSY (Ref # 17)	13081-074	
HOUSING,CLUTCH (Ref # 18)	13095-045	
WASHER,CLUTCH THRUST (Ref # 19)	92022-288	
HUB,CLUTCH (Ref # 20)	13087-040	
RING,CLUTCH STEEL (Ref # 21)	13229-005	
PLATE,FRICITION (Ref # 22)	13088-1001	
PLATE,FRICITION (Ref # 22)	13088-1001	
PLATE,CLUTCH STEEL (Ref # 23)	13089-026	
BALL STEEL 3/8' (Ref # 24)	600A1200	
PUSHER,CLTCH SPRG PLT (Ref # 25)	13116-029	

1978 KZ400-A2 PARTS LIST

CLUTCH

ITEM NAME	PART NUMBER	QUANTITY
PLATE,CLUTCH SPRING (Ref # 26)	13187-007	
SPRING,CLUTCH (Ref # 27)	92081-1033	
SPRING,CLUTCH (Ref # 27)	92081-1033	
HOLDER,CLUTCH SPRING (Ref # 28)	13091-011	
BOLT-UPSET (Ref # 29)	112G0618	