

1978 KZ400-B1 PARTS DIAGRAM

FRAME/FRAME FITTINGS

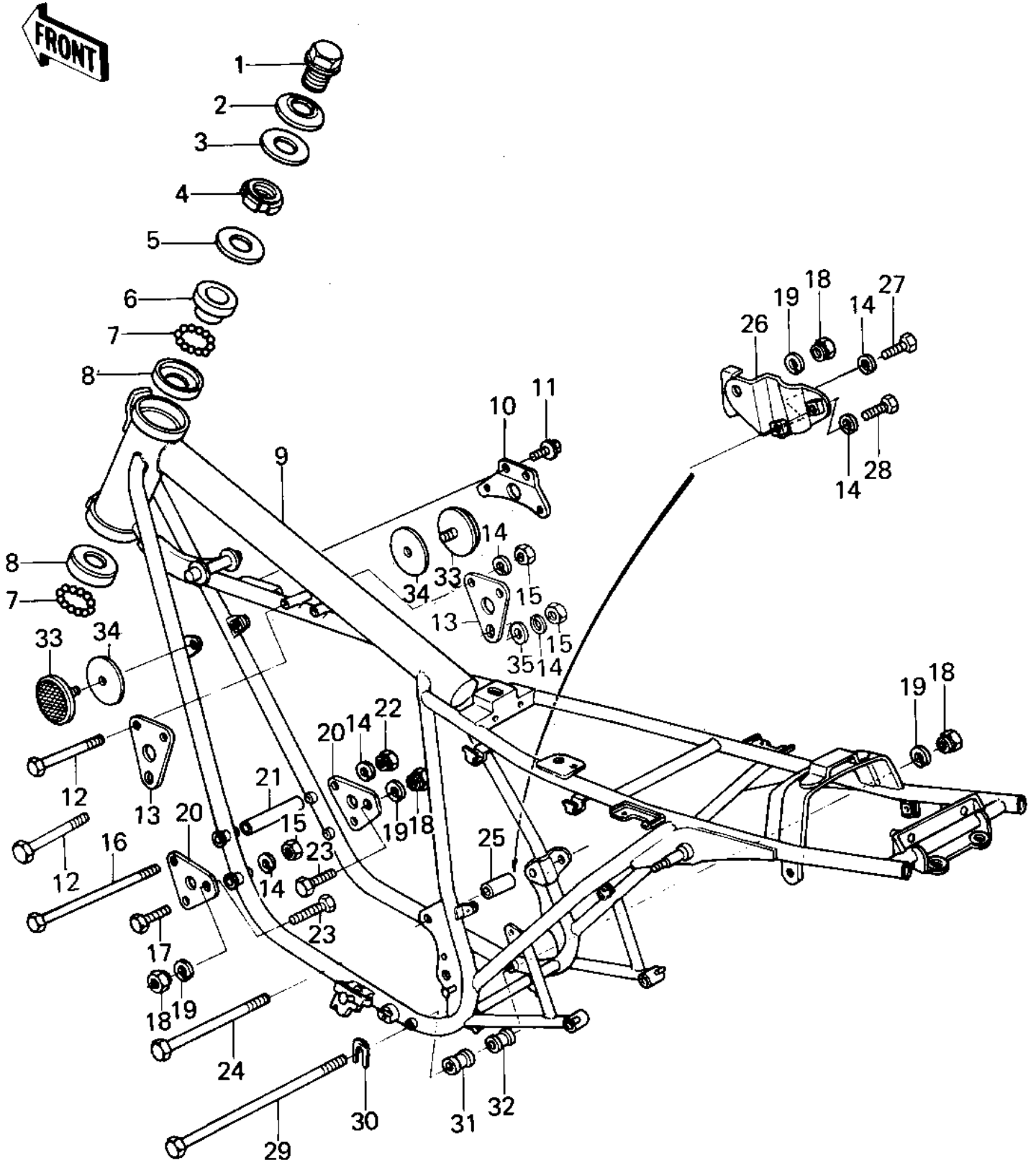

1978 KZ400-B1 PARTS LIST

FRAME/FRAME FITTINGS

| ITEM NAME | PART NUMBER | QUANTITY |
|----------------------------------|-------------|----------|
| BOLT,STEERG STEM HEAD (Ref # 1) | 92007-031 | 1 |
| WASHER,STEERG STM HD (Ref # 2) | 92022-230 | 1 |
| WASHER,WAVE (Ref # 3) | 46100-003 | 1 |
| NUT STEERING STEM LCK (Ref # 4) | 92090-007 | 1 |
| CAP, STEERING STEM (Ref # 5) | 46098-016 | 1 |
| CONE STRNG STEM BERNG (Ref # 6) | 92047-006 | 1 |
| BALL STEEL 1/4' (Ref # 7) | 600A0800 | 38 |
| RACE STRNG STEM BERNG (Ref # 8) | 92048-006 | 2 |
| FRAME-COMP (Ref # 9) | 32002-1260 | 1 |
| BRACKET,IGNITON COIL (Ref # 10) | 32058-049 | 1 |
| BOLT,SPROCKET FITTING (Ref # 11) | 92003-208 | 2 |
| BOLT,FLANGED,8X60 (Ref # 12) | 92001-1581 | 3 |
| BRACKET,ENGINE (Ref # 13) | 32029-1016 | 2 |
| WASHER SPRING 8MM (Ref # 14) | 461F0800 | 8 |
| NUT,8MM (Ref # 15) | 311B0800 | 5 |
| BOLT,HEX HEAD,8X253 (Ref # 16) | 92003-171 | 1 |
| BOLT,HEX HEAD,8X59 (Ref # 17) | 110G0859 | 2 |
| NUT,LOCK,10MM (Ref # 18) | 92019-021 | 4 |
| WASHER SPRING 10MM (Ref # 19) | 461F1000 | 4 |
| PLATE,ENG MOUNT,FRNT (Ref # 20) | 32030-044 | 2 |
| COLLAR,ENG PLAT,FRNT (Ref # 21) | 92027-233 | 1 |
| NUT,LOCK,8MM (Ref # 22) | 92017-013 | 1 |
| BOLT,HEX HEAD,10X50 (Ref # 23) | 92001-1254 | 2 |
| BOLT FLANGED 10X220 (Ref # 24) | 92002-1197 | 1 |
| COLLAR,ENG MOUNT UPPE (Ref # 25) | 92027-228 | 1 |
| PLATE,ENG MOUNT,REAR (Ref # 26) | 32030-034 | 1 |
| BOLT-SMALL-UPSET 8X25 (Ref # 27) | 115G0825 | 1 |
| BOLT,8X20 (Ref # 28) | 115G0820 | 1 |
| BOLT,HEX HEAD,10X292 (Ref # 29) | 92003-162 | 1 |

1978 KZ400-B1 PARTS LIST

FRAME/FRAME FITTINGS

| ITEM NAME | PART NUMBER | QUANTITY |
|----------------------------------|-------------|----------|
| SHIM-ENG FIT FR,0.5MM (Ref # 30) | 92025-053 | AR |
| SHIM-ENG FIT FR,0.8MM (Ref # 30) | 92025-054 | AR |
| SHIM-ENG FIT FR,1.0MM (Ref # 30) | 92025-055 | AR |
| SHIM-ENG FIT FR,1.6MM (Ref # 30) | 92025-056 | AR |
| SHIM-ENG FIT FR,2.0MM (Ref # 30) | 92025-057 | AR |
| SHIM-ENG FIT FR,2.3MM (Ref # 30) | 92025-058 | AR |
| COLLAR,ENG MOUNTING (Ref # 31) | 92027-160 | 1 |
| COLLAR (Ref # 32) | 92027-250 | AR |
| REFLECTOR,REFLEX,REAR (Ref # 33) | 28012-009 | 2 |
| DAMPER RUBBER,REFLECT (Ref # 34) | 92094-011 | 2 |
| WASHER PLAIN 8MM (Ref # 35) | 411B0800 | 1 |