

1978 KZ400-C1 PARTS DIAGRAM

TRANSMISSION

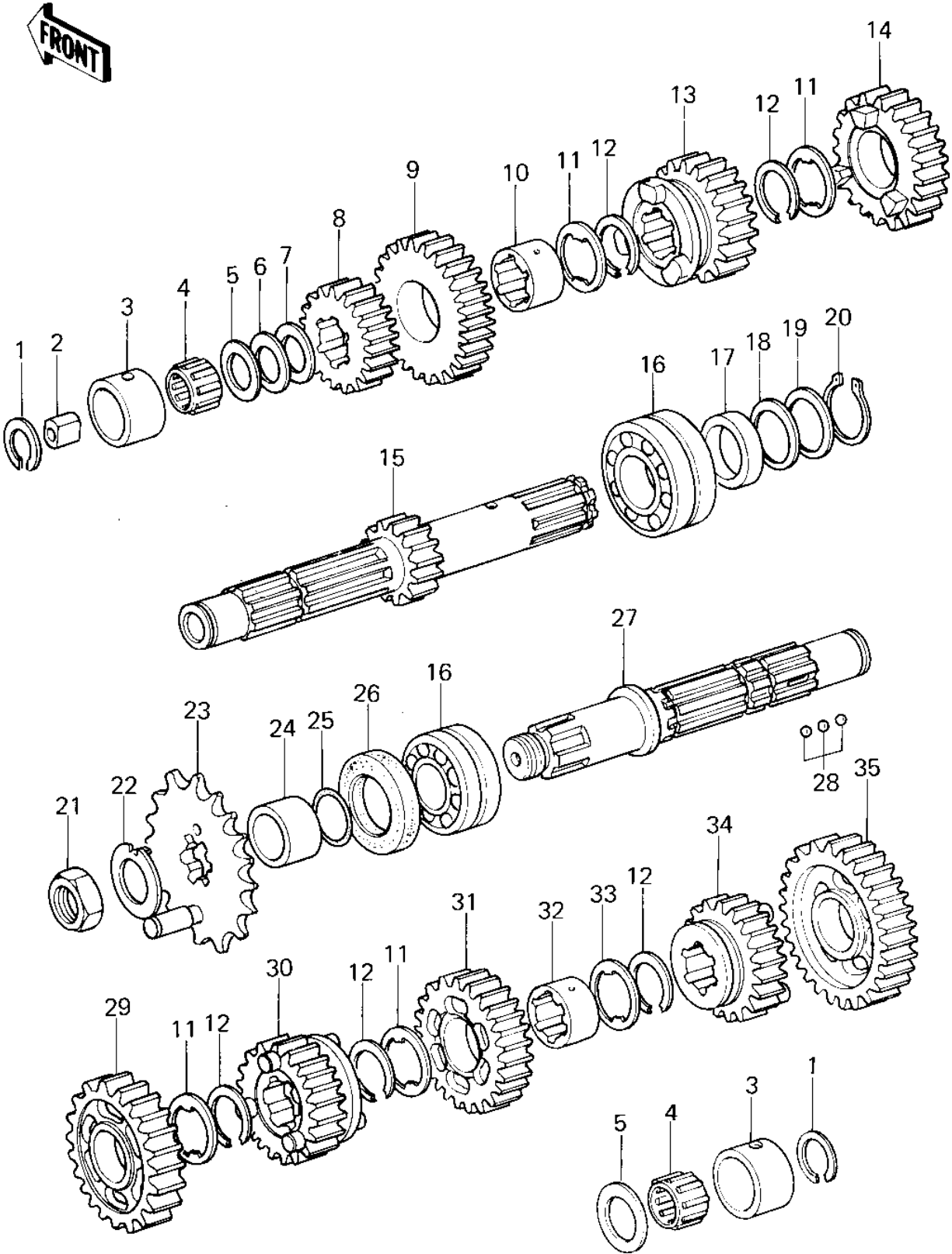

1978 KZ400-C1 PARTS LIST

TRANSMISSION

ITEM NAME	PART NUMBER	QUANTITY
CIRCLIP (Ref # 1)	92033-015	2
BUSHING,DRIVE SHAFT (Ref # 2)	92028-155	1
RACE,OUT & DRV SHAFT (Ref # 3)	92048-1001	2
BRG,N,20R25139 (Ref # 4)	92046-044	2
WASHER THRUST (Ref # 5)	92022-112	2
SHIM-KICK SHAFT (Ref # 6)	92022-144	AR
WASHER THRUST (Ref # 7)	92022-113	1
2ND GEAR,DRIVE SHAFT (Ref # 8)	13130-038	1
TOP GEAR,DRIVE SHAFT (Ref # 9)	13129-1006	1
BUSHING,INPUT TOP GEA (Ref # 10)	92028-1552	1
WASHER-LOCK (Ref # 11)	92024-038	4
CIRCLIP (Ref # 12)	92033-026	5
3RD GEAR,DRIVE SHAFT (Ref # 13)	13129-1002	1
4TH GEAR,DRIVE SHAFT (Ref # 14)	13129-1004	1
SHAFT,DRIVE SHAFT (Ref # 15)	13127-1001	1
BEARING,B,5205ANX4PX (Ref # 16)	92045-031	2
COLLAR (Ref # 17)	92027-289	1
WASHER-THRUST (Ref # 18)	92022-225	1
WASHER,CLUTCH TRUST (Ref # 19)	92022-302	1
CIRCLIP 24MM (Ref # 20)	480J2400	1
NUT 20MM (Ref # 21)	92016-028	1
WASHER,LOCK,20MM (Ref # 22)	92024-044	1
ENGINE SPROCKET (Ref # 23)	13144-1003	1
COLLAR,ENG SPROCKET (Ref # 24)	92027-288	1
"O" RING (Ref # 25)	92055-035	1
OIL SEAL SC325210 (Ref # 26)	92050-024	1
SHAFT,OUTPUT (Ref # 27)	13128-1002	1
BALL STEEL 5/32' (Ref # 28)	600A0500	3
2ND GEAR,OUTPUT SHAFT (Ref # 29)	13131-045	1

1978 KZ400-C1 PARTS LIST

TRANSMISSION

ITEM NAME	PART NUMBER	QUANTITY
TOP GEAR,OUTPUT SHAFT (Ref # 30)	13129-1007	1
3RD GEAR,OUTPUT SHAFT (Ref # 31)	13129-1003	1
BUSHING,OUTPUT 3RD GR (Ref # 32)	92028-1002	1
WASHER-LOCK (Ref # 33)	92024-033	1
4TH GEAR,OUTPUT SHAFT (Ref # 34)	13129-1005	1
LOW GEAR,OUTPUT SHAFT (Ref # 35)	13129-1001	1