

1976 KZ400-D3 PARTS DIAGRAM

CRANKCASE ('76 -'77 KZ400 - D3/D4)

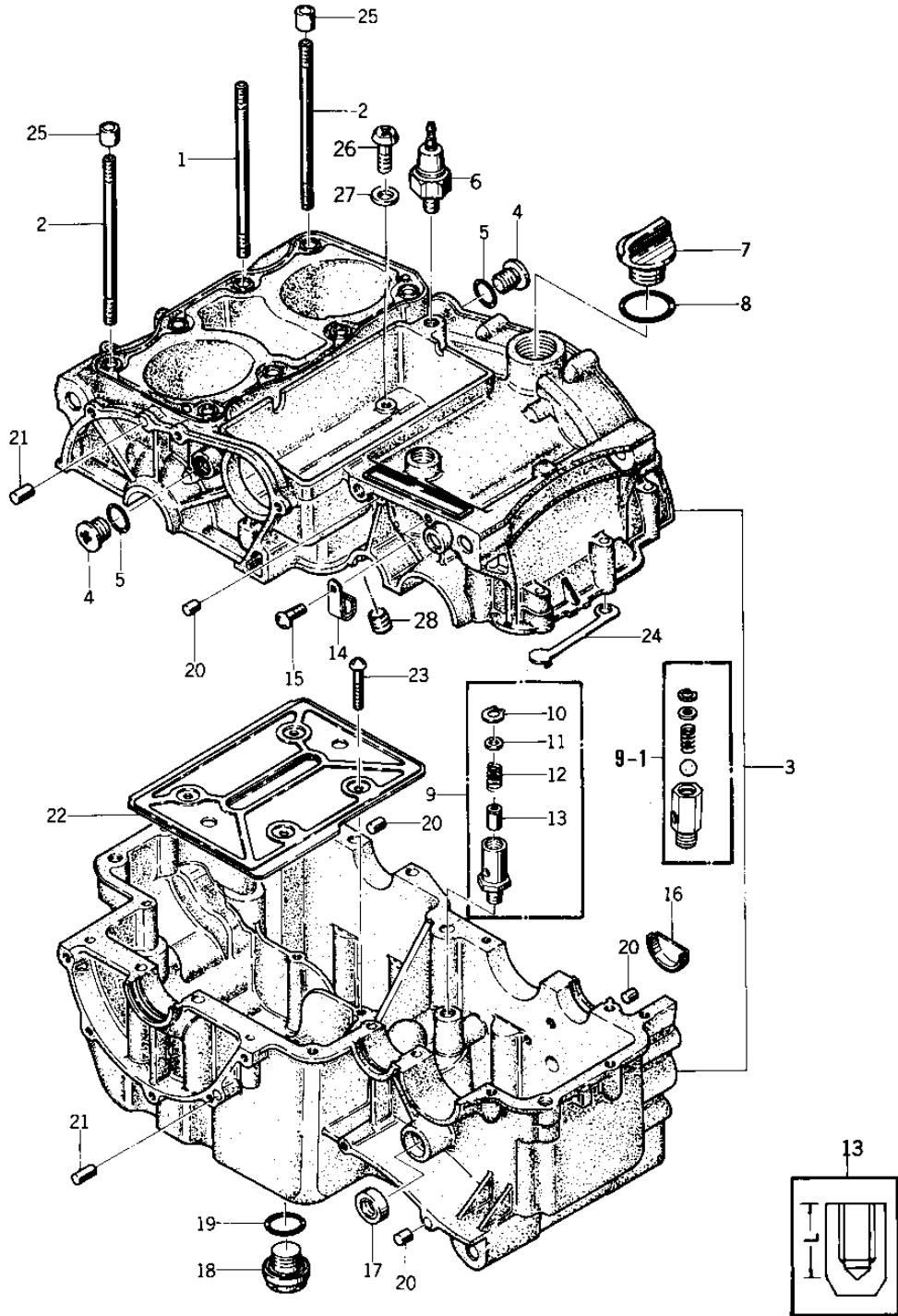

1976 KZ400-D3 PARTS LIST

CRANKCASE ('76 -'77 KZ400 - D3/D4)

| ITEM NAME | PART NUMBER | QUANTITY |
|----------------------------------|-------------|----------|
| .STUD,8X201 (Ref # 1) | 92004-052 | 6 |
| .STUD,8X210 (Ref # 2) | 92004-053 | 2 |
| CRANKCASE SET (Ref # 3) | 14001-102 | 1 |
| CRANKCASE SET (Ref # 3) | 14001-102 | 1 |
| .PLUG (Ref # 4) | 92066-067 | 2 |
| PLUG (Ref # 4) | 92066-067 | 2 |
| ."O" RING,13.5MM (Ref # 5) | 92055-073 | 2 |
| SWITCH,OIL PRESSURE (Ref # 6) | 27010-1157 | 1 |
| PLUG,OIL FILLER (Ref # 7) | 16115-013 | 1 |
| "O" RING,31MM (Ref # 8) | 92055-049 | 1 |
| RELEAF VALVE ASSY (Ref # 9) | 16130-1001 | 1 |
| RELEAF VALVE ASSY (Ref # 9-1) | 16130-1001 | 1 |
| CIRCLIP, 12MM (Ref # 10) | 481J1200 | 1 |
| SPACER,RELEAF VALVE (Ref # 11) | 92026-097 | 1 |
| SPRING,RELEAF VALVE (Ref # 12) | 16133-003 | 1 |
| PISTON,RELEAF VALVE (Ref # 13) | 16126-002 | 1 |
| CLAMP,WIRING HARNESS (Ref # 14) | 21126-008 | 1 |
| CLAMP,WIRING HARNESS (Ref # 14) | 21126-008 | 1 |
| SCREW PAN HEAD 6X12 (Ref # 15) | 220B0612 | 1 |
| RECEIVER,OIL (Ref # 16) | 14015-005 | 1 |
| OIL SEAL,TB13225.5 (Ref # 17) | 92051-005 | 1 |
| .PLUG,OIL DRAIN,12X15 (Ref # 18) | 92066-1174 | 1 |
| .GASKET,DRIN PLUG (Ref # 19) | 92065-097 | 1 |
| .PIN-DOWEL (Ref # 20) | 92042-007 | 12 |
| .PIN,DOWEL,6X12 (Ref # 21) | 551A0612 | 2 |
| PLATE (Ref # 22) | 14082-001 | 1 |
| .SCREW PAN HEAD 6X12 (Ref # 23) | 220B0612 | 4 |
| CLAMP,OVERFLOW HOSE (Ref # 24) | 92037-149 | 1 |
| .PIN,DOWEL,10X8.2X14 (Ref # 25) | 92043-1037 | 2 |