

1975 Special PARTS DIAGRAM

CYLINDER/PISTONS/CRANKSHAFT (75 S)

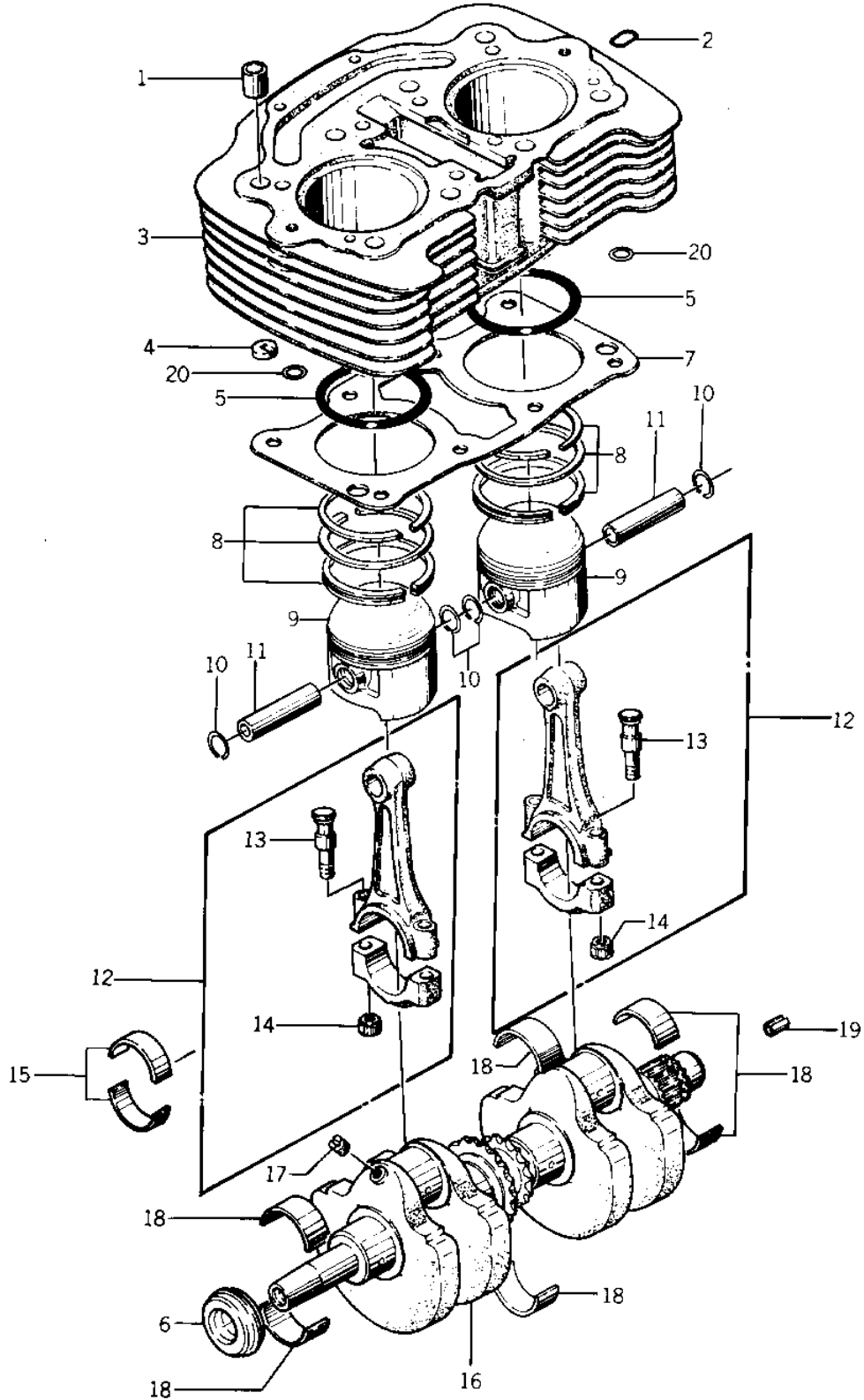

1975 Special PARTS LIST

CYLINDER/PISTONS/CRANKSHAFT ('75 S)

ITEM NAME	PART NUMBER	QUANTITY
PIN,DOWEL,14MM (Ref # 1)	92042-032	2
"O" RING,CYLINDER (Ref # 2)	11009-1012	2
CYLINDER, (Ref # 3)	11005-146	1
CYLINDER, (Ref # 3)	11005-146	1
DAMPER RUBBER,CYLNDR (Ref # 4)	92075-256	12
"O" RING (Ref # 5)	92055-056	2
OIL SEAL,L.H CRNKSFT (Ref # 6)	92050-064	1
GASKET,CYLINDER BASE (Ref # 7)	11009-040	1
RING SET,PISTON,STD (Ref # 8)	13008-5028	2
RING SET,PISTON,STD (Ref # 8)	13008-5028	2
RING SET,0.020",O/S (Ref # 8)	13025-5013	(2
RING SET,0.020",O/S (Ref # 8)	13025-5013	(2
RING SET,0.040",O/S (Ref # 8)	13024-5012	(2
RING SET,0.040",O/S (Ref # 8)	13024-5012	(2
PISTON,STD (Ref # 9)	13001-069	2
PISTON,0.020" O.S (Ref # 9)	13029-070	2
PISTON,0.040" O.S (Ref # 9)	13027-063	(2
CIRCLIP PISTON PIN (Ref # 10)	92036-005	4
PIN-PISTON (Ref # 11)	13002-029	2
CONNECTING ROD ASSY,H (Ref # 12)	13032-046-HH	2
CONNECTING ROD ASSY,H (Ref # 12)	13032-046-HH	2
CONNECTING ROD ASSY,H (Ref # 12)	13032-046-HH	2
CONNECTING ROD ASSY,H (Ref # 12)	13032-046-HH	2
CONNECTING ROD ASSY,I (Ref # 12)	13032-046-II	2
CONNECTING ROD ASSY,J (Ref # 12)	13032-046-JJ	2
UNAVAILABLE IN PRICE BOOK (Ref # 12)	13032-046-KK	2
BOLT (Ref # 13)	92001-169	4
BOLT (Ref # 13)	92001-169	AL
NUT,CONNECTING ROD (Ref # 14)	92016-053	4

1975 Special PARTS LIST

CYLINDER/PISTONS/CRANKSHAFT ('75 S)

ITEM NAME	PART NUMBER	QUANTITY
NUT,FLANGED,8MM (Ref # 14)	92015-1311	AL
METAL,CONROD BEARING (Ref # 15)	13034-037	4
METAL,CON ROD (Ref # 15)	13034-047	4
METAL,CON ROD (Ref # 15)	13034-048	4
CRANKSHAFT ASSY (Ref # 16)	13037-061	1
SCREW,SLOTTED,6X8 (Ref # 17)	291H0608	2
BUSHING,CRANKSHAFT (Ref # 18)	92028-1102	8
BUSHING,CRANKSHAFT (Ref # 18)	92028-1102	8
BUSHING,CRANKSHAFT (Ref # 18)	92028-1102	8
BUSHING,CRANKSHAFT (Ref # 18)	92028-1102	8
PIN-SPRING,4X8 (Ref # 19)	555A0408	1
"O" RING (Ref # 20)	92055-074	2
"O" RING (Ref # 20)	92055-090	2