

# 1976 Special PARTS DIAGRAM

FRONT FORK ('76-'77 S2/S3)

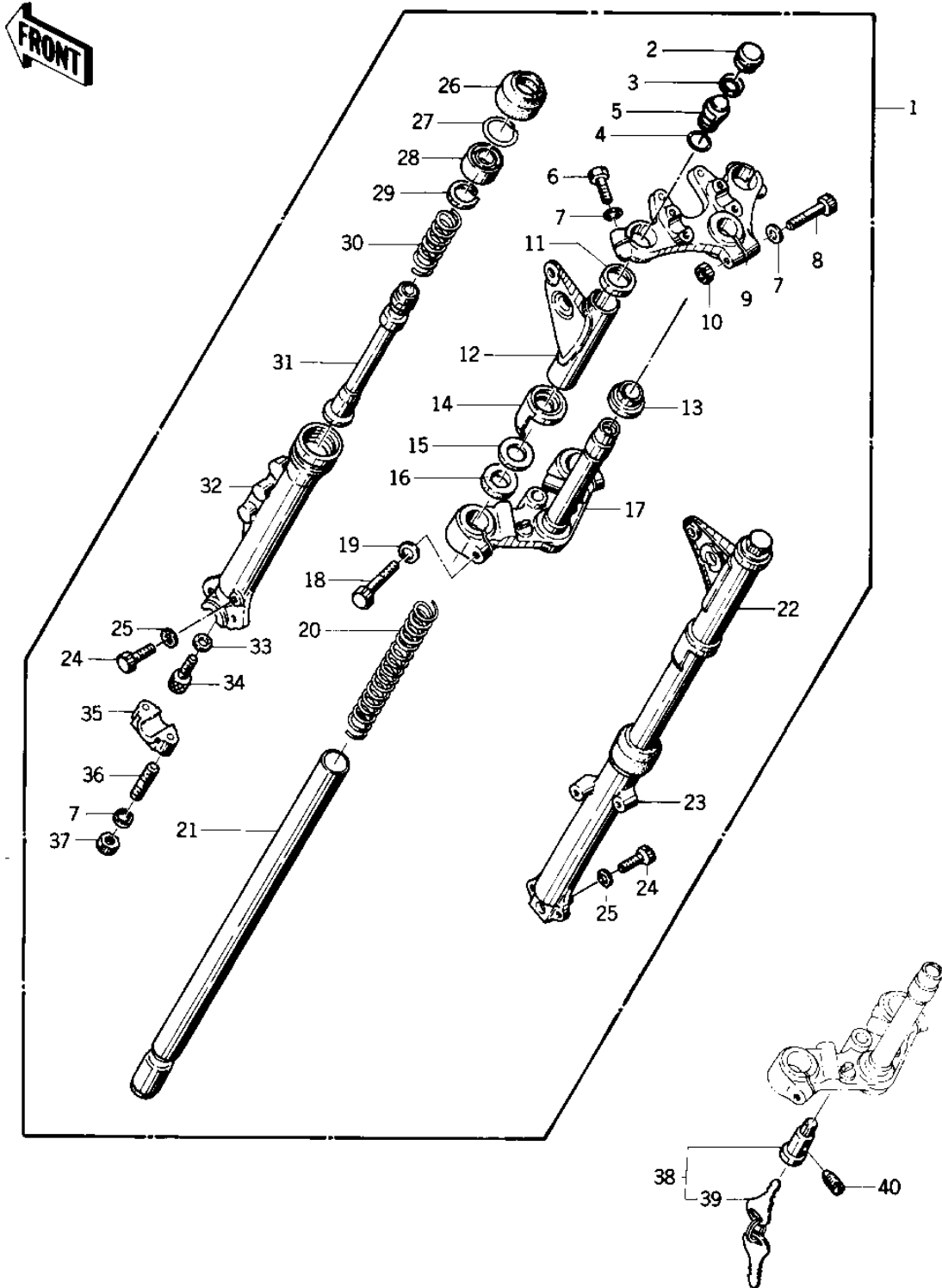

# 1976 Special PARTS LIST

## FRONT FORK ('76-'77 S2/S3)

ITEM NAME	PART NUMBER	QUANTITY
FORK-FRONT (Ref # 1)	44001-193	1
CAP (Ref # 2)	44062-007	2
CIRCLIP (Ref # 3)	44044-023	2
"O" RING (Ref # 4)	44046-025	2
GUIDE,SPRING (Ref # 5)	44029-022	2
BOLT-HEX HEAD.8M/M (Ref # 6)	44041-045	2
WASHER SPRING 8MM (Ref # 7)	461F0800	5
BOLT-HEX HEAD,8X55 (Ref # 8)	44041-038	1
HEAD, STEERING STEM (Ref # 9)	44039-064	1
NUT,LOCK,8MM (Ref # 10)	92015-1124	1
CAP,FORK COVER (Ref # 11)	44064-026	2
COVER,L.H FORK (Ref # 12)	44033-080	1
CONE STRNG STEM BERNG (Ref # 13)	92047-006	1
GUIDE,FORK COVER (Ref # 14)	44064-027	2
WASHER,FORK COVER (Ref # 15)	92022-297	2
DAMPER RUBBER,FK COV (Ref # 16)	92075-240	2
STEM, STEERING (Ref # 17)	44037-077	1
BOLT, HEX HEAD,10X30 (Ref # 18)	44041-079	2
WASHER SPRING 10MM (Ref # 19)	461F1000	2
SPRING, FORK (Ref # 20)	44026-061	2
TUBE,FORK INNER (Ref # 21)	44013-055	2
COVER,R.H FORK (Ref # 22)	44034-080	1
TUBE,RH,FORK OUTER (Ref # 23)	44006-056	1
BOLT HEX HEAD 6X8 (Ref # 24)	110B0608	2
GASKET,DRAIN PLUG (Ref # 25)	44045-047	2
DUST SHIELD,FORK (Ref # 26)	92093-1063	2
RING,OIL SEAL STOPER (Ref # 27)	44043-057	2
OIL SEAL,FORK (Ref # 28)	92049-1077	2
RING, PISTON (Ref # 29)	44025-003	2

# 1976 Special PARTS LIST

## FRONT FORK ('76-'77 S2/S3)

ITEM NAME	PART NUMBER	QUANTITY
SPRING,FORK CYLINDER (Ref # 30)	44026-054	2
CYLINDER-FORK (Ref # 31)	44022-035	2
TUBE,LH,FORK OUTER (Ref # 32)	44005-058-1W	1
GASKET,FORK CYL BOLT (Ref # 33)	44045-051	2
BOLT,FORK CYLINDER (Ref # 34)	44041-078	2
HOLDER,FORK COVER (Ref # 35)	44063-010-1W	1
STUD 8X50 (Ref # 36)	172G0850	2
NUT,CAP AND LOCK,8MM (Ref # 37)	92019-013	2
LOCK ASSY,STEERING (Ref # 38)	27016-043	1
SCREW,SEAT LOCK (Ref # 40)	92014-016	1
SCREW,SEAT LOCK (Ref # 40)	92014-016	1